

**CALENDAR ITEM  
C56**

A 72  
S 34

02/07/17  
PRC 3173.1  
J. Toy

**REVISION OF RENT**

**LESSEE:**

Robert P. Maniaci and Mary M. Maniaci, as Trustees of The Robert P. and Mary M. Maniaci Family Trust, dated July 14, 1993

**AREA, LAND TYPE, AND LOCATION:**

Sovereign land in Huntington Harbour, adjacent to 16642 Somerset Lane, near Huntington Beach, Orange County.

**AUTHORIZED USE:**

Continued use and maintenance of an existing boat dock, access ramp, and cantilevered deck.

**LEASE TERM:**

10 years, beginning January 26, 2012.

**CONSIDERATION:**

This lease provides that lessor may modify the rent periodically during the lease term. Pursuant to this provision, staff reviewed the rent under this lease and recommends that rent be revised from \$2,454 per year to \$3,214 per year, effective January 26, 2017.

**OTHER PERTINENT INFORMATION:**

1. Lessee owns the upland adjoining the lease premises.
2. On January 26, 2012, the Commission authorized a General Lease – Recreational Use to Robert P. Maniaci and Mary M. Maniaci, as Trustees of The Robert P. and Mary M. Maniaci Family Trust, dated July 14, 1993 for a term of 10 years beginning January 26, 2012 ([Calendar Item C62, January 26, 2012](#)). The lease will expire on January 25, 2022.

CALENDAR ITEM NO. **C56** (CONT'D)

3. This action is consistent with Strategy 2.2 of the Commission's Strategic Plan to ensure timely receipt of revenues and royalties from the use and development of State lands and minerals.
4. Approving the revision of rent is not a project as defined by the California Environmental Quality Act because it is an administrative action that will not result in direct or indirect physical changes in the environment.

Authority: Public Resources Code section 21065 and California Code of Regulations, title 14, section 15378, subdivision (b)(5).

**EXHIBIT:**

- A. Site and Location Map

**RECOMMENDED ACTION:**

It is recommended that the Commission:

**AUTHORIZATION:**

Approve the revision of rent for Lease No. PRC 3173.1 from \$2,454 per year to \$3,214 per year, effective January 26, 2017.

NO SCALE

# SITE

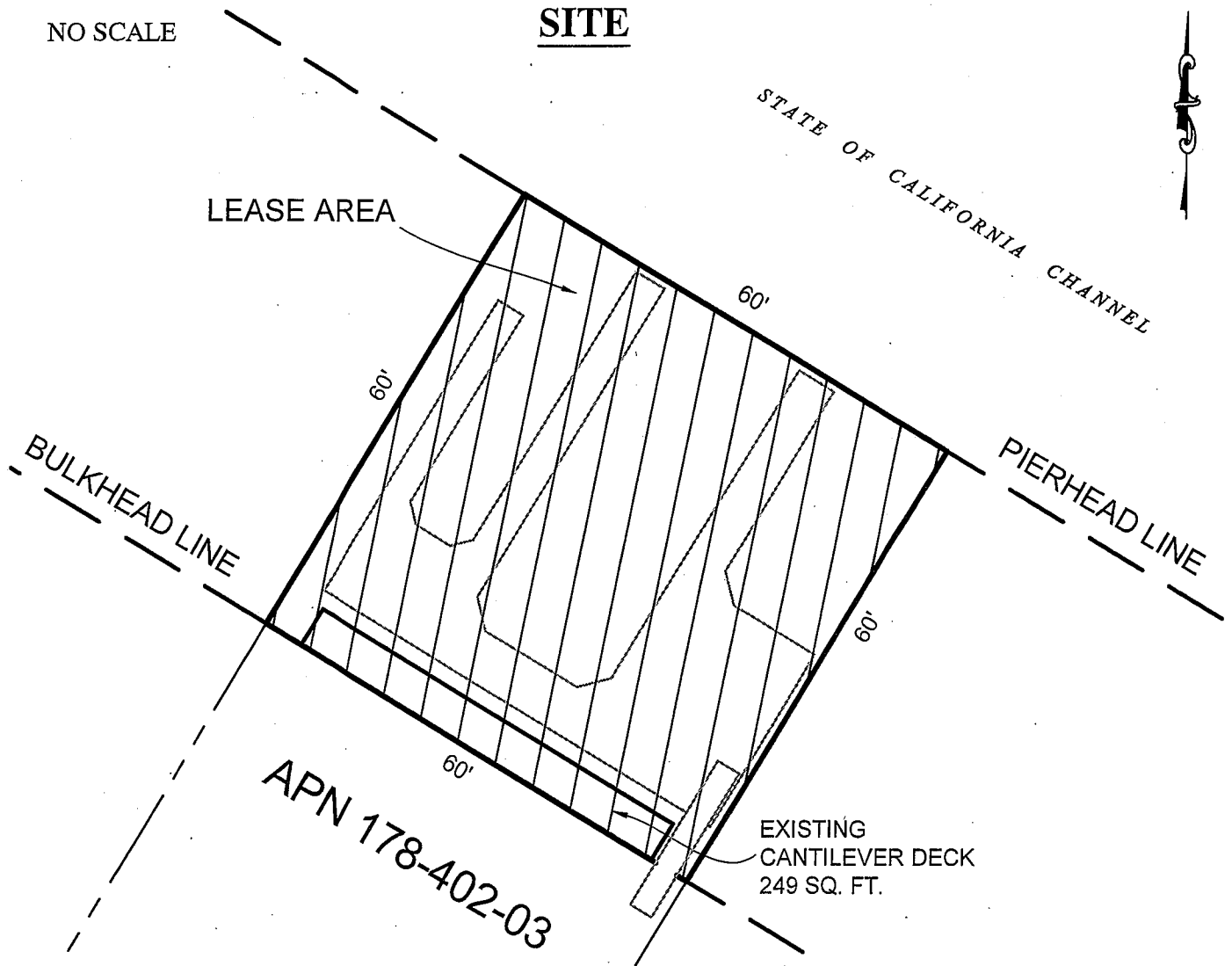

16642 SOMERSET LANE, HUNTINGTON BEACH

NO SCALE

# LOCATION

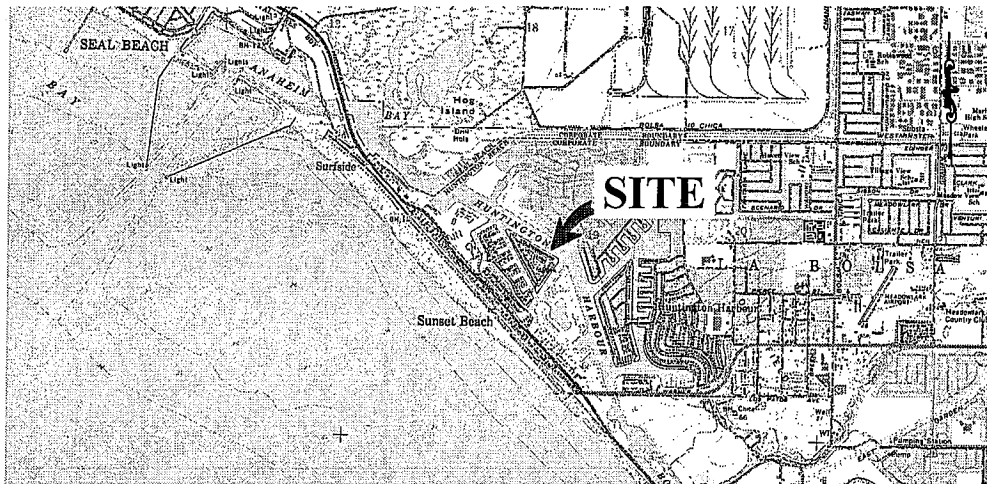

MAP SOURCE: USGS QUAD

# Exhibit A

PRC 3173.1  
 MANIACI FAMILY TRUST  
 APN 178-402-03  
 GENERAL LEASE -  
 RECREATIONAL USE  
 ORANGE COUNTY



This Exhibit is solely for purposes of generally defining the lease premises, is based on unverified information provided by the Lessee or other parties and is not intended to be, nor shall it be construed as, a waiver or limitation of any State interest in the subject or any other property.

MIJ 01/04/12