

**CALENDAR ITEM  
C23**

A 1  
S 1

02/07/17  
PRC 8991.1  
J. Toy

**REVISION OF RENT**

**LESSEE:**

Ronald T. Vanderbeek and Billie J. Vanderbeek

**AREA, LAND TYPE, AND LOCATION:**

Sovereign land in Lake Tahoe, adjacent to 1640 Sequoia Avenue, near Tahoe City, Placer County.

**AUTHORIZED USE:**

Continued use and maintenance of two existing mooring buoys.

**LEASE TERM:**

10 years, beginning May 24, 2012.

**CONSIDERATION:**

This lease provides that lessor may modify the rent periodically during the lease term. Pursuant to this provision, staff reviewed the rent under this lease and recommends that rent be revised from \$680 per year to \$754 per year, effective May 24, 2017.

**OTHER PERTINENT INFORMATION:**

1. Lessee owns the upland adjoining the lease premises.
2. On May 24, 2012, the Commission authorized a General Lease – Recreational Use to Ronald T. Vanderbeek and Billie J. Vanderbeek for a term of 10 years beginning May 24, 2012 ([Calendar Item C14, May 24, 2012](#)). The lease will expire on May 23, 2022.
3. This action is consistent with Strategy 2.2 of the Commission’s Strategic Plan to ensure timely receipt of revenues and royalties from the use and development of State lands and minerals.

CALENDAR ITEM NO. **C23** (CONT'D)

4. Approving the revision of rent is not a project as defined by the California Environmental Quality Act because it is an administrative action that will not result in direct or indirect physical changes in the environment.

Authority: Public Resources Code section 21065 and California Code of Regulations, title 14, section 15378, subdivision (b)(5).

**EXHIBIT:**

- A. Site and Location Map

**RECOMMENDED ACTION:**

It is recommended that the Commission:

**AUTHORIZATION:**

Approve the revision of rent for Lease No. PRC 8991.1 from \$680 per year to \$754 per year, effective May 24, 2017.

NO SCALE

# SITE

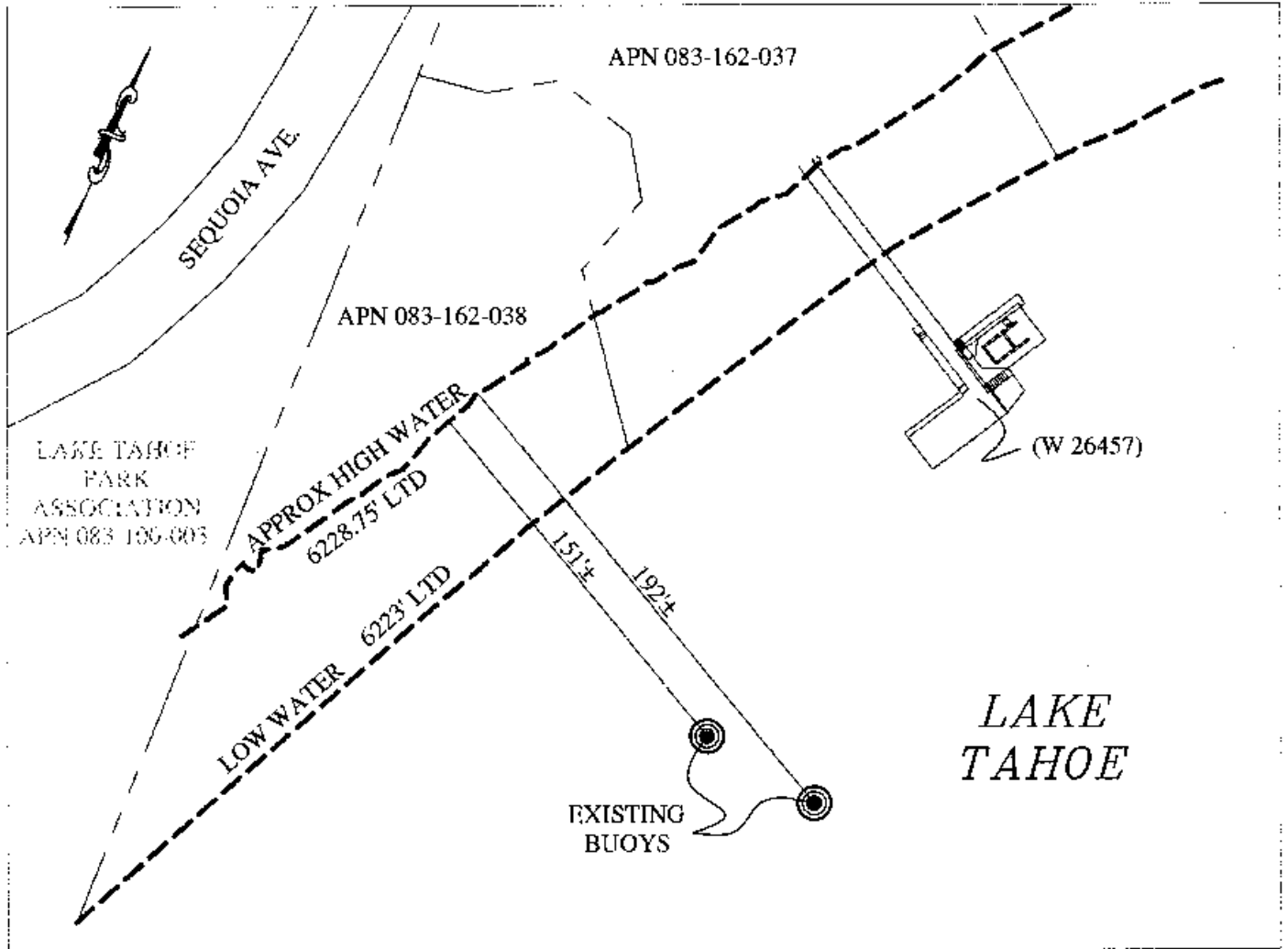

1640 Sequoia Ave, near Tahoe City

NO SCALE

# LOCATION

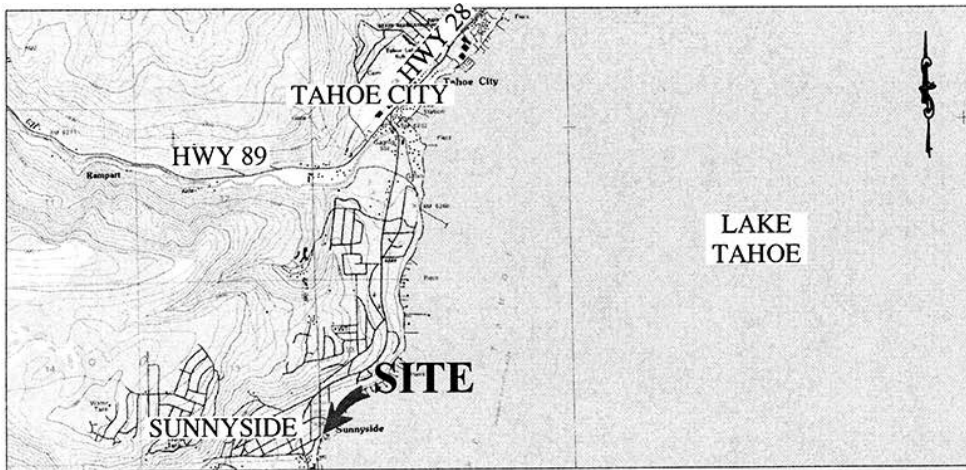

MAP SOURCE: USGS QUAD

## Exhibit A

PRC 8991.1  
 VANDERBEEK  
 APN 083-162-038  
 GENERAL LEASE -  
 RECREATIONAL USE  
 PLACER COUNTY

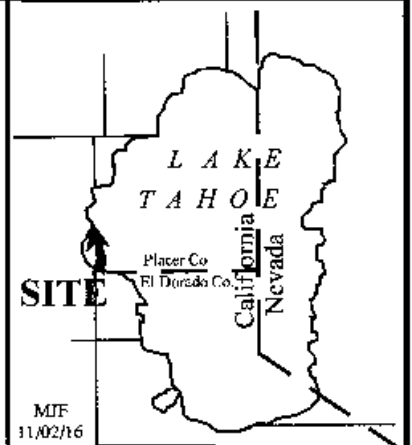

This Exhibit is solely for purposes of generally defining the lease premises, is based on unverified information provided by the Lessee or other parties and is not intended to be, nor shall it be construed as, a waiver or limitation of any State interest in the subject or any other property.