

**CALENDAR ITEM
C08**

A 1
S 1

02/07/17
PRC 7555.1
K. Connor

GENERAL LEASE – RECREATIONAL USE

APPLICANT:

Richard M. Klein and Frieda V. Klein, Trustees of the Klein Family Trust Dated December 15, 1969

PROPOSED LEASE:

AREA, LAND TYPE, AND LOCATION:

Sovereign land in Lake Tahoe, adjacent to 140 Sierra Terrace Road, near Tahoe City, Placer County

AUTHORIZED USE:

Continued use and maintenance of two mooring buoys.

LEASE TERM:

10 years beginning August 12, 2016.

CONSIDERATION:

\$754 per year, with an annual Consumer Price Index adjustment.

SPECIFIC LEASE PROVISIONS:

1. Liability insurance in an amount no less than \$1,000,000 per occurrence.
2. Lessee shall not store any personal items or construct any improvements within the Public Trust easement which may impair the public uses.
3. If Lessee does not have valid Tahoe Regional Planning Agency (TRPA) buoy permits, Lessee is required to obtain such authorization for the mooring buoys within two years after the adoption of a Final Environmental Impact Statement (FEIS) for the Lake Tahoe Shorezone Ordinance Amendments and approval of the amended ordinances. If Lessee is unable to obtain such

CALENDAR ITEM NO. **C08** (CONT'D)

authorization within the time limit, they may be required to remove the buoys.

4. Lessee expressly acknowledges and agrees that issuance of a lease does not substitute for, or provide preference in, obtaining authorizations from TRPA or any other regulatory agency for the improvements authorized by the Commission.

STAFF ANALYSIS AND RECOMMENDATION:

Authority:

Public Resources Code sections 6005, 6216, 6301, and 6503.5; California Code of Regulations, title 2, section 2000, subdivision (b).

Public Trust and State's Best Interests Analysis:

On August 24, 2006, the Commission authorized a 10-year Recreational Pier Lease to Richard M. Klein and Frieda V. Klein, Trustees of the Klein Family Trust Dated December 15, 1969 ([Calendar Item C11, August 24, 2006](#)). That lease expired on August 11, 2016. The Applicant is now applying for a General Lease – Recreational Use for the continued use and maintenance of two existing mooring buoys. The two buoys are privately owned and maintained. There is also a pier extending from the upland to the approximate shoreline, as shown on Exhibit B; however, the pier does not appear to extend below the low water line, based on the information available at this time, and therefore is not within the Commission's leasing jurisdiction. Consequently, a lease for the pier is not required at this time.

The two buoys are for the mooring of boats. Recreational boating is a water-dependent use that is generally consistent with the common law Public Trust Doctrine. The California Legislature has identified private recreational boating facilities as an authorized use of Public Trust lands (Pub. Resources Code, § 6503.5).

The subject facilities do not significantly alter the land and the lease does not alienate the State's fee simple interest or permanently impair public rights. The two buoys have existed for many years at this location. Upon termination of the lease, the lessee may be required to remove all improvements and restore the lease premises to their original condition. Additionally, the two buoys occupy a relatively small area of the lake. Based on the foregoing, Commission staff believes that the two mooring

CALENDAR ITEM NO. **C08** (CONT'D)

buoys will not substantially interfere with Public Trust needs at this location, at this time, or for the foreseeable term of the proposed lease.

The proposed lease requires the lessee to insure the lease premises and indemnify the State for any liability incurred as a result of the lessee's activities thereon. The lease also requires the payment of annual rent to compensate the people of the State for the occupation of the public land involved. For all the reasons above, Commission staff believes the issuance of this lease is consistent with the common law Public Trust Doctrine and in the best interests of the State.

OTHER PERTINENT INFORMATION:

1. This action is consistent with Strategy 1.1 of the Commission's Strategic Plan to deliver the highest levels of public health and safety in the protection, preservation, and responsible economic use of the lands and resources under the Commission's jurisdiction and Strategy 1.3 to protect, expand, and enhance appropriate public use and access to and along the State's inland and coastal waterways.
2. Staff recommends that the Commission find that this activity is exempt from the requirements of the California Environmental Quality Act (CEQA) as a categorically exempt project. The project is exempt under Class 1, Existing Facilities; California Code of Regulations, Title 2, section 2905, subdivision (a)(2).

Authority: Public Resources Code section 21084 and California Code of Regulations, title 14, section 15300 and California Code of Regulations, title 2, section 2905.

3. This activity involves lands identified as possessing significant environmental values pursuant to Public Resources Code section 6370 et seq., but such activity will not affect those significant lands. Based upon staff's consultation with the persons nominating such lands and through the CEQA review process, it is staff's opinion that the project, as proposed, is consistent with its use classification.

EXHIBITS:

- A. Land Description
- B. Site and Location Map

CALENDAR ITEM NO. **C08** (CONT'D)

RECOMMENDED ACTION:

It is recommended that the Commission:

CEQA FINDING:

Find that the activity is exempt from the requirements of CEQA pursuant to California Code of Regulations, title 14, section 15061 as a categorically exempt project, Class 1, Existing Facilities; California Code of Regulations, title 2, section 2905, subdivision (a)(2).

PUBLIC TRUST AND STATE'S BEST INTERESTS:

Find that the proposed lease will not substantially impair the public rights to navigation and fishing or substantially interfere with the Public Trust needs and values at this location, is consistent with the common law Public Trust Doctrine, and is in the best interests of the State.

SIGNIFICANT LANDS INVENTORY FINDING:

Find that this activity is consistent with the use classification designated by the Commission for the land pursuant to Public Resources Code section 6370 et seq.

AUTHORIZATION:

Authorize issuance of a General Lease – Recreational Use to Richard M. Klein and Frieda V. Klein, Trustees of the Klein Family Trust Dated December 15, 1969, beginning August 12, 2016, for a term of 10 years, for the continued use and maintenance of two existing mooring buoys as described in Exhibit A and shown on Exhibit B (for reference purposes only) attached and by this reference made a part hereof; annual rent in the amount of \$754, with an annual Consumer Price Index adjustment; and liability insurance in an amount no less than \$1,000,000 per occurrence.

EXHIBIT A

PRC 7555.1

LAND DESCRIPTION

Two (2) parcels of submerged land situate in the bed of Lake Tahoe, lying adjacent to Lot 5 of fractional Section 5, Township 15 North, Range 17 East, MDM., as shown on Official Government Township Plat approved November 9, 1866, County of Placer, State of California, and more particularly described as follows:

PARCELS 1 & 2 (BUOYS)

Two (2) circular parcels of land, each being 50 feet in diameter, underlying two (2) existing buoys lying adjacent to that parcel described in Exhibit A of Grant Deed recorded June 29, 2007 as Document Number 2007-0065226-00 in Official Records of said County.

Accompanying plat is hereby made part of this description.

END OF DESCRIPTION

Prepared 10/12/2016 by the California State Lands Commission Boundary Unit.



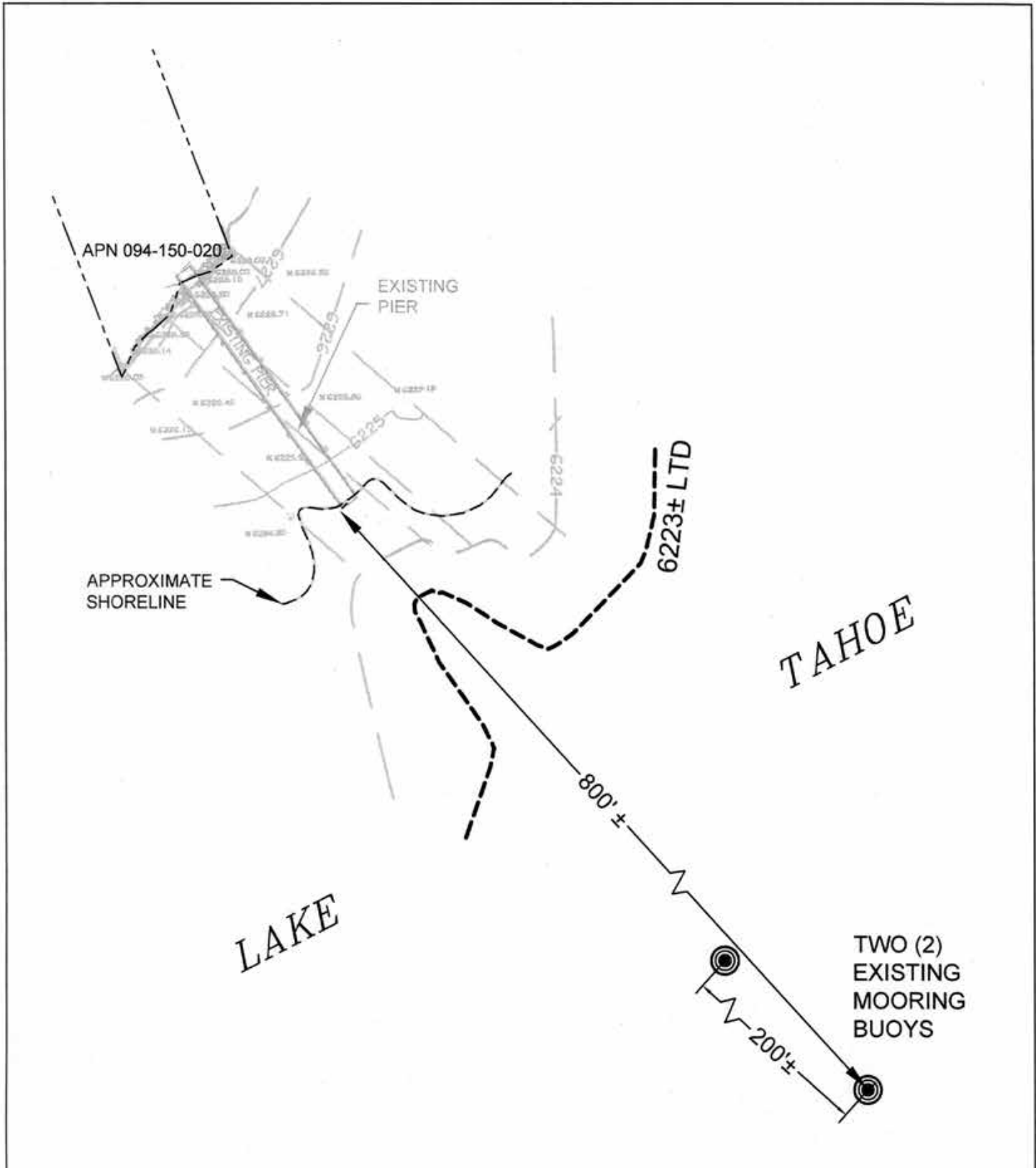

EXHIBIT A

Page 2 of 2

RPF 10/12/16

LAND DESCRIPTION PLAT
 PRC 7555.1, KLEIN FAMILY TRUST
 PLACER COUNTY

CALIFORNIA STATE
 LANDS COMMISSION



NO SCALE

SITE

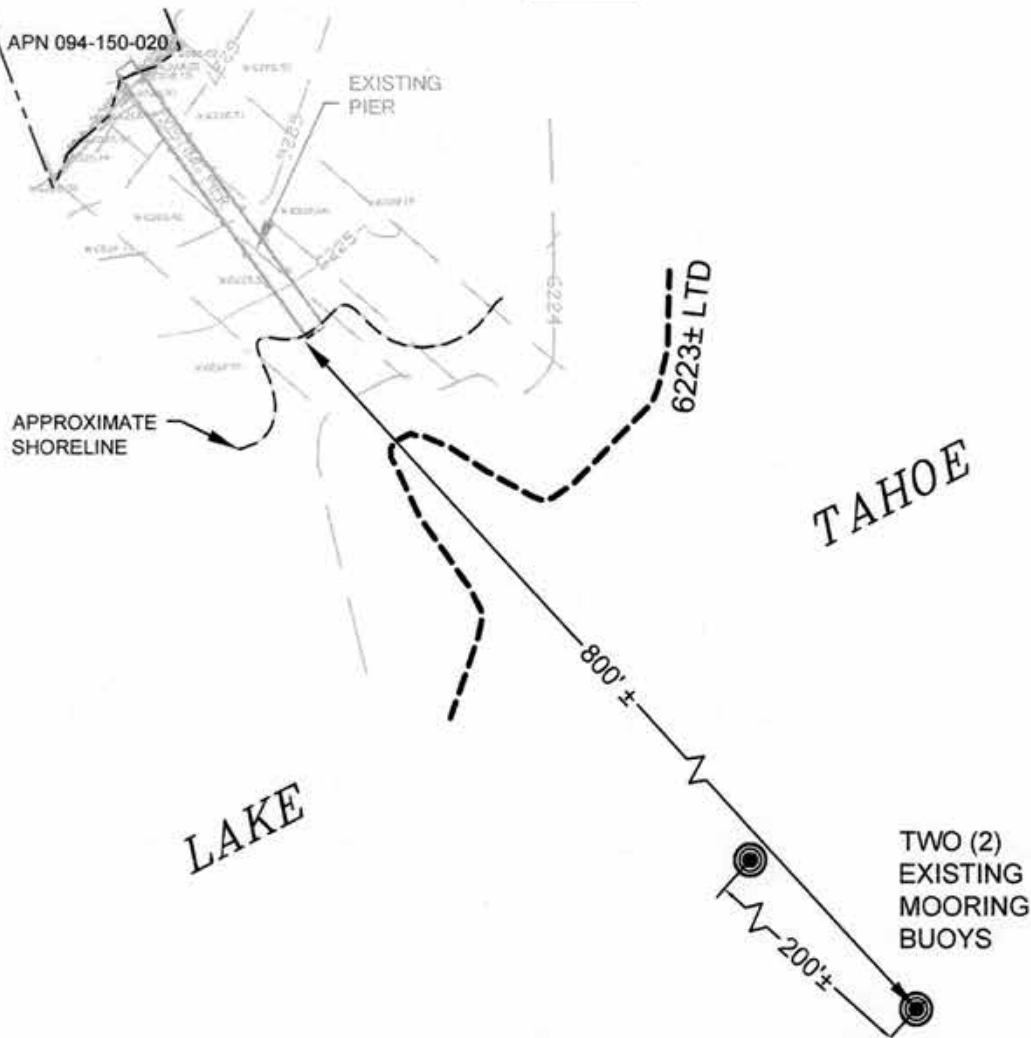

140 SIERRA TERRACE RD, TAHOE CITY

NO SCALE

LOCATION

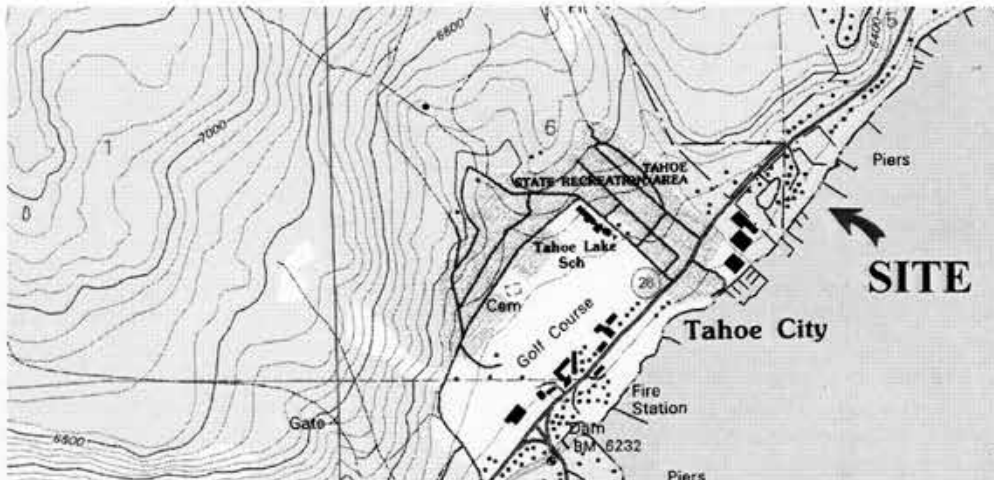

MAP SOURCE: USGS QUAD

Exhibit B

PRC 7555.1
 KLEIN FAMILY TRUST
 APN 094-150-020
 GENERAL LEASE -
 RECREATIONAL USE
 PLACER COUNTY

SITE



This Exhibit is solely for purposes of generally defining the lease premises, is based on unverified information provided by the Lessee or other parties and is not intended to be, nor shall it be construed as, a waiver or limitation of any State interest in the subject or any other property.