

**CALENDAR ITEM  
C08**

A 1  
S 1

10/16/15  
PRC 8680.1  
S. Kreutzburg

**GENERAL LEASE – RECREATIONAL USE**

**APPLICANT:**

Bruce T. Eisenhard and Nancy Eisenhard, Trustees, or their successors in trust, under the Eisenhard Living Trust, dated September 11, 2007 and any amendments thereto.

**AREA, LAND TYPE, AND LOCATION:**

Sovereign land located in Lake Tahoe, adjacent to 6790 North Lake Boulevard, near Tahoe Vista, Placer County.

**AUTHORIZED USE:**

Continued use and maintenance of two existing mooring buoys.

**LEASE TERM:**

10 years, beginning June 1, 2016.

**CONSIDERATION:**

\$754 per year, with an annual Consumer Price Index adjustment.

**SPECIFIC LEASE PROVISIONS:**

Liability insurance in an amount no less than \$1,000,000 per occurrence.

**OTHER PERTINENT INFORMATION:**

1. The Applicant owns the upland adjoining the lease premises.
2. On June 26, 2006, the Commission authorized a 10-year Recreational Pier Lease to Bruce T. Eisenhard and Nancy K. Eisenhard. The lease will expire on May 31, 2016. On October 22, 2007, the upland ownership was transferred to Bruce T. Eisenhard and Nancy Eisenhard, Trustees, or their successors in trust, under the Eisenhard Living Trust, dated September 11, 2007 and any amendments thereto. The Applicant is now applying for a General Lease – Recreational Use.

CALENDAR ITEM NO. **C08** (CONT'D)

3. The staff recommends that the Commission find that this activity is exempt from the requirements of the California Environmental Quality Act (CEQA) as a categorically exempt project. The project is exempt under Class 1, Existing Facilities; California Code of Regulations, Title 2, section 2905, subdivision (a)(2).

Authority: Public Resources Code section 21084 and California Code of Regulations, Title 14, section 15300 and California Code of Regulations, Title 2, section 2905.

4. This activity involves lands identified as possessing significant environmental values pursuant to Public Resources Code section 6370 et seq., but such activity will not affect those significant lands. Based upon the staff's consultation with the persons nominating such lands and through the CEQA review process, it is the staff's opinion that the project, as proposed, is consistent with its use classification.

**EXHIBITS:**

- A. Land Description
- B. Site and Location Map

**RECOMMENDED ACTION:**

It is recommended that the Commission:

**CEQA FINDING:**

Find that the activity is exempt from the requirements of CEQA pursuant to California Code of Regulations, Title 14, Section 15061 as a categorically exempt project, Class 1, Existing Facilities; California Code of Regulations, Title 2, section 2905, subdivision (a)(2).

**SIGNIFICANT LANDS INVENTORY FINDING:**

Find that this activity is consistent with the use classification designated by the Commission for the land pursuant to Public Resources Code section 6370 et seq.

**AUTHORIZATION:**

Authorize issuance of a General Lease – Recreational Use to Bruce T. Eisenhard and Nancy Eisenhard, Trustees, or their successors in trust, under the Eisenhard Living Trust, dated September 11, 2007 and any amendments thereto, beginning June 1, 2016, for a term of 10 years, for the continued use and maintenance of two existing mooring buoys, as described in Exhibit A and shown on Exhibit B (for reference purposes only), attached and by this reference made a part hereof; annual rent in

CALENDAR ITEM NO. **C08** (CONT'D)

the amount of \$754, with an annual Consumer Price Index adjustment; and liability insurance in an amount no less than \$1,000,000 per occurrence.

**EXHIBIT A**

**PRC 8680.1**

**LAND DESCRIPTION**

Two (2) parcels of submerged land situate in the bed of Lake Tahoe, lying adjacent to Lot 1 fractional Section 14, Township 14 North, Range 17 East, MDM., as shown on Official Government Township Plat approved November 10, 1865 County of Placer, State of California, and more particularly described as follows:

Two (2) circular parcels of land, being 50 feet in diameter, underlying two (2) existing buoys lying adjacent to those parcels as described in Exhibit "A" of that Grant Deed recorded April 13, 1999 as Document 99-0032152 in Official Records of said County.

Accompanying plat is hereby made part of this description.

**END OF DESCRIPTION**

Prepared June 1, 2015 by the California State Lands Commission Boundary Unit.





APN 117-072-012

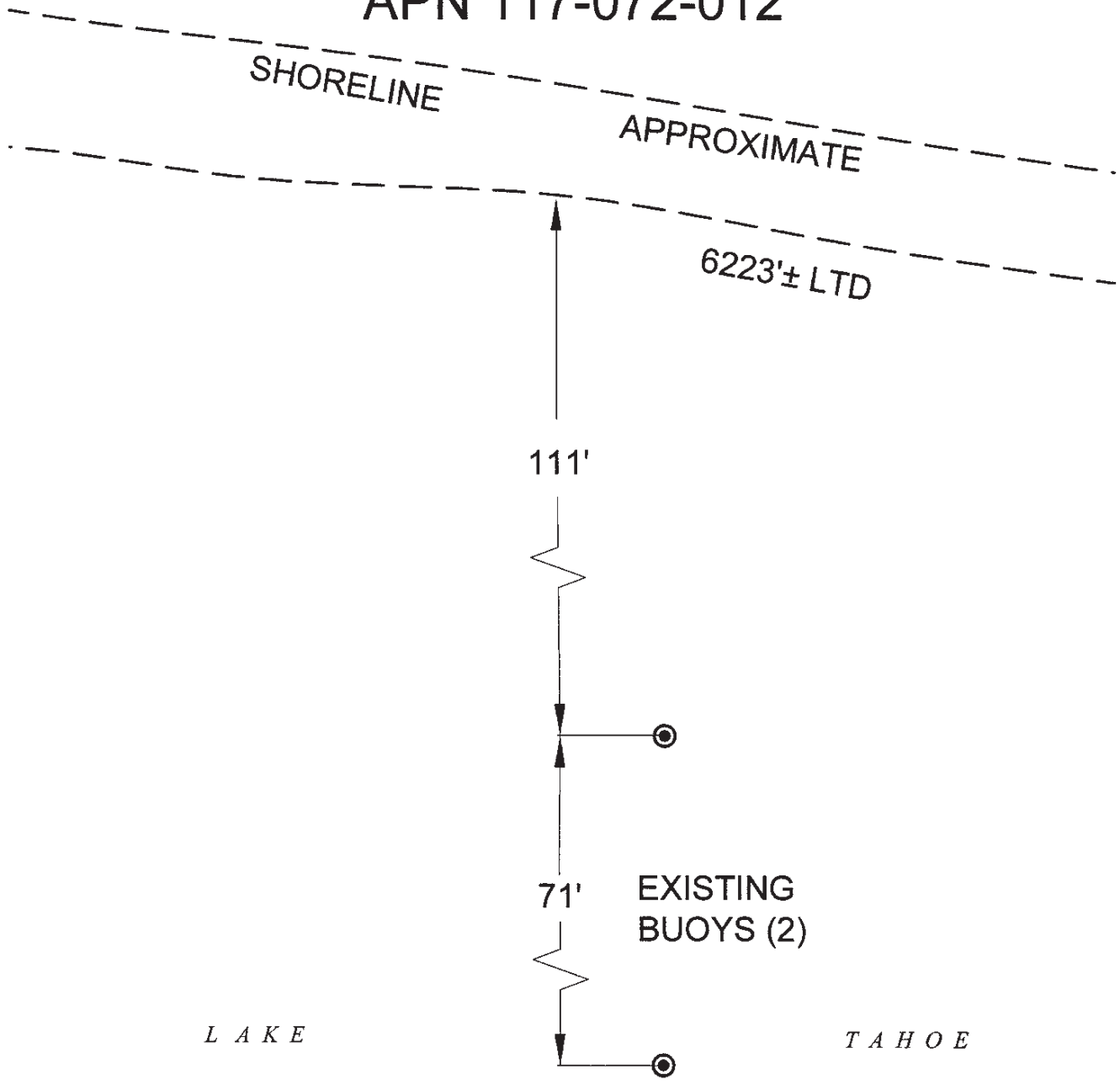

LAKE

TAHOE

EXHIBIT A

Page 2 of 2

MJJ 06/01/15

LAND DESCRIPTION PLAT  
PRC 8680.1, EISENHARD TRUST  
PLACER COUNTY

CALIFORNIA STATE  
LANDS COMMISSION



NO SCALE

# SITE

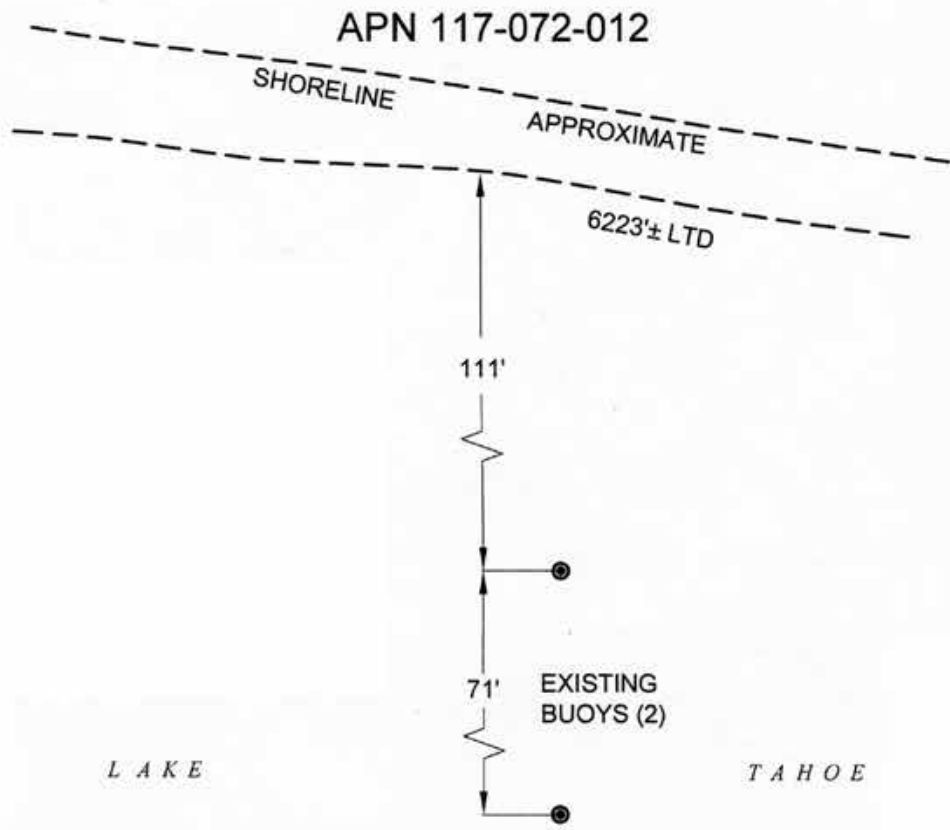

6790 NORTH LAKE BLVD., NEAR TAHOE VISTA

NO SCALE

# LOCATION



## Exhibit B

PRC 8680.1  
 EISENHARD TRUST  
 APN 117-072-012  
 GENERAL LEASE -  
 RECREATIONAL USE  
 PLACER COUNTY



This Exhibit is solely for purposes of generally defining the lease premises, is based on unverified information provided by the Lessee or other parties and is not intended to be, nor shall it be construed as, a waiver or limitation of any State interest in the subject or any other property.