

**CALENDAR ITEM  
C26**

A 1  
S 1

08/15/14  
PRC 4956.1  
M. Schroeder

**GENERAL LEASE – RECREATIONAL USE**

**APPLICANT:**

The Marchini Family Partnership, a California Limited Partnership

**AREA, LAND TYPE, AND LOCATION:**

Sovereign land in Lake Tahoe, adjacent to 5618 North Lake Boulevard, near Carnelian Bay, Placer County.

**AUTHORIZED USE:**

Continued use and maintenance of an existing pier, boathouse, sundeck with stairs, and two mooring buoys, previously authorized by the Commission; and use and maintenance of an existing boat lift and a gantry with a boat hoist not previously authorized by the Commission.

**LEASE TERM:**

10 years, beginning October 3, 2014

**CONSIDERATION:**

\$2,480 per year, with an annual Consumer Price Index adjustment.

**SPECIFIC LEASE PROVISIONS:**

Insurance:

Liability insurance in an amount no less than \$1,000,000 per occurrence.

Other:

1. The proposed lease contains a provision requiring the Applicant obtain authorization from the Tahoe Regional Planning Agency (TRPA) for the mooring buoys within two years after the adoption of a Final Environmental Impact Statement (FEIS) for the Lake Tahoe Shorezone Ordinance Amendments and approval of the amended ordinances. This is a continuation of the process the Commission used from approximately 1995 to October 2008 when TRPA adopted an FEIS and Ordinance Amendments supported by the FEIS. In September 2010, the U.S. District Court invalidated the FEIS and nullified the Amendments. When additional information is

CALENDAR ITEM NO. **C26** (CONT'D)

available, Commission staff will advise the Commission on any suggested modifications to the process used by the Commission pending resolution of the TRPA FEIS and amended ordinance issues.

2. Lessee expressly acknowledges and agrees that issuance of a lease does not substitute for, or provide preference in, obtaining authorizations from TRPA or any other regulatory agency for the improvements authorized by the Commission.
3. The lease contains provisions stating that the existing sundeck with stairs, as shown on the attached Exhibit B, cannot be expanded, and if repairs to any portion of the existing sundeck cost more than 50 percent of the base value of the sundeck, then the sundeck with stairs must be removed from the lease premises.

**OTHER PERTINENT INFORMATION:**

1. Applicant owns the upland parcel adjoining the lease premises.
2. On December 8, 2005, the Commission authorized a 10-year Recreational Pier Lease to The Marchini Family Partnership, a California Limited Partnership. That lease will expire October 2, 2014. The Applicant is now applying for a General Lease – Recreational Use.
3. The Applicant's boat lift and a gantry with a boat hoist have been in Lake Tahoe for many years but were not previously authorized by the Commission. Staff recommends bringing the existing boat lift and gantry with a boat hoist under lease.
4. The staff recommends that the Commission find that this activity is exempt from the requirements of the California Environmental Quality Act (CEQA) as a categorically exempt project. The project is exempt under Class 1, Existing Facilities; California Code of Regulations, Title 2, section 2905, subdivision (a)(2).

Authority: Public Resources Code section 21084 and California Code of Regulations, Title 14, section 15300 and California Code of Regulations, Title 2, section 2905.

5. This activity involves lands identified as possessing significant environmental values pursuant to Public Resources Code section 6370 et

CALENDAR ITEM NO. **C26** (CONT'D)

seq., but such activity will not affect those significant lands. Based upon the staff's consultation with the persons nominating such lands and through the CEQA review process, it is the staff's opinion that the project, as proposed, is consistent with its use classification.

**EXHIBITS:**

- A. Land Description
- B. Site and Location Map

**RECOMMENDED ACTION:**

It is recommended that the Commission:

**CEQA FINDING:**

Find that the activity is exempt from the requirements of CEQA pursuant to California Code of Regulations, Title 14, section 15061 as a categorically exempt project, Class 1, Existing Facilities; California Code of Regulations, Title 2, section 2905, subdivision (a)(2).

**SIGNIFICANT LANDS INVENTORY FINDING:**

Find that this activity is consistent with the use classification designated by the Commission for the land pursuant to Public Resources Code section 6370 et seq.

**AUTHORIZATION:**

Authorize issuance of a General Lease – Recreational Use to The Marchini Family Partnership, a California Limited Partnership beginning October 3, 2014, for a term of 10 years, for the continued use and maintenance of an existing pier, boathouse, sundeck with stairs, and two mooring buoys previously authorized by the Commission, and use and maintenance of an existing boat lift and a gantry with a boat hoist not previously authorized by the Commission as described in Exhibit A and shown on Exhibit B (for reference purposes only) attached and by this reference made a part hereof; annual rent in the amount of \$2,480, with an annual Consumer Price Index adjustment; and liability insurance in an amount no less than \$1,000,000 per occurrence.

**EXHIBIT A**

**PRC 4956.1**

**LAND DESCRIPTION**

A parcel of submerged land situate in the bed of Lake Tahoe, lying adjacent to Lot 3 fractional Section 15, Township 16 North, Range 17 East, MDM., as shown on Official Government Township Plat approved November 10, 1865, County of Placer, State of California, and more particularly described as follows:

**PARCEL 1 –PIER & BOATHOUSES**

All those lands underlying an existing pier, one boathouse with sundeck and stairs, boat lift and one gantry with boat hoist, adjacent to that Lot as described in Individual Grant Deed recorded October 16, 2006 as Document Number 2006-0110156 of said County.

TOGETHER WITH any applicable impact area(s).

EXCEPTING THEREFROM any portion(s) lying landward of elevation 6223 feet LTD on the shoreline of said Lake Tahoe.

**PARCELS 2 & 3 – BUOYS**

Two (2) circular parcels of land, being 50 feet in diameter, underlying two (2) existing buoys lying adjacent to said Lot.

Accompanying plat is hereby made part of this description.

**END OF DESCRIPTION**

Prepared July 14, 2014 by The California State Lands Commission Boundary Unit.



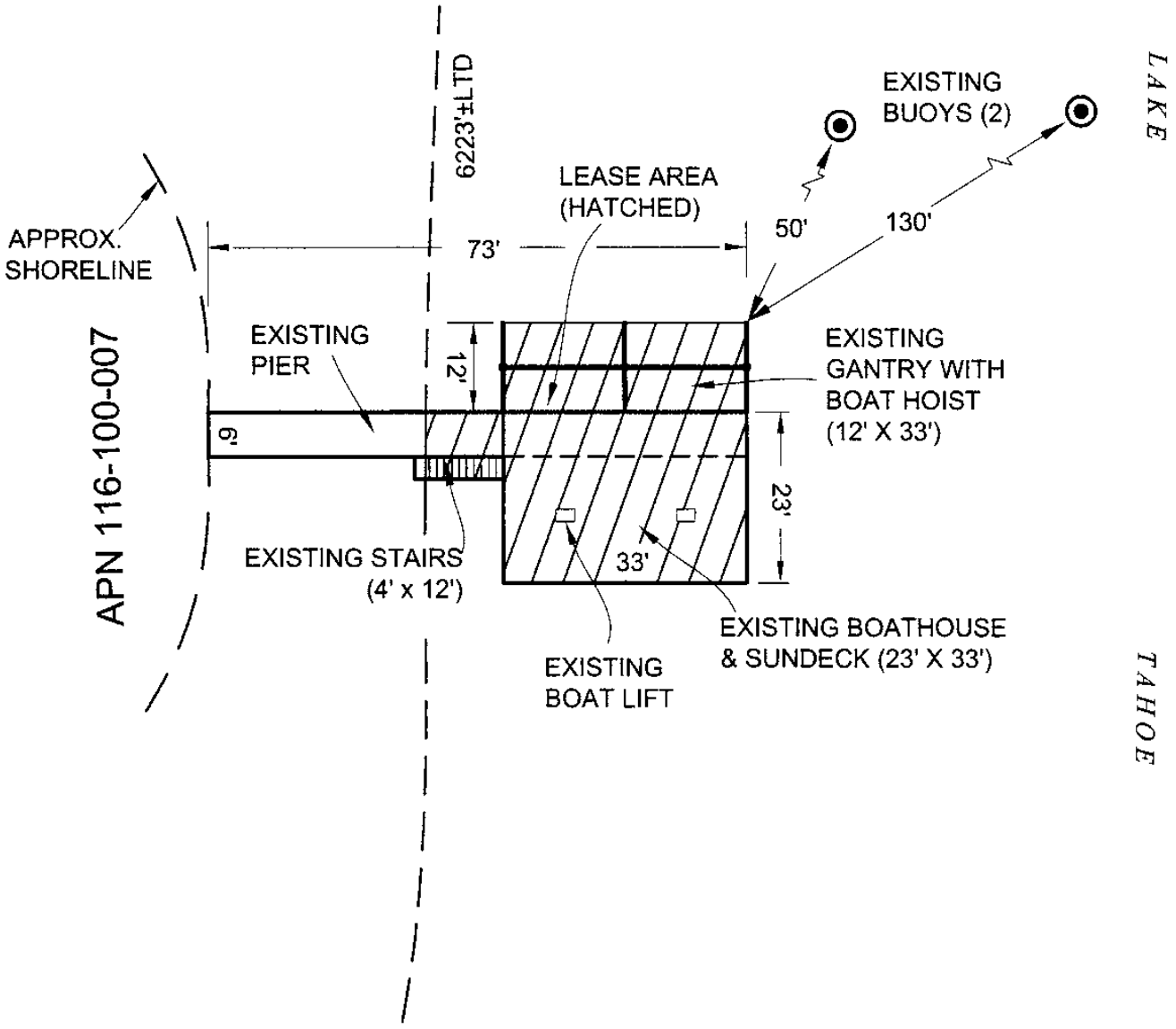

**EXHIBIT A**

Page 2 of 2

MJJ 03/17/2014

LAND DESCRIPTION PLAT  
 PRC 4956.1, THE MARCHINI FAMILY PARTNERSHIP  
 PLACER COUNTY

CALIFORNIA STATE  
 LANDS COMMISSION



NO SCALE

# SITE

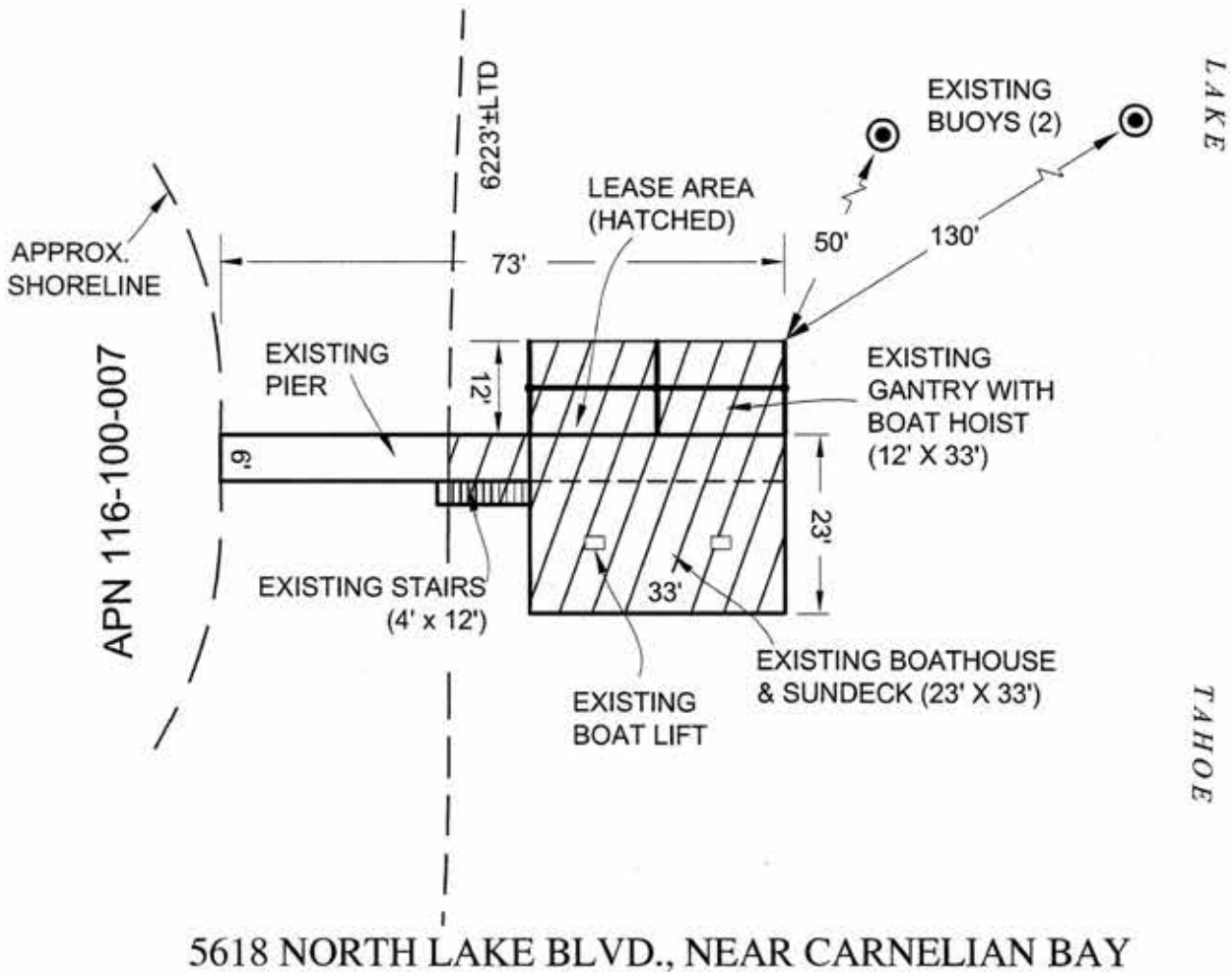

5618 NORTH LAKE BLVD., NEAR CARNELIAN BAY

NO SCALE

# LOCATION

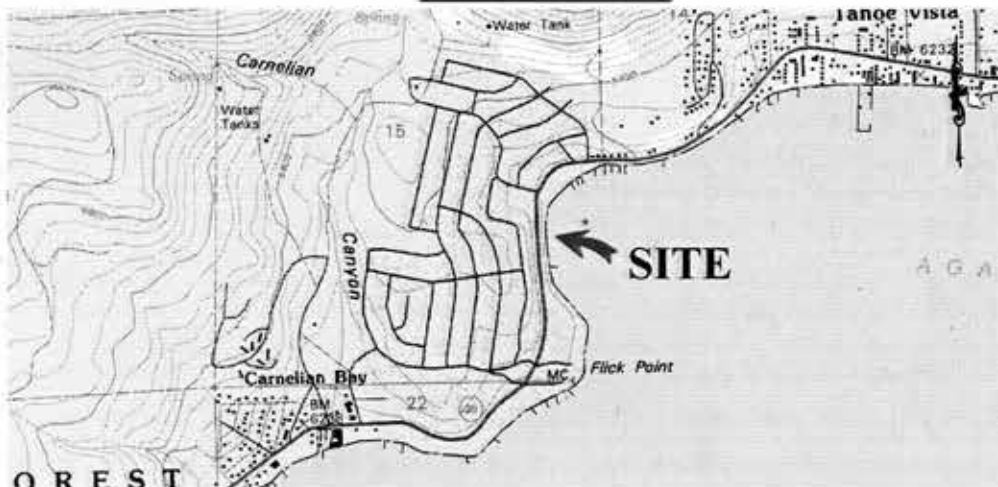

MAP SOURCE: USGS QUAD

# Exhibit B

PRC 4956.1  
 THE MARCHINI FAMILY  
 PARTNERSHIP  
 APN 116-100-007  
 GENERAL LEASE -  
 RECREATIONAL USE  
 PLACER COUNTY



MJJ 03/17/2014

This Exhibit is solely for purposes of generally defining the lease premises, is based on unverified information provided by the Lessee or other parties and is not intended to be, nor shall it be construed as, a waiver or limitation of any State interest in the subject or any other property.