

**CALENDAR ITEM
C37**

A 6
S 3

06/21/13
PRC 5526.1
D. Oetzel

REVISION OF RENT

LESSEE:

Michael and Jessica LeMieux
130 Harbor Drive
Novato, CA 94945

AREA, LAND TYPE, AND LOCATION:

Sovereign lands in the Petaluma River, at Black Point, near the city of Novato,
Marin County

AUTHORIZED USE:

Continued use and maintenance of an existing pier, ramp, deck, and floating boat
dock as shown on Exhibit A.

LEASE TERM:

Ten years, beginning April 29, 2007.

CONSIDERATION:

This lease provides that Lessor may modify the rent periodically during the lease
term. Pursuant to this provision, staff conducted a review of the rent under this
lease, and recommends that rent be revised from \$50 per year to \$55 per year
for the deck, effective April 29, 2013. For the floating boat dock, pier, and ramp
there is no monetary consideration pursuant to Public Resources Code section
6503.5.

OTHER PERTINENT INFORMATION

1. On May 10, 2007, the Commission authorized a General Lease –
Recreational Use for a term of 10 years, beginning April 29, 2007.

2. The staff recommends that the Commission find that the subject revision
of rent does not have a potential for resulting in either a direct or a
reasonably foreseeable indirect physical change in the environment, and
is, therefore, not a project in accordance with the California Environmental
Quality Act (CEQA).

CALENDAR ITEM NO. **C37** (CONT'D)

Authority: Public Resources Code section 21065 and California Code of Regulations, Title 14, sections 15060, subdivision (c)(3), and 15378.

EXHIBIT:

- A. Site and Location Map

RECOMMENDED ACTION:

CEQA FINDING:

Find that the subject revision of rent is not subject to the requirements of CEQA pursuant to California Code of Regulations, Title 14, section 15060, subdivision (c)(3), because the subject activity is not a project as defined by Public Resources Code section 21065 and California Code of Regulations, Title 14, section 15378.

AUTHORIZATION:

Approve the revision of rent for Lease No. PRC 5526.1 from \$50 per year to \$55 per year, effective April 29, 2013.

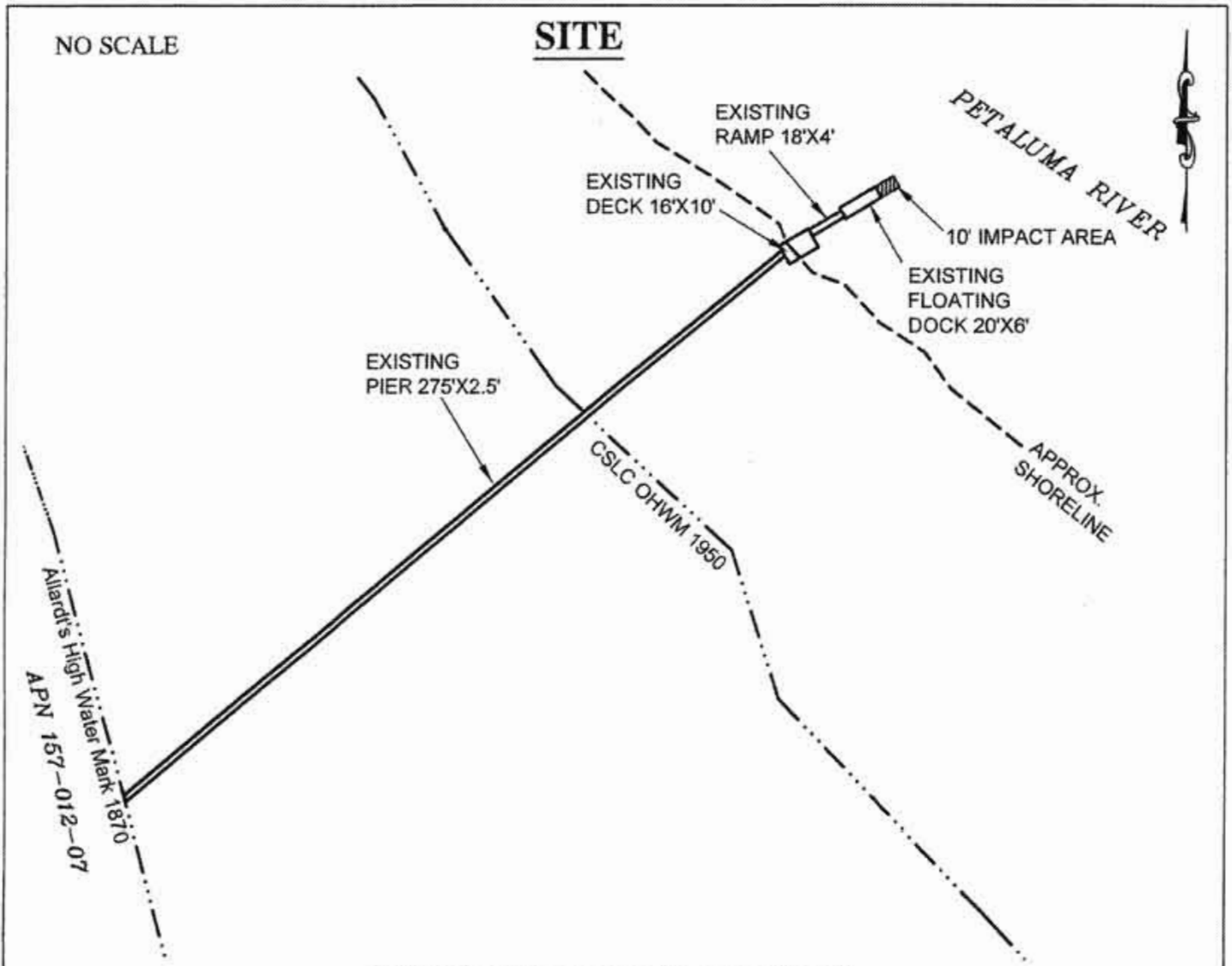

130 HARBOR DRIVE, NOVATO

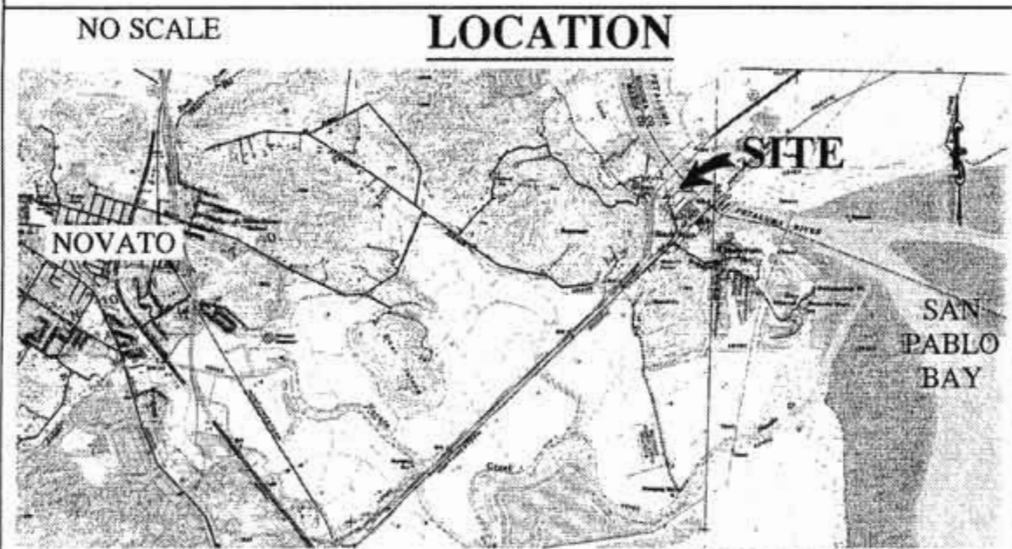

MAP SOURCE: USGS QUAD

Exhibit A
 PRC 5526.1
 LEMIEUX
 APN 157-012-07
 GENERAL LEASE -
 RECREATIONAL USE
 MARIN COUNTY



TS 02/13/13

This Exhibit is solely for purposes of generally defining the lease premises, is based on unverified information provided by the Lessee or other parties and is not intended to be, nor shall it be construed as, a waiver or limitation of any State interest in the subject or any other property.