

**CALENDAR ITEM
C82**

A 33
S 16

04/26/13
W 26562
R. Collins

**GENERAL LEASE -
PROTECTIVE STRUCTURE USE**

APPLICANTS:

Russell Joseph Chidley and Susan Elizabeth Chidley

AREA, LAND TYPE, AND LOCATION:

Sovereign land in the Colorado River, adjacent to 1190 Beach Drive, city of Needles, San Bernardino County.

AUTHORIZED USE:

Use and maintenance of a riprap bankline.

LEASE TERM:

10 years, beginning April 26, 2013.

CONSIDERATION:

The public use and benefit, with the State reserving the right to set a monetary consideration if it is determined to be in the best interest of the State.

SPECIFIC LEASE PROVISIONS:

Insurance: Liability insurance in an amount no less than \$1,000,000 per occurrence.

Other: Applicants acknowledge that the Public Access Easement shall remain open to the public and that no structures or improvements shall be erected and no personal property placed so as to obstruct or prevent public access in and along the Easement. Such improvements include, but are not limited to, fences, walls, railings, or landscaping. Applicants further acknowledge that they shall not place signs or advocate in any other manner in such a way as to prevent or discourage public use of the Public Access Easement.

CALENDAR ITEM NO. **C82** (CONT'D)

OTHER PERTINENT INFORMATION:

1. Applicants own the upland adjoining the lease premises.
2. The State of California had its fee ownership of the sovereign land located in the Colorado River at this location confirmed in 1991 as a result of a Boundary Line Agreement and Compromise Settlement entered into between the Commission and Kahala Needles Partners, Ltd., a Nevada Limited Partnership, recorded as AD 134 dated January 1, 1991, and recorded on August 11, 1992, document No. 92-333250, Official Records, San Bernardino County, California. Projects, including new development or maintenance of existing facilities, extending waterward of the Ordinary High Water Mark (OHWM) fixed in the above-mentioned Agreement (AD 134) require a lease from the Commission pursuant to Public Resources Code section 6501.1. The Applicants' upland property is located along the Colorado River adjacent to the fixed OHWM.
3. Pursuant to the above-mentioned Boundary Line Agreement and Compromise Settlement, the State of California was granted a perpetual public pedestrian access easement running parallel to the fixed OHWM. The easement is intended to provide public access to and along the bank of the Colorado River. The easement affects lots 1-40 of the Rio Buena Vista residential subdivision, one of which is the Applicants' property. Public access to the easement is from the northern or southern end of the subdivision, or from the Colorado River.
4. The United States Department of the Interior, Bureau of Reclamation (Reclamation), Yuma Area Office conducted a review by boat of the riprap bankline on March 27, 2002, and also conducted a site visit on April 10, 2002. The inspection revealed that the bankline had been cleared of vegetation and that the federally applied riprap and federally constructed jetties were undisturbed and in good condition. By letter dated April 23, 2002, Reclamation acknowledged their capacity to apply additional riprap to the bankline location in the future was compromised due to the pending development of the upland residences and subsequently declared that Reclamation would not provide additional riprap to the bankline location in the future. Consequently, Reclamation decreed that the upland homeowner (Applicants) would be responsible for maintaining protection of their own banklines in the future, subject to the homeowners seeking approval and permitting of their riprap or bankline construction work from the United States Army Corps of Engineers under Section 10 of the Rivers and Harbors Act of 1899.

CALENDAR ITEM NO. **C82** (CONT'D)

5. The riprap bankline mutually benefits both the public and the Applicants, and will be maintained by the Applicants at no cost to the public.
6. The staff recommends that the Commission find that this activity is exempt from the requirements of the California Environmental Quality Act (CEQA) as a categorically exempt project. The project is exempt under Class 1, Existing Facilities; California Code of Regulations, Title 2, section 2905, subdivision (a)(2).

Authority: Public Resources Code section 21084 and California Code of Regulations, Title 14, section 15300 and California Code of Regulations, Title 2, section 2905.

7. This activity involves lands identified as possessing significant environmental values pursuant to Public Resources Code section 6370 et seq., but such activity will not affect those significant lands. Based upon the staff's consultation with the persons nominating such lands and through the CEQA review process, it is the staff's opinion that the project, as proposed, is consistent with its use classification.

EXHIBITS:

- A. Land Description
- B. Site and Location Map

RECOMMENDED ACTION:

It is recommended that the Commission:

CEQA FINDING:

Find that the activity is exempt from the requirements of CEQA pursuant to California Code of Regulations, Title 14, section 15061 as a categorically exempt project, Class 1, Existing Facilities; California Code of Regulations, Title 2, section 2905, subdivision (a)(2).

SIGNIFICANT LANDS INVENTORY FINDING:

Find that this activity is consistent with the use classification designated by the Commission for the land pursuant to Public Resources Code section 6370 et seq.

AUTHORIZATION:

Authorize Issuance of a General Lease – Protective Structure Use to Russell Joseph Chidley and Susan Elizabeth Chidley beginning April 26, 2013, for a term of 10 years, for use and maintenance of a riprap bankline, as described in Exhibit A attached and by this reference made a part

CALENDAR ITEM NO. **C82** (CONT'D)

hereof and shown on Exhibit B (for reference purposes only); consideration for the riprap bankline to be the public use and benefit, with the State reserving the right to set a monetary consideration if it is determined to be in the best interest of the State; liability insurance in an amount no less than \$1,000,000 per occurrence.

EXHIBIT A

W 26562

LAND DESCRIPTION

A parcel of State owned land adjacent to Lot 16 of Tract No. 15640 as shown on Tract Map filed in Book 261, Pages 88 through 94, inclusive of Maps, in the Office of the County Recorder of San Bernardino County, State of California, more particularly described as follows:

BEGINNING at the easterly corner of said Lot 16; thence northwesterly along the northeasterly line of said Lot, said northeasterly line also being the Agreed Boundary Line as described in Exhibit A of Document Number 92-333250, recorded on August 11, 1992, Official Records of said County, N 55°01'49" W 50.76 feet to the northerly corner of said Lot; thence leaving said line, along the northeasterly prolongation of the northwesterly line of said Lot 16 N 33°18'50" E 90.04 feet; thence S 55°01'49" W 56.87 feet to the intersection with the northeasterly prolongation of the southeasterly line of said Lot 16; thence southwesterly along said northeasterly prolongation 90.07 feet to the **POINT OF BEGINNING**.

EXCEPTING THEREFROM any portion lying waterward of the toe of riprap adjacent to said Lot 16.

END OF DESCRIPTION

Prepared 3/13/2013 by the California State Lands Commission Boundary Unit.



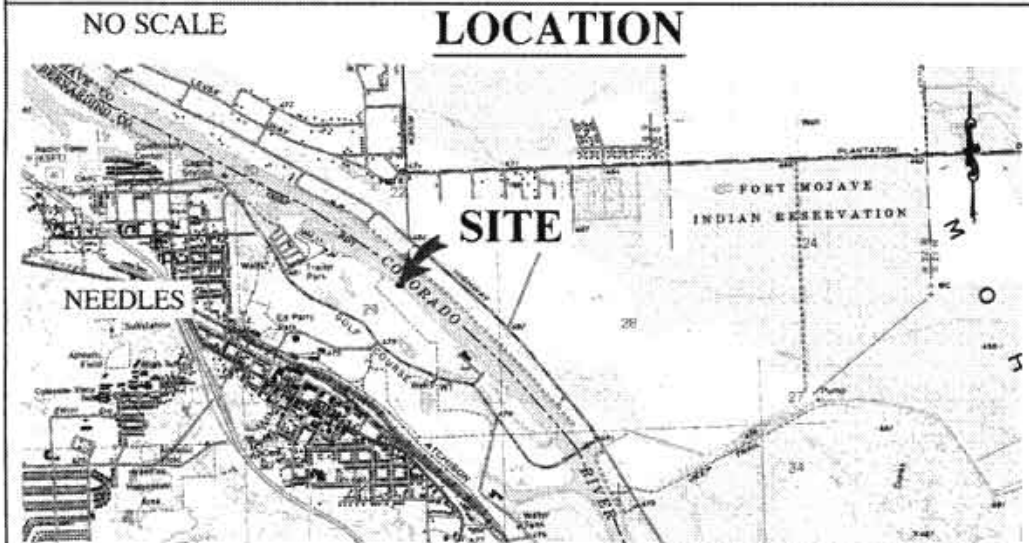
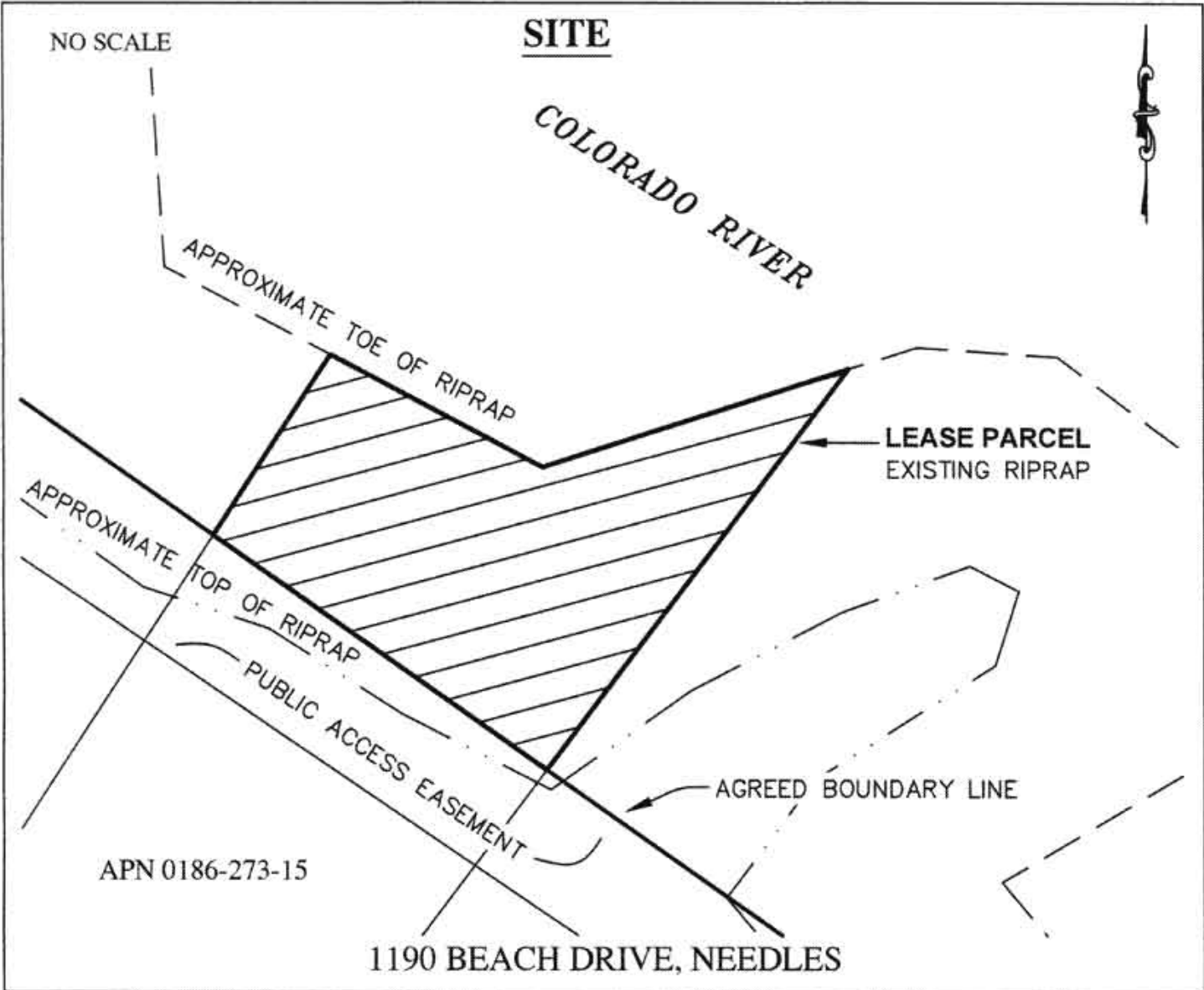

MAP SOURCE: USGS QUAD

Exhibit B
 W26562
 CHIDLEY
 APN 0186-273-15
 GENERAL LEASE -
 PROTECTIVE
 STRUCTURE USE
 SAN BERNARDINO COUNTY



This Exhibit is solely for purposes of generally defining the lease premises, is based on unverified information provided by the Lessee or other parties and is not intended to be, nor shall it be construed as, a waiver or limitation of any State interest in the subject or any other property.