

**CALENDAR ITEM
C91**

A 67
S 35

06/23/11
WP 3253.1
S. Paschall

GENERAL LEASE – RECREATIONAL USE

APPLICANTS:

Nagy Khalil and Alice Khalil

AREA, LAND TYPE, AND LOCATION:

Sovereign land located in Huntington Harbour, adjacent to 16542 Somerset Lane, City of Huntington Beach, Orange County.

AUTHORIZED USE:

The continued use and maintenance of an existing boat dock and access ramp, and the retention, use, and maintenance of an existing cantilevered deck extending no more than five feet waterward of the bulkhead.

LEASE TERM:

10 years, beginning April 1, 2011.

CONSIDERATION:

Boat dock and access ramp: No monetary consideration pursuant to Public Resources Code section 6503.5.

Cantilevered deck: Annual rent in the amount of \$1,098, with the State reserving the right to fix a different rent periodically during the lease term, as provided in the lease.

SPECIFIC LEASE PROVISIONS:

Insurance:

Combined single-limit liability insurance coverage in the amount of no less than \$1,000,000.

Other:

No permanent roof or other enclosure will be constructed on the Lease Premises. Applicants agree that any proposed use of the Lease Premises that includes an extension of the actual living quarters constitutes residential use and is prohibited.

OTHER PERTINENT INFORMATION:

1. Applicants own the uplands adjoining the lease premises.

CALENDAR ITEM NO. **C91** (CONT'D)

2. The State of California acquired fee ownership of the Huntington Harbour Main and Midway Channels in 1961 as a result of the land exchange agreement entered into between the Commission and the Huntington Harbour Corporation, recorded as Sovereign Lands Location No. 34 dated December 22, 1960 and recorded on January 31, 1961 in Book 5611, Page 470, Official Records, Orange County, California. Projects, including new development or maintenance of existing facilities, extending into these Channels beyond the bulkhead line require a lease from the Commission pursuant to Public Resources Code section 6501.1. The Applicants' upland property is located along the Midway Channel of Huntington Harbour.
3. On April 24, 2001, the Commission authorized the issuance of a Recreational Pier Lease, PRC 3253.9, to Cynthia D Williams, for a 10-year term, effective April 1, 2001. The lease expired on March 31, 2011. On March 10, 2011, State Lands staff was informed that the property was sold to the Applicants on March 7, 2011. The Applicants are now applying for a new General Lease – Recreational Use for the existing boat dock and access ramp as well as for the existing cantilevered deck. A five-foot portion of the cantilevered deck extends over the State's fee owned land in the Midway Channel of Huntington Harbour, and was not previously authorized by the Commission. Since the deck is existing, staff is recommending that it be included in the lease.
4. The existing boat dock and access ramp qualify for rent-free status as the Applicants are natural persons who own the littoral land improved with a single-family dwelling pursuant to Public Resources Code section 6503.5.
5. The existing cantilevered deck does not qualify for rent-free status because it is not used for the mooring or docking of boats. Therefore, that portion of the deck extending over State fee owned land within the Harbour is subject to annual rent pursuant to Public Resources Code section 6503.
6. **Existing Facilities:** Pursuant to the Commission's delegation of authority and the State CEQA Guidelines (Title 14, California Code of Regulations, section 15061), the staff has determined that this activity is exempt from the requirements of CEQA as a categorically exempt project. The project is exempt under Class 1, Existing Facilities; Title 2, California Code of Regulations, section 2905 (a)(2).

CALENDAR ITEM NO. **C91** (CONT'D)

Authority: Public Resources Code section 21084 and Title 14, California Code of Regulations, section 15300 and Title 2, California Code of Regulations, section 2905.

7. This activity involves lands identified as possessing significant environmental values pursuant to Public Resources Code section 6370, et seq., but such activity will not affect those significant lands. Based upon the staff's consultation with the persons nominating such lands and through the CEQA review process, it is the staff's opinion that the project, as proposed, is consistent with its use classification.

EXHIBITS:

- A. Location and Site Map
- B. Land Description

RECOMMENDED ACTIONS:

It is recommended that the Commission:

CEQA FINDING:

Existing Facilities: Find that the activity is exempt from the requirements of CEQA pursuant to Title 14, California Code of Regulations, section 15061 as a categorically exempt project, Class 1, Existing Facilities; Title 2, California Code of Regulations, section 2905 (a)(2).

SIGNIFICANT LANDS INVENTORY FINDING:

Find that this activity is consistent with the use classification designated by the Commission for the land pursuant to Public Resources Code section 6370, et seq.

AUTHORIZATION:

Authorize issuance of a General Lease - Recreational Use to Nagy Khalil and Alice Khalil, beginning April 1, 2011, for a term of 10 years, for the continued use and maintenance of an existing boat dock and access ramp; and the retention, use, and maintenance of an existing cantilevered deck as shown on Exhibit A attached (for reference purposes only) and described on Exhibit B attached and by this reference made a part hereof; consideration for the boat dock and access ramp: no monetary consideration pursuant to Public Resources Code section 6503.5; consideration for the cantilevered deck: annual rent in the amount of \$1,098, with the State reserving the right to fix a different rent periodically during the lease term as provided in the lease; combined single-limit liability insurance coverage in the amount of no less than \$1,000,000.

NO SCALE

SITE

State of California 400' Channel

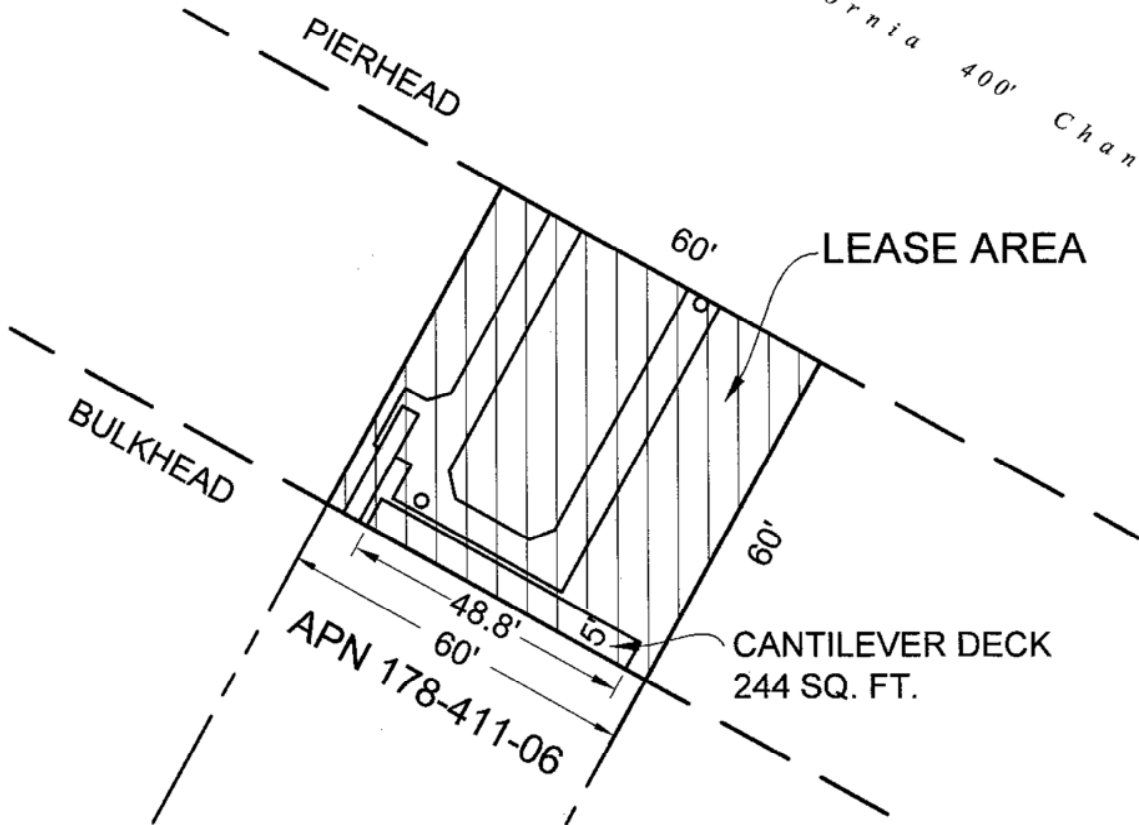

16542 SOMERSET LANE, HUNTINGTON BEACH

NO SCALE

LOCATION



MAP SOURCE: USGS QUAD

Exhibit A

WP 3253.1
 KHALIL
 APN 178-411-06
 GENERAL LEASE
 RECREATIONAL USE
 ORANGE COUNTY



MJJ 05/11

This Exhibit is solely for purposes of generally defining the lease premises, is based on unverified information provided by the Lessee or other parties and is not intended to be, nor shall it be construed as, a waiver or limitation of any State interest in the subject or any other property.

EXHIBIT B

WP 3253.1

LAND DESCRIPTION

Parcel 1 –(adjacent to APN 178-411-06)

A parcel of tide and submerged land situate in the City of Huntington Beach, Orange County, California and more particularly described as follows:

Beginning at the most easterly corner of Lot 39, as said lot is shown on that certain map entitled Tract No. 4677, filed in Book 168 of Miscellaneous Maps at Pages 14 to 18, Orange County Records; thence along the northeasterly line of said lot, 60.00 feet to the most northerly corner of said lot; thence northeasterly along the northeasterly prolongation of the northwesterly line of said lot, 60.00 feet to a line which is parallel with and distant 60.00 feet northeasterly from said northeasterly line of said lot; thence along said parallel line, 60.00 feet to the northeasterly prolongation of the southeasterly line of said lot; thence southwesterly along said prolongation, 60.00 feet to the point of beginning.

Prepared in March, 2001 from record data.

