

**MINUTE ITEM**

This Calendar Item No. C03 was approved as Minute Item No. 03 by the California State Lands Commission by a vote of 3 to 0 at its 02/05/07 meeting.

**CALENDAR ITEM  
C03**

A 4  
S 1

02/05/07  
PRC 4145 WP 4145.9  
L. Danley

**RECREATIONAL PIER LEASE**

**APPLICANTS:**

R. Daniel Putman and Kathleen L. Williams

**AREA, LAND TYPE, AND LOCATION:**

Sovereign lands in Lake Tahoe, near Meeks Bay, El Dorado County.

**AUTHORIZED USE:**

Continued use and maintenance of an existing pier, boat lift and two mooring buoys as shown on the attached Exhibit A.

**LEASE TERM:**

Ten years, beginning January 1, 2007.

**CONSIDERATION:**

No monetary consideration pursuant to Public Resources Code section 6503.5.

**SPECIFIC LEASE PROVISIONS:**

Insurance:

Liability insurance in the amount of no less than \$300,000.

Other:

The lease contains a provision which requires the Applicants to obtain authorization from the Tahoe Regional Planning Agency (TRPA) for the mooring buoys within two years after the adoption of the Lake Tahoe Shorezone Amendments-Draft Environmental Impact Statement (EIS) and approval of the ordinances based on the EIS.

**OTHER PERTINENT INFORMATION:**

1. Applicants own the upland property adjoining the lease premises.
2. On February 12, 1997, the Commission authorized a Recreational Pier Lease with R. Daniel Putman and Kathleen L. Williams. That lease expired on December 31, 2006. Applicants are now applying for a new

CALENDAR ITEM NO. C03 (CONT'D)

Recreational Pier Lease for an existing pier, boat lift and two mooring buoys previously authorized by the Commission.

3. Applicants qualify for a Recreational Pier Lease because they are natural persons who have improved the littoral land with, and use the upland for, a single-family dwelling.
4. Pursuant to the Commission's delegation of authority and the State CEQA Guidelines (Title 14, California Code of Regulations, section 15061), the staff has determined that this activity is exempt from the requirements of the CEQA as a categorically exempt project. The project is exempt under Class 1, Existing Facilities; Title 2, California Code of Regulations, section 2905 (a)(2).

Authority: Public Resources Code section 21084 and Title 14, California Code of Regulations, section 15300 and Title 2, California Code of Regulations, section 2905.

5. This activity involves lands identified as possessing significant environmental values pursuant to Public Resources Code sections 6370, et seq. Based upon the staff's consultation with the persons nominating such lands and through the CEQA review process, it is the staff's opinion that the project, as proposed, is consistent with its use classification.

**APPROVAL REQUIRED:**

**Buoys:** Tahoe Regional Planning Agency

**EXHIBIT:**

- A. Site and Location Map

**RECOMMENDED ACTION:**

IT IS RECOMMENDED THAT THE COMMISSION:

**CEQA FINDING:**

FIND THAT THE ACTIVITY IS EXEMPT FROM THE REQUIREMENTS OF THE CEQA PURSUANT TO TITLE 14, CALIFORNIA CODE OF REGULATIONS, SECTION 15061 AS A CATEGORICALLY EXEMPT PROJECT, CLASS 1, EXISTING FACILITIES; TITLE 2, CALIFORNIA CODE OF REGULATIONS, SECTION 2905 (a)(2).

CALENDAR ITEM NO. C03 (CONT'D)

**SIGNIFICANT LANDS INVENTORY FINDING:**

FIND THAT THIS ACTIVITY IS CONSISTENT WITH THE USE CLASSIFICATION DESIGNATED BY THE COMMISSION FOR THE LAND PURSUANT TO PUBLIC RESOURCES CODE SECTIONS 6370, ET SEQ.

**AUTHORIZATION:**

AUTHORIZE ISSUANCE TO R. DANIEL PUTMAN AND KATHLEEN L. WILLIAMS OF A TEN-YEAR RECREATIONAL PIER LEASE, BEGINNING JANUARY 1, 2007, FOR THE CONTINUED USE AND MAINTENANCE OF AN EXISTING PIER, BOAT LIFT AND TWO MOORING BUOYS AS SHOWN ON EXHIBIT A ATTACHED AND BY THIS REFERENCE MADE A PART HEREOF; NO MONETARY CONSIDERATION PURSUANT TO PUBLIC RESOURCES CODE SECTION 6503.5; LIABILITY INSURANCE IN THE AMOUNT OF NO LESS THAN \$300,000.

NO SCALE

# SITE

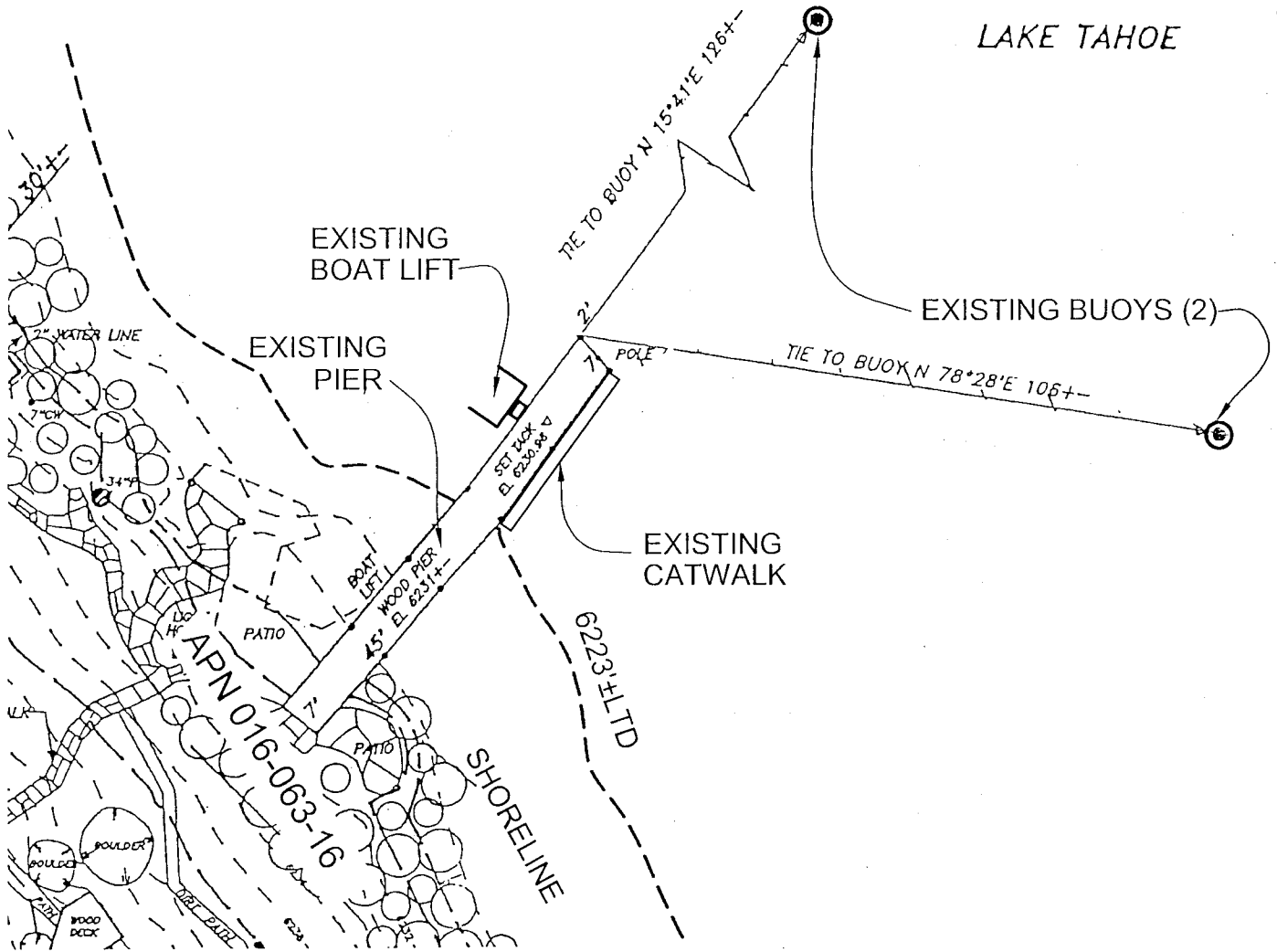

8307 MEEKS BAY AVENUE, NEAR MEEKS BAY

NO SCALE

# LOCATION

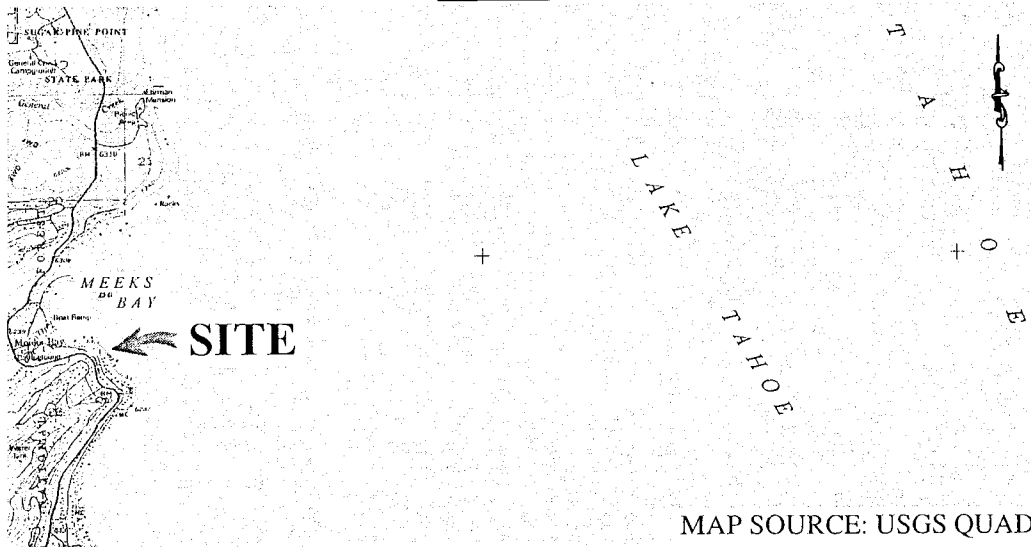

MAP SOURCE: USGS QUAD

# Exhibit A

PRC 4145.9  
 PUTMAN  
 APN 016-063-16  
 RECREATIONAL PIER LEASE  
 EL DORADO COUNTY

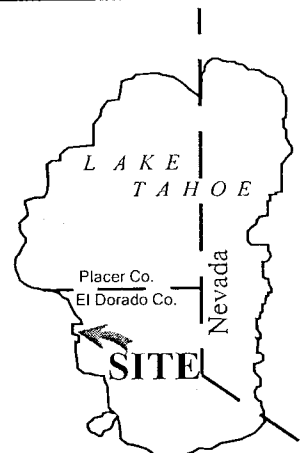

This Exhibit is solely for purposes of generally defining the lease premises, is based on unverified information provided by the Lessee or other parties and is not intended to be, nor shall it be construed as, a waiver or limitation of any State interest in the subject or any other property.

CALENDAR PAGE

MINUTE PAGE