

**MINUTE ITEM**

This Calendar Item No. C40 was approved as Minute Item No. 40 by the California State Lands Commission by a vote of 3 to 0 at its 12-14-06 meeting.

**CALENDAR ITEM  
C40**

A 41  
S 28

12/14/06  
WP 4729.9  
S.Young

**GENERAL LEASE - PUBLIC AGENCY USE**

**APPLICANT:**

Los Angeles County Flood Control District  
900 S. Fremont Avenue  
Alhambra, CA 91802-1460

**AREA, LAND TYPE, AND LOCATION:**

0.330 acres, more or less, of tide and submerged lands in the Pacific Ocean, adjacent to the Dockweiler State Beach, near the city of El Segundo, Los Angeles County.

**AUTHORIZED USE:**

Continued use and maintenance of a storm drain terminus.

**LEASE TERM:**

25 years, beginning January 25, 2003.

**CONSIDERATION:**

The public health and safety; with the State reserving the right at any time to set a monetary rental if the Commission finds such action to be in the State's best interest.

**SPECIFIC LEASE PROVISIONS:**

Insurance:

Combined single limit coverage of no less than \$1,000,000.

**OTHER PERTINENT INFORMATION:**

1. Applicant has the right to use the uplands adjoining the lease premises.
2. On September 14, 1988, the Commission approved the issuance of a General Lease – Public Agency Use, Lease No. PRC 4729.9, for a 15-year term to the Los Angeles County Flood Control District (LACFD) for a storm drain terminus adjacent to Dockweiler State Beach. The lease

CALENDAR ITEM NO. C40 (CONT'D)

expired on January 24, 2003. The LACFD is now applying for a new General Lease – Public Agency Use for the storm drain.

3. No changes have been made to the storm drain other than normal maintenance and repairs. Under the terms of the lease no discharge of waste into the drain is permitted. The discharge structure is designed to be covered during the summer months and mechanically exposed during winter months to allow for storm water flow. A protective railing is installed around the perimeter of the drain which serves as a safety feature when the storm drain terminus is exposed during the winter.
4. On December 13, 2001, the California Regional Water Quality Control Board, Los Angeles Region, issued to LACFD, its National Pollution Discharge Elimination System (NPDES) Permit No. CAS004001 in connection with the waste discharge requirements for municipal storm water and urban runoff discharges within the county of Los Angeles. On its expiration in December of 2006, the permit will remain in effect until a new permit is issued. Under the terms of Lease No. PRC 4729.9, LACFD is required to obtain and maintain all permits for the storm drain.
5. Pursuant to the Commission's delegation of authority and the State CEQA Guidelines (Title 14, California Code of Regulations, section 15061), the staff has determined that this activity is exempt from the requirements of the CEQA as a categorically exempt project. The project is exempt under Class 1, Existing Facilities; Title 2, California Code of Regulations, section 2905 (a)(2).

Authority: Public Resources Code section 21084 and Title 14, California Code of Regulations, section 15300 and Title 2, California Code of Regulations, section 2905.

6. This activity involves lands identified as possessing significant environmental values pursuant to Public Resources Code sections 6370, et seq. Based upon the staff's consultation with the persons nominating such lands and through the CEQA review process, it is the staff's opinion that the project, as proposed, is consistent with its use classification.

**EXHIBITS:**

- A. Location and Site Map
- B. Land Description

CALENDAR ITEM NO. C40 (CONT'D)

**RECOMMENDED ACTION:**

IT IS RECOMMENDED THAT THE COMMISSION:

**CEQA FINDING:**

FIND THAT THE ACTIVITY IS EXEMPT FROM THE REQUIREMENTS OF THE CEQA PURSUANT TO TITLE 14, CALIFORNIA CODE OF REGULATIONS, SECTION 15061 AS A CATEGORICALLY EXEMPT PROJECT, CLASS 1, EXISTING FACILITIES; TITLE 2, CALIFORNIA CODE OF REGULATIONS, SECTION 2905 (a)(2).

**SIGNIFICANT LANDS INVENTORY FINDING:**

FIND THAT THIS ACTIVITY IS CONSISTENT WITH THE USE CLASSIFICATION DESIGNATED BY THE COMMISSION FOR THE LAND PURSUANT TO PUBLIC RESOURCES CODE SECTIONS 6370, ET SEQ.

**AUTHORIZATION:**

AUTHORIZE ISSUANCE TO THE LOS ANGELES COUNTY FLOOD CONTROL DISTRICT OF A GENERAL LEASE - PUBLIC AGENCY USE, BEGINNING JANUARY 25, 2003, FOR A TERM OF 25 YEARS, FOR THE CONTINUED USE AND MAINTENANCE OF AN EXISTING STORM DRAIN TERMINUS AS SHOWN ON EXHIBIT A AND AS DESCRIBED ON EXHIBIT B ATTACHED AND BY THIS REFERENCE MADE A PART HEREOF; CONSIDERATION BEING THE PUBLIC HEALTH AND SAFETY; WITH THE STATE RESERVING THE RIGHT AT ANY TIME TO SET A MONETARY RENTAL IF THE COMMISSION FINDS SUCH ACTION TO BE IN THE STATE'S BEST INTEREST; LIABILITY INSURANCE IN AN AMOUNT OF NO LESS THAN \$1,000,000.

NO SCALE

SITE

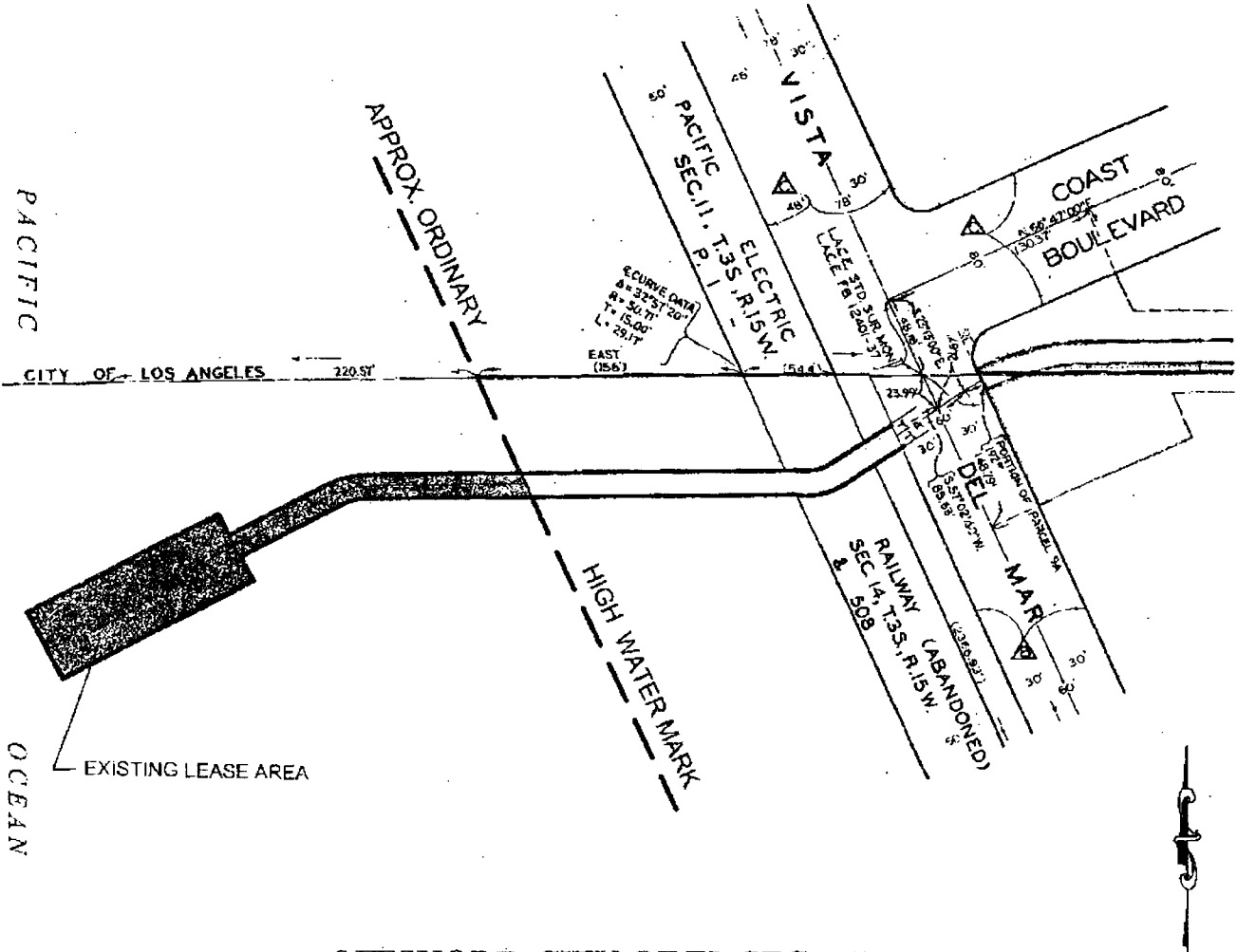

OFFSHORE, CITY OF EL SEGUNDO

NO SCALE

LOCATION

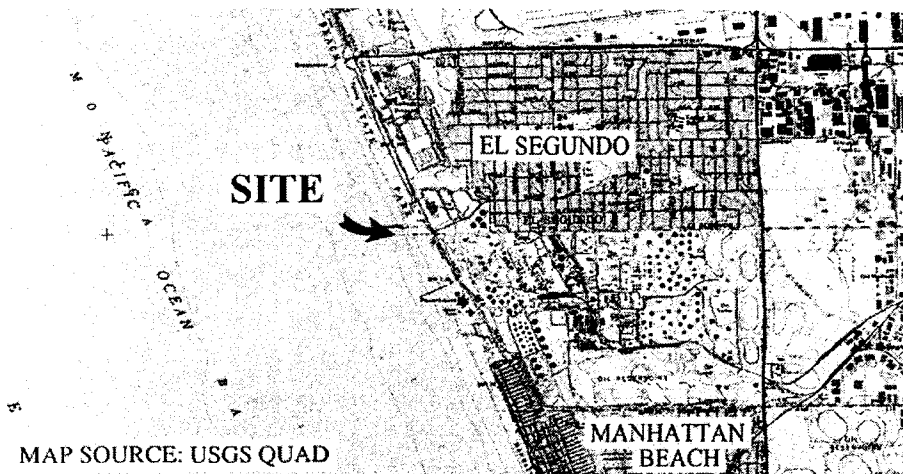

MAP SOURCE: USGS QUAD

**Exhibit A**

WP 4729  
 LOS ANGELES COUNTY  
 FLOOD CONTROL DISTRICT  
 GENERAL LEASE  
 PUBLIC AGENCY USE  
 LOS ANGELES CO.



**SITE**

MJ 1166

EXHIBIT "B"

LAND DESCRIPTION

PRC 4729.9

Those parcels of accreted beach land lying along the Pacific Ocean, in the City of El Segundo, County of Los Angeles, State of California, more particularly described as follows:

PARCEL "A"

A strip of land 14 feet wide, lying 7 feet on each side of the following described line:

COMMENCING at the intersection of the centerline of Vista Del Mar 60 feet wide as shown in the Los Angeles City Engineers Field Book 12401, page 37, on file in the Office of the Engineer of the City of Los Angeles, and the northerly line of Lot 2 Tract No. 1314 as shown on map filed in Book 20, page 161, of Maps, in the Office of the Recorder of the County of Los Angeles; thence S 23° 13' 00" E, 23.99 feet, along said centerline of said Vista Del Mar, to the TRUE POINT OF BEGINNING; thence S 57° 02' 40" W, 63.96 feet to the beginning of a tangent curve to the right, said curve having a radius of 50.71 feet through a central angle of 32° 57' 20", a distance of 29.17 feet; thence West 247.00 feet to the beginning of a tangent curve to the left, said curve having a radius of 95 feet through a central angle of 27° 00' 00", a distance of 44.77 feet; thence S 63° 00' 00" W, tangent to said curve, 53.00 feet to a point designated "A" for purposes of this description, and the end of the herein-described centerline.

PARCEL "B"

A strip of land 44 feet wide, lying 22 feet on each side of the following described line:

BEGINNING at the above-described Point "A"; thence S 63° 00' 00" W, 269.00 feet, and the end of the herein-described line.

EXCEPTING THEREFROM any portion lying landward of the ordinary high water mark of the Pacific Ocean.

END OF DESCRIPTION

REVIEWED NOVEMBER 23, 1987 BY BIU 1.

000244  
CALENDAR PAGE

002691  
MINUTE PAGE

72
2657