

MINUTE ITEM

This Calendar Item No. C34 was approved as Minute Item No. 34 by the California State Lands Commission by a vote of 3 to 0 at its 02-09-06 meeting.

**CALENDAR ITEM
C34**

A 5, 9
S 6

02/09/06
PRC 5720.1
T. Lipscomb

REVISION OF RENT

LESSEE:

Darlene A. Brock (Sole Trustee of the Trust of William L. and Darlene A. Brock)

AREA, LAND TYPE, AND LOCATION:

0.05 acres, more or less, of sovereign lands in the Sacramento River, near the city of Sacramento, Sacramento County.

AUTHORIZED USE:

Continued use and maintenance of an existing floating boat dock and walkway.

LEASE TERM:

Ten years, beginning August 5, 2001.

CONSIDERATION:

This lease provides that Lessor may modify the rent periodically during the lease term. Pursuant to this provision, staff has conducted a review of the rent under this lease, and recommends that the rent be revised from \$260 per year to \$312 per year, effective August 5, 2006. Lessee does not qualify for a rent-free lease for the boat dock and walk way, because the upland is not improved with a single family dwelling (Public Resources Code section 6503.5).

EXHIBIT:

A. Site and Location Map

RECOMMENDED ACTION:

IT IS RECOMMENDED THAT THE COMMISSION:

CEQA FINDING:

FIND THAT THE ACTIVITY IS NOT SUBJECT TO THE REQUIREMENTS OF THE CEQA PURSUANT TO TITLE 14, CALIFORNIA CODE OF REGULATIONS, SECTION 15060(c)(3) BECAUSE THE ACTIVITY IS NOT A PROJECT AS DEFINED BY

CALENDAR ITEM NO. **C34** (CONT'D)

PUBLIC RESOURCES CODE SECTION 21065 AND TITLE 14,
CALIFORNIA CODE OF REGULATIONS, SECTION 15378.

AUTHORIZATION:

APPROVE THE REVISION OF RENT FOR LEASE NO. PRC 5720.1
FROM \$260 PER YEAR TO \$312 PER YEAR, EFFECTIVE AUGUST 5,
2006.

Site Plan and Location Map

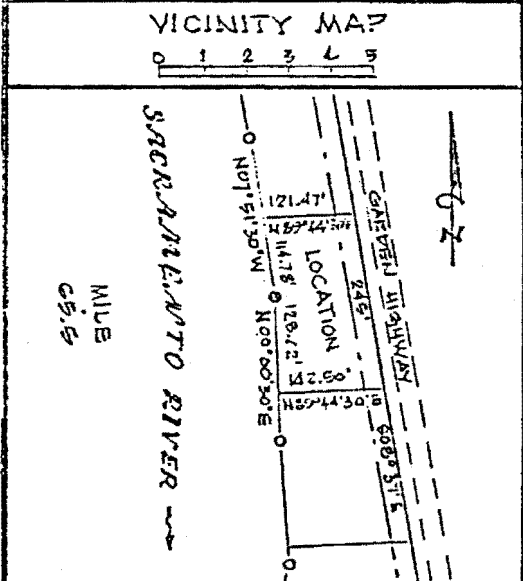
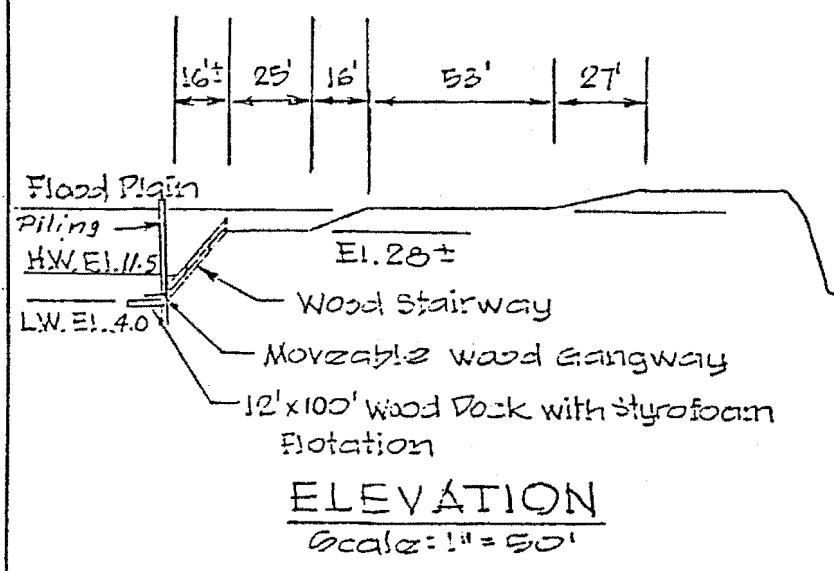
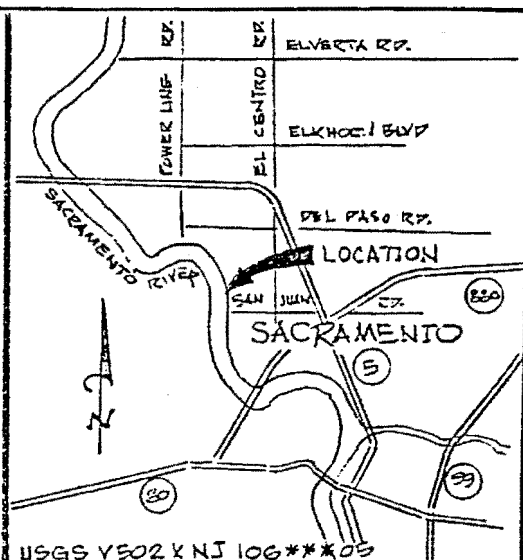
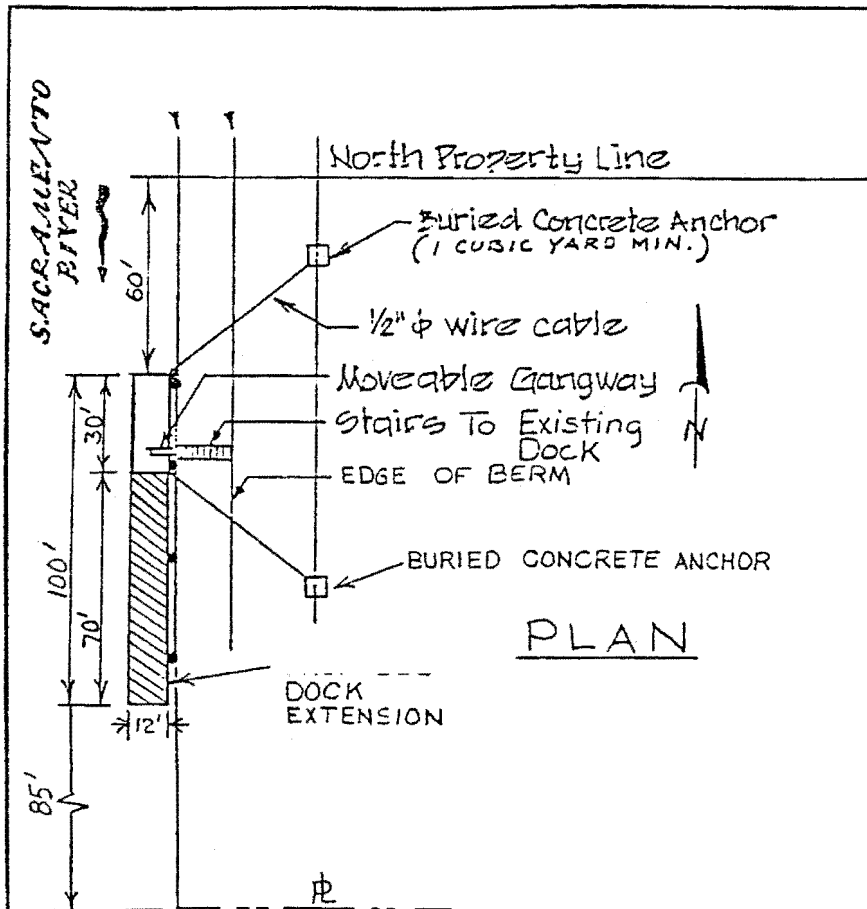

LOCATION: IN THE SACRAMENTO RIVER AT ASSESSOR'S PARCEL NO. 225-260-06 SACRAMENTO COUNTY, CALIFORNIA

APPLICATION BY:
DARLENE A. BROCK

This exhibit is solely for purposes of generally defining the lease premises, is based on unverified information provided by Lessee or other parties, and is not intended to be, nor shall it be construed as, a waiver or limitation of any state interest in the subject or other property.

**PRC 5720.1
Exhibit A**