

MINUTE ITEM

This Calendar Item No. C30 was approved as Minute Item No. 30 by the California State Lands Commission by a vote of 3 to 0 at its 11/27/00 meeting.

**CALENDAR ITEM
C30**

A 8
S 4

PRC 8222.9

11/27/00
W 25652
F. Singer

RECREATIONAL PIER LEASE

APPLICANT:

Stephen A. Finn
14000 State Highway 160
Walnut Grove, California 95690

AREA, LAND TYPE, AND LOCATION:

Sovereign lands in the Sacramento River, near Walnut Grove, Sacramento County.

AUTHORIZED USE:

Construction, use, and maintenance of a 30 foot by 60 foot floating boat dock and a 4 foot by 48 foot gangway.

LEASE TERM:

Ten years, beginning September 1, 2000.

CONSIDERATION:

No monetary consideration pursuant to Public Resources Code section 6503.5.

SPECIFIC LEASE PROVISIONS:

Insurance:

Liability insurance in the amount of no less than \$300,000.

OTHER PERTINENT INFORMATION:

1. Approval of this Item will allow Applicant to construct a new dock. Applicant is a natural person who has submitted an application for a Recreational Pier Lease. Applicant owns a parcel along the shore of the Sacramento River. The parcel is improved with a single-family dwelling. Applicant will construct and exclusively use a pier that extends onto sovereign lands.

CALENDAR PAGE	00175
MINUTE PAGE	0009754

CALENDAR ITEM NO. C30 (CONT'D)

2. Pursuant to the Commission's delegation of authority and the State CEQA Guidelines (Title 14, California Code of Regulations, section 15061), the staff has determined that this activity is exempt from the requirements of the CEQA as a categorically exempt project. The project is exempt under Class 3, New Construction of Small Structures; Title 2, California Code of Regulations, section 2905 (c)(1).

Authority: Public Resources Code section 21084 and Title 14, California Code of Regulations, section 15300 and Title 2, California Code of Regulations, section 2905.

3. This activity involves lands identified as possessing significant environmental values pursuant to Public Resources Code sections 6370, et seq. Based upon the staff's consultation with the persons nominating such lands and through the CEQA review process, it is the staff's opinion that the project, as proposed, is consistent with its use classification.

APPROVALS OBTAINED:

Reclamation District No. 3 and California Department of Fish and Game.

FURTHER APPROVALS REQUIRED:

US Army Corps of Engineers, Central Valley Regional Water Quality Control Board, and Reclamation Board.

EXHIBIT:

- A. Site and Location Map

PERMIT STREAMLINING ACT DEADLINE:

September 11, 2000

RECOMMENDED ACTION:

IT IS RECOMMENDED THAT THE COMMISSION:

CEQA FINDING:

FIND THAT THE ACTIVITY IS EXEMPT FROM THE REQUIREMENTS OF THE CEQA PURSUANT TO TITLE 14, CALIFORNIA CODE OF REGULATIONS, SECTION 15061 AS A CATEGORICALLY EXEMPT PROJECT, CLASS 3, NEW CONSTRUCTION OF SMALL STRUCTURES; TITLE 2, CALIFORNIA CODE OF REGULATIONS, SECTION 2905 (c)(1).

CALENDAR ITEM NO. **C30** (CONT'D)

SIGNIFICANT LANDS INVENTORY FINDING:

FIND THAT THIS ACTIVITY IS CONSISTENT WITH THE USE CLASSIFICATION DESIGNATED BY THE COMMISSION FOR THE LAND PURSUANT TO PUBLIC RESOURCES CODE SECTIONS 6370, ET SEQ.

RECREATIONAL PIER LEASE FINDING:

FIND THAT THE APPLICANT QUALIFIES FOR A RECREATIONAL PIER LEASE BECAUSE HE IS A NATRUAL PERSON WHO OWNS A LITTORAL PARCEL IMPROVED WITH A SINGLE-FAMILY DWELLING AND WILL CONSTRUCT, FOR HIS EXCLUSIVE, RECREATIONAL USE, A PIER THAT OCCUPPIES SOVEREIGN LANDS.

AUTHORIZATION:

AUTHORIZE ISSUANCE TO STEPHEN A. FINN OF A TEN-YEAR RECREATIONAL PIER LEASE, BEGINNING SEPTEMBER 1, 2000, FOR TEN YEARS ON THE LAND SHOWN ON EXHIBIT A ATTACHED AND BY THIS REFERENCE MADE A PART HEREOF; NO MONETARY CONSIDERATION PURSUANT TO PUBLIC RESOURCES CODE SECTION 6503.5; LIABILITY INSURANCE IN THE AMOUNT OF NO LESS THAN \$300,000.

CALENDAR PAGE	00177
MINUTE PAGE	0009756

NO SCALE

APN
142-0080-014

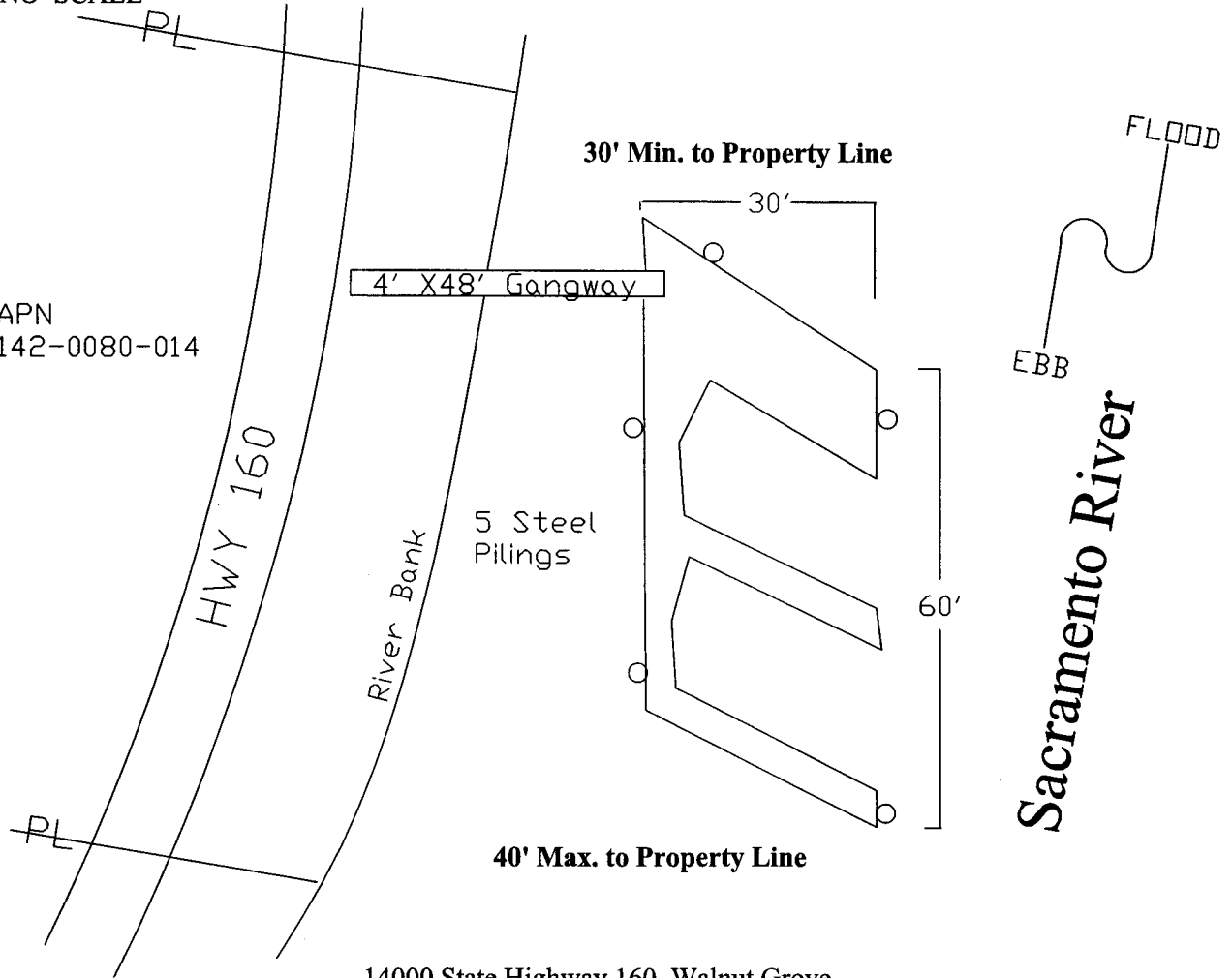

14000 State Highway 160, Walnut Grove

NO SCALE

LOCATION MAP

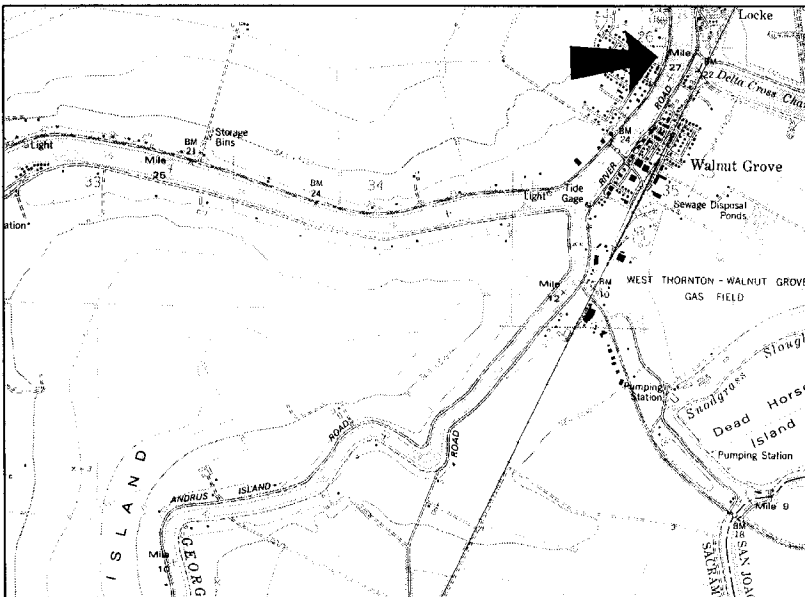

Exhibit A

W 25652

**Stephen Finn
RPL**

**Recreational pier
Walnut Grove
Sacramento County**



This Exhibit is solely for purposes of generally defining the lease premises, and is not intended to be, nor shall it be construed as, a waiver of limitation of any state interest in the subject or any other property.

CALENDAR PAGE	00178
MINUTE PAGE	9757