

MINUTE ITEM

This Calendar Item No. C64 was approved as
Minute Item No. C64 by the California State Lands
Commission by a vote of 13 to 0 at its
4/13/99 meeting.

**CALENDAR ITEM
C64**

A 11

04/13/99

PRC 8073

W 6005.70

S 7

A. Nitsche

**CONSIDER APPROVAL OF A NON-EXCLUSIVE GEOPHYSICAL
SURVEY PERMIT ON TIDE AND SUBMERGED LANDS UNDER THE
JURISDICTION OF THE CALIFORNIA STATE LANDS COMMISSION**

APPLICANT:

Slawson Exploration Company, Inc.
Attn.: Mr. Bruce Branson
1625 Broadway, Suite 1450
Denver, Colorado 80202

AREA, LAND TYPE AND LOCATION:

The proposed geophysical survey will cover approximately 35 square miles in the Kirby Hills/Potrero Hills area in Solano county. The proposed project area includes State tide and submerged lands including the Montezuma Slough and Little Honker Bay.

TERMS OF PROPOSED PERMIT:

Beginning May 1, 1999 through April 30, 2000.

PREREQUISITE CONDITIONS, FEES AND EXPENSES:

Required fees, expense deposit, and other security have been received. The applicant has been notified that the California Department of Fish and Game fee of \$1,250 is due pursuant to Section 711.4 of the Fish and Game Code.

PROPOSED SURVEY:

The geophysical survey will be conducted by establishing a temporary grid of 12,157 seismic detectors on 58 parallel receiver lines. The detectors, called geophones, will be connected to the receiver lines which will be connected to recording instruments. The receiver lines will average four miles in length and will be spaced 560 feet apart, progressing east/west. The combined length of the receiver lines is approximately 322 miles. Crossing the receiver lines will be "source lines". Shot holes for seismic source will be drilled conventionally in the upland areas and will utilize Vibra-Ram technology in the waterways. The Vibra-

CALENDAR PAGE	000306
MINUTE PAGE	005360

CALENDAR ITEM NO. C64 (CONT'D)

Ram device is a hydraulically operated, mechanically driven unit which will insert a seismic charge into the substrate and the cap wire. The hole closes (or collapses) upon withdrawal of the unit, creating a fully buried charge. Use of such method requires that the charge be no more than three pounds of dynamite or its equivalent, and that burial is at least 20 feet below the surface. This burial device utilizes no drilling mud or drilling fluids. Source lines will be located perpendicular to receiver lines at 840 foot intervals. The proposed project will include approximately 40 source lines, most lines will have approximately 200 shot holes per line. The shot holes will be spaced 140 feet apart. In all, 8,500 shot holes will be located on land and waterways.

STATUTORY AND OTHER REFERENCES:

- A. Public Resources Code section 6826.
- B. Public Resources Code section 21080(c).
- C. Public Resources Code section 6870.
- D. California Code of Regulations, section Title 2, Article 2.9, 2100.
- E. California Code of Regulations, section Title 2, 2905(e)(3).
- F. California Code of Regulations, section Title 14, 15074.

PERMIT STREAMLINING ACT DEADLINE:

July 1, 1999.

OTHER PERTINENT INFORMATION:

1. Pursuant to the Commission's delegation of authority and the State CEQA Guidelines (Title 14, California Code of Regulations, section 15025), Commission staff has prepared a Proposed Mitigated Negative Declaration identified as 690, State Clearinghouse No. 99022075). Such Proposed Mitigated Negative Declaration was prepared and circulated for public review pursuant to the provisions of the CEQA.

Based on the Initial Study, the Proposed Mitigated Negative Declaration, and the comments received in response thereto, there is no substantial evidence that the project will have a significant effect on the environment; Title 14, California Code of Regulations, section 15074(b).

2. A Mitigation Monitoring Program has been prepared in conformity with the provisions of the CEQA (Public Resources Code section 21081.6).

CALENDAR ITEM NO. C64 (CONT'D)

3. This activity involves lands identified as possessing significant environmental values pursuant to Public Resources Code section 6370, et. seq. Based upon the staff's consultation with the persons nominating such lands and through the CEQA review process, it is the staff's opinion that the permit, as part of the program for the project as proposed, is consistent with its use classification.

EXHIBITS:

- A. Survey Area
- B. Location Map

RECOMMENDED ACTION:

IT IS RECOMMENDED THAT THE COMMISSION:

CEQA FINDINGS:

1. CERTIFY THAT A PROPOSED MITIGATED NEGATIVE DECLARATION, CSLC 690, STATE CLEARINGHOUSE NO. 99022075, WAS PREPARED FOR THIS PROJECT PURSUANT TO THE PROVISIONS OF THE CEQA, AND THAT THE COMMISSION HAS REVIEWED AND CONSIDERED THE INFORMATION CONTAINED THEREIN.
2. ADOPT THE PROPOSED MITIGATED NEGATIVE DECLARATION AND DETERMINE THAT THE PROJECT, AS APPROVED, WILL NOT HAVE A SIGNIFICANT EFFECT ON THE ENVIRONMENT.
3. ADOPT THE MITIGATION MONITORING PROGRAM, AS CONTAINED ON FILE IN THE OFFICES OF THE CALIFORNIA STATE LANDS COMMISSION.
4. FIND THAT THIS ACTIVITY IS CONSISTENT WITH THE USE CLASSIFICATION DESIGNATED BY THE COMMISSION FOR THE LAND PURSUANT TO PUBLIC RESOURCES CODE SECTIONS 6370, ET. SEQ.

CALENDAR ITEM NO. C64 (CONT'D)

AUTHORIZATION:

AUTHORIZE ISSUANCE TO SLAWSON EXPLORATION COMPANY, INC., OF A NON-EXCLUSIVE GENERAL PERMIT TO CONDUCT GEOPHYSICAL SURVEYS FOR THE PERIOD MAY 1, 1999 THROUGH APRIL 30, 2000, USING THE VIBRA-RAM METHOD OF BURYING SEISMIC CHARGES AND RECEIVERS, ON TIDE AND SUBMERGED LANDS UNDER THE JURISDICTION OF THE COMMISSION WITHIN THE PERMIT AREA DESIGNATED ON EXHIBIT B.

Prospect: Petrero Hills 3D
 Design: N/C - w/east and west exten.
 Client: Dawson Exploration Company
 Area: Solano County, California

2010000 2015000 2020000 2025000 2030000 2035000 2040000

 Patch Description
 10 Lines of 120 Channels
 2-Way Brick

SLI = 848 ft RLI = 568 ft
 SPI = 148 ft RPI = 148 ft

 Description: Kirby Hills Quadrangle

Cell Size:
 70.0 x 70.0 ft
 Binning Method: CMP

- ✕ Source
- + Detector
- Kirby Hills Bndy
- White Border

EXHIBIT A

W6005.70

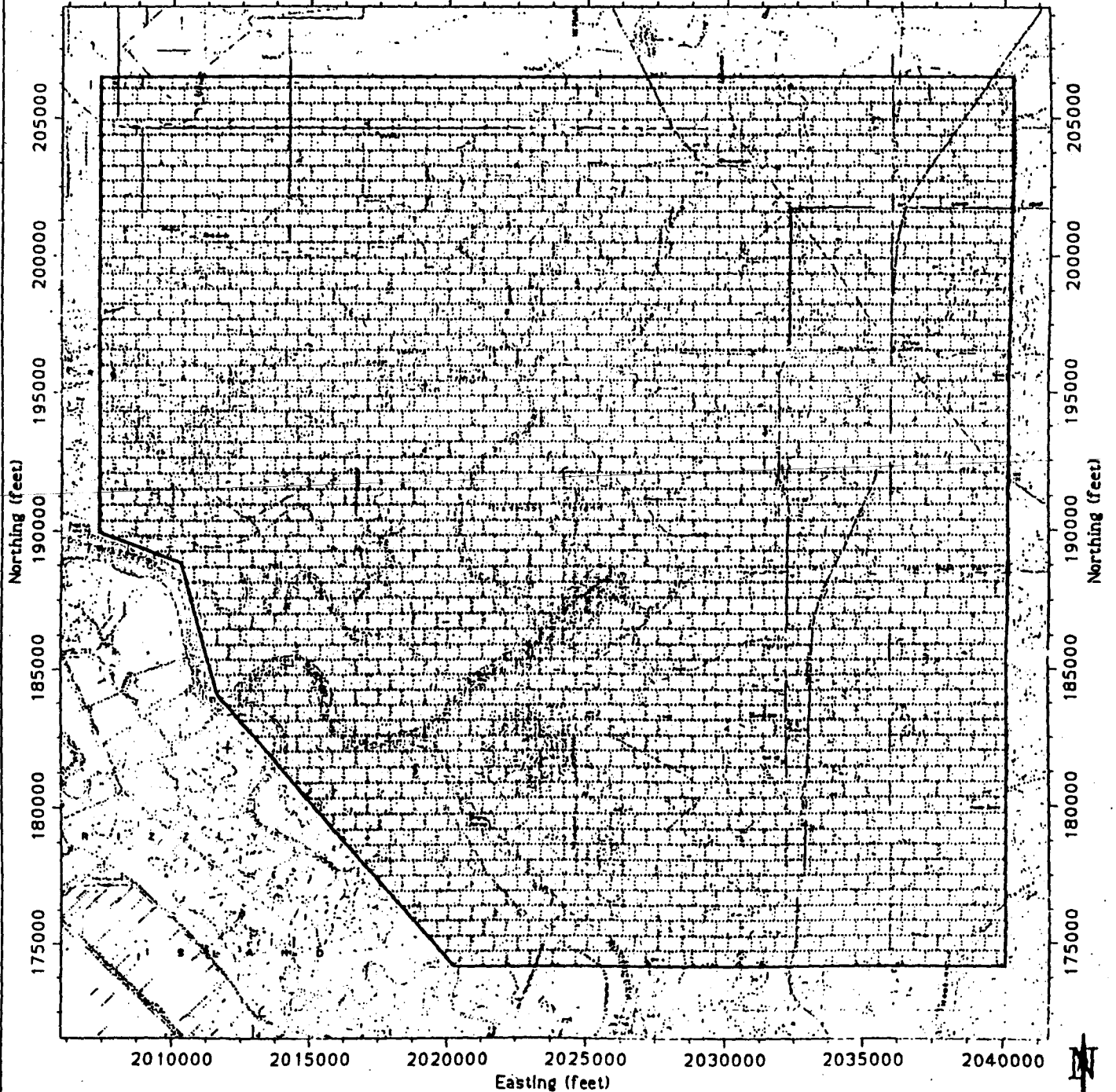

Figure 1-2. Project Map

MINDTE PAGE 005204
 CALNDAR PAGE 000910

Design Compliments of
BAKER HUGHES

ical

EXHIBIT B

W6005.70

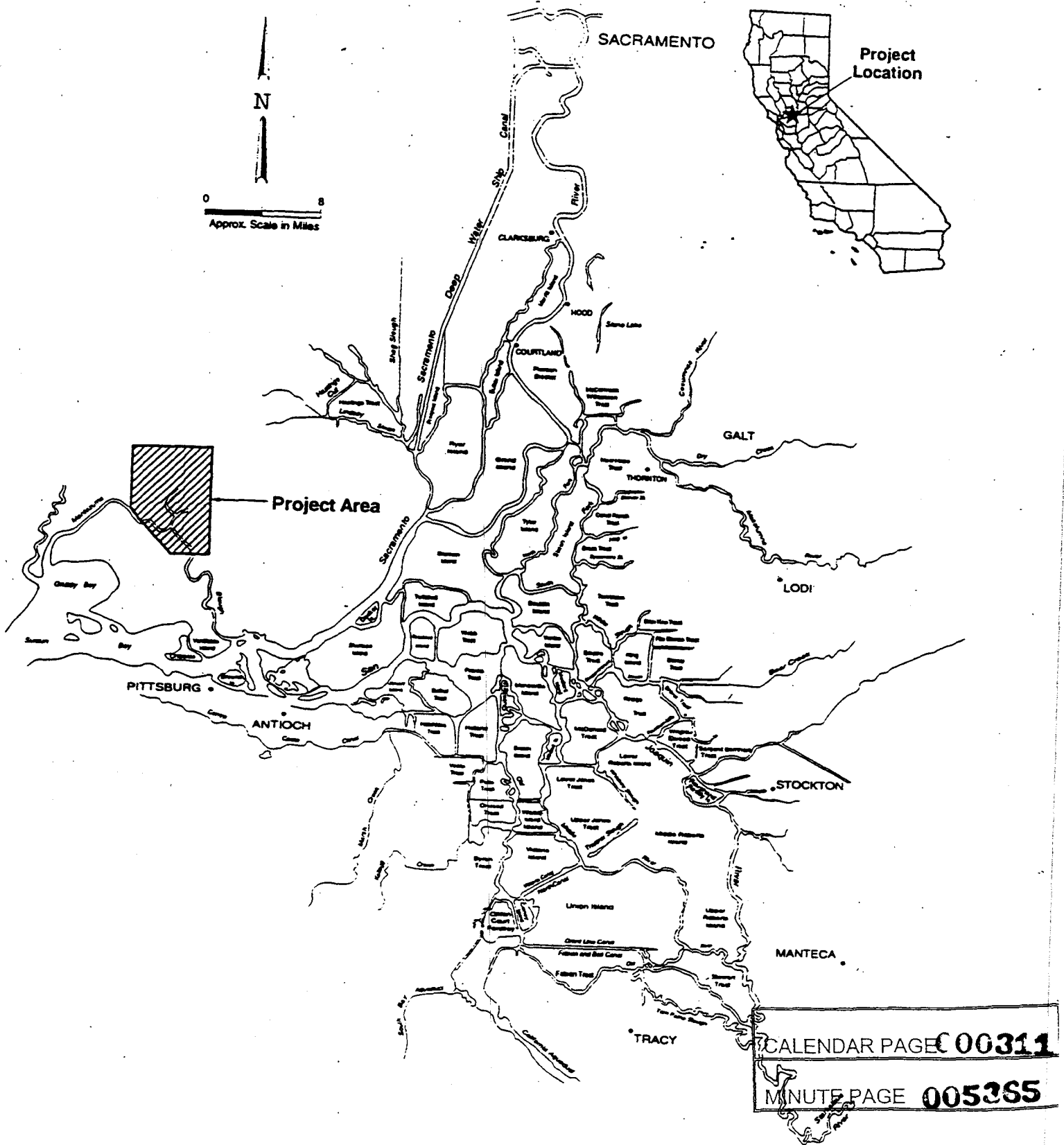

CALENDAR PAGE 00311
MINUTE PAGE 005365