

**CALENDAR ITEM
C37**

MINUTE ITEM
This Calendar Item No. **C37**
was approved as Minute Item
No. **37** by the State Lands
Commission by a vote of **3**
to **0** at its **10-17-95**
meeting.

A 4

S 1

10/17/95
PRC 7167.9
J. Ludlow

RECREATIONAL PIER LEASE

APPLICANT:

James R. Barrow and Marjorie A. Barrow
865 Portola Road
Portola Valley, California 94028

LOCATION:

Bed of Lake Tahoe at Carnelian Bay.

EXHIBIT:

A. Site Map

AB 884:

N/A

RECOMMENDED ACTION:

IT IS RECOMMENDED THAT THE COMMISSION:

CEQA

FINDING:

FIND THAT THE ACTIVITY IS EXEMPT FROM THE REQUIREMENTS OF THE
CEQA PURSUANT TO 14 CAL. CODE REGS. 15061, AS A CATEGORICALLY
EXEMPT PROJECT, CLASS 1, EXISTING FACILITIES, 2 CAL. CODE REGS.
2905(a)(2).

SIGNIFICANT LANDS

INVENTORY FINDING:

FIND THAT THIS ACTIVITY IS CONSISTENT WITH THE USE CLASSIFICATION
DESIGNATED FOR THE LAND PURSUANT TO PUBLIC RESOURCES CODE
SECTION 6370, ET SEQ.

AUTHORIZATION:

AUTHORIZE ISSUANCE TO JAMES R. BARROW AND MARJORIE BARROW OF A
TEN YEAR RECREATIONAL PIER LEASE ON FILE IN THE COMMISSION'S
OFFICES FOR ALL OF THE STATE'S SOVEREIGN LANDS BELOW THE
ELEVATION OF 6223 FEET LTD UNDER APPLICANT'S PIER AS DEPICTED ON
EXHIBIT "A" ATTACHED AND BY REFERENCE MADE A PART HEREOF,
BEGINNING SEPTEMBER 1, 1995; NO CONSIDERATION PURSUANT TO PUBLIC
RESOURCES CODE SECTION 6503.5.

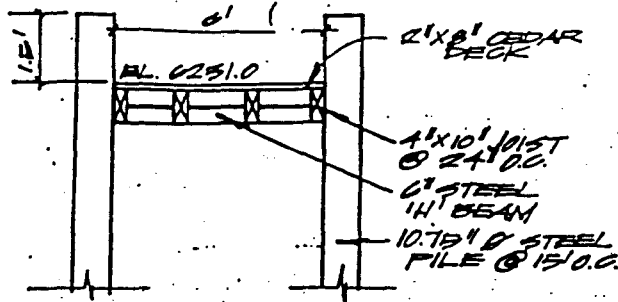

WALKWAY SECTION

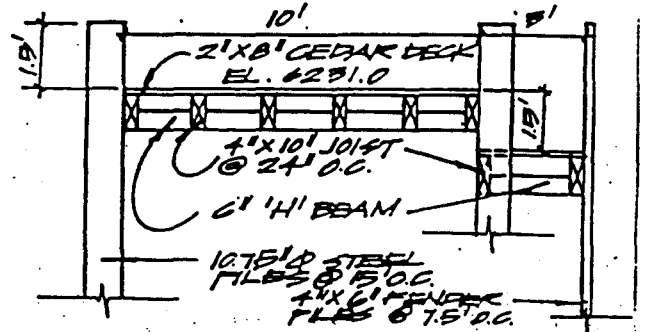

PIERHEAD SECTION

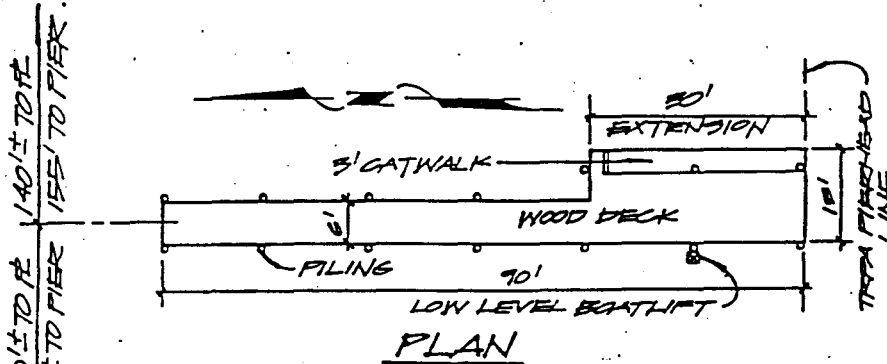

PLAN

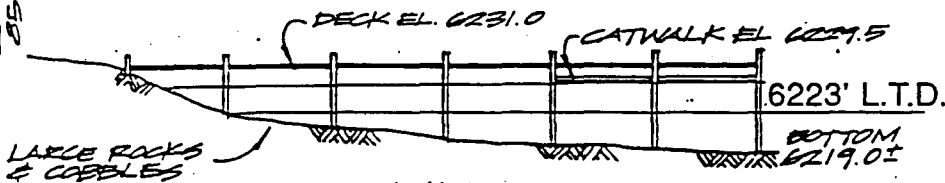

PROFILE

5340 N. LAKE BLVD.

NO SCALE

Lake Tahoe

LOCATION MAP

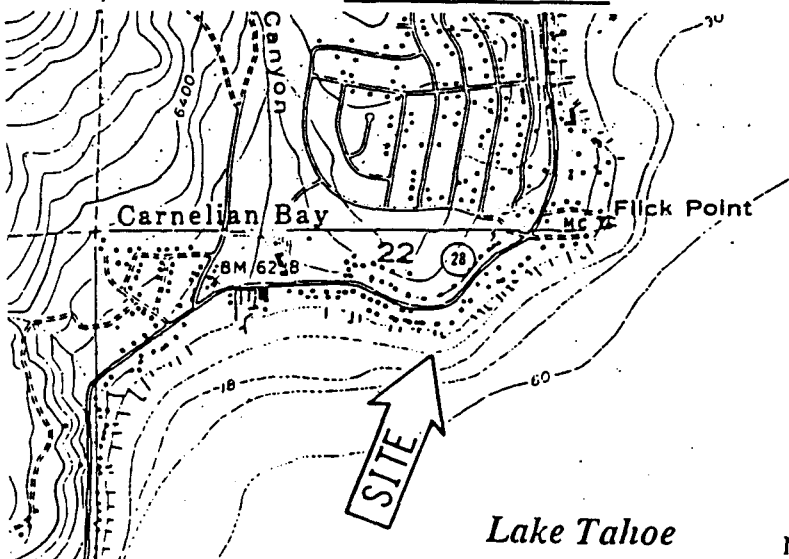

Lake Tahoe

NO SCALE

This Exhibit is solely for purposes of generally defining the lease premises, and is not intended to be, nor shall it be construed as, a waiver or limitation of any State interest in the subject or any other property.

EXHIBIT "A"

PRC 7167.9

APN 115 - 020 - 002

Lake Tahoe

PLACER COUNTY

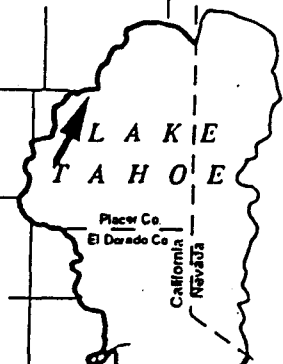

CALENDAR PAGE 128

MINUTE PAGE 1965 CG 295