

**MINUTE ITEM**  
This Calendar Item No. C07  
was approved as Minute Item  
No. 07 by the State Lands  
Commission by a vote of 3  
to 0 at its 10/17/95  
meeting. 8

**CALENDAR ITEM**  
**C07**

10/17/95  
PRC 6740 WP 6740  
Burks

-S 4

**TERMINATION OF GENERAL PERMIT - RECREATIONAL USE (PRC 7000)  
AND REISSUANCE OF RECREATIONAL PIER LEASE (PRC 6740)**

**APPLICANT:**

Susan D. Luque  
P. O. Box 503  
Lockeford, California 95237

**LOCATION:**

Tide and submerged land located in the Sacramento River, portion of Grand Island (APN 142-0110-067), Sacramento County.

**EXHIBITS:**

A. Site Map B. Location Map

**AB 884:**

N/A

**RECOMMENDED ACTION:**

IT IS RECOMMENDED THAT THE COMMISSION:

**CEQA FINDINGS:**

AS TO THE TERMINATION OF GENERAL PERMIT - RECREATIONAL USE (PRC 7000) FIND THAT THE ACTIVITY IS EXEMPT FROM THE REQUIREMENTS OF THE CEQA PURSUANT TO 14 CAL. CODE REGS. 15061 BECAUSE THE ACTIVITY IS NOT A PROJECT AS DEFINED BY PUBLIC RESOURCES CODE SECTION 21065 AND 14 CAL. CODE REGS. 15378.

AS TO THE REISSUANCE OF RECREATIONAL PIER LEASE (PRC 6740) FIND THAT THE ACTIVITY IS EXEMPT FROM THE REQUIREMENTS OF THE CEQA PURSUANT TO 14 CAL. CODE REGS. 15061 AS A CATEGORICALLY EXEMPT PROJECT, CLASS 1, 2 CAL. CODE REGS. 2905 (a)(2).

**SIGNIFICANT LANDS**

**INVENTORY FINDING:**

FIND THAT THIS ACTIVITY IS CONSISTENT WITH THE USE CLASSIFICATION DESIGNATED FOR THE LAND PURSUANT TO PUBLIC RESOURCES CODE SECTION 6370, ET SEQ.

CALENDAR ITEM NO. C07 (CONT'D)

**AUTHORIZATION:**

AUTHORIZE TERMINATION OF FIFTEEN (15) YEAR GENERAL PERMIT - RECREATIONAL USE (PRC 7000), EFFECTIVE JUNE 1, 1989, FOR MAINTENANCE OF TWO SPEED CONTROL BUOYS IN THE SACRAMENTO RIVER AT THE SUBJECT PROPERTY.

AUTHORIZE ISSUANCE TO SUSAN D. LUQUE OF A TEN (10) YEAR RECREATIONAL PIER LEASE, BEGINNING OCTOBER 13, 1994; NO MONETARY CONSIDERATION PURSUANT TO SECTION 6503.5 OF THE PUBLIC RESOURCES CODE FOR CONTINUED USE AND MAINTENANCE OF AN EXISTING 23 FT. X 51 FT. COVERED FLOATING DOCK WITH RAMP; ON THE LAND DESCRIBED ON EXHIBIT "A" ATTACHED AND BY REFERENCE MADE A PART HEREOF.

Area to be leased lies directly beneath dock and walkway, plus a necessary use area 10 feet in width around the entire dock and walkway. Excepting therefrom any portion lying above the ordinary high water mark.

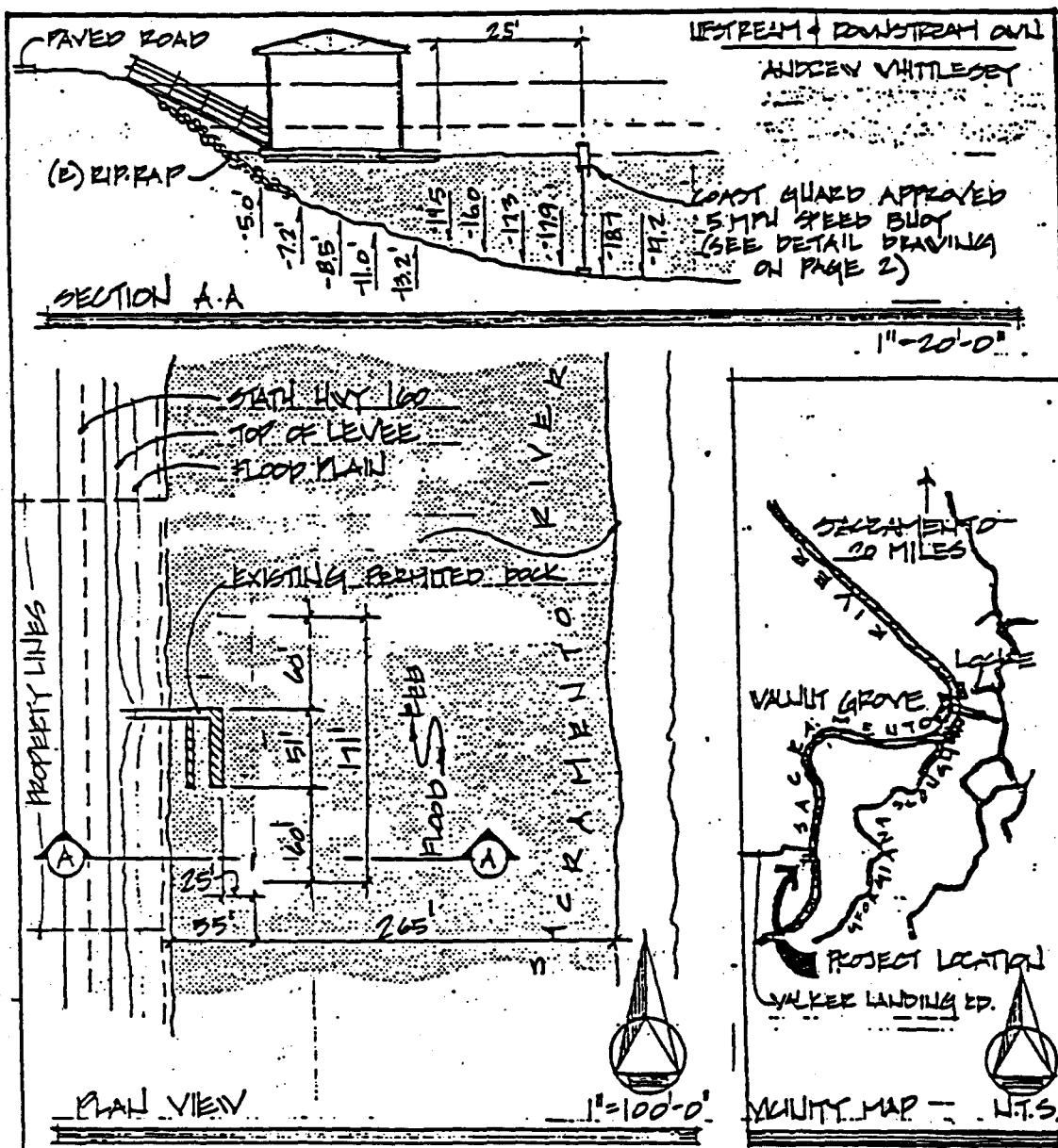

AUTHORIZED AGENT:  
 GILBERT LABRIE & ASSOC.  
 P.O. BOX 183  
 VALLEY GROVE, CA. 95640  
 (916) 776-1161  
 DR BY ALPHEUSMAN 3 SEPT 85

PROPOSED SPEED BUOYS

IN: SACRAMENTO RIVER  
 SACRAMENTO COUNTY, APR. 14, 1984

FOR: AL JORDAN (415) 351-1160  
 RT. 1 BOX 12  
 VALLEY GROVE, CA. 95640

1A-2

This exhibit is solely for purposes of generally defining the lease premises, and is not intended to be, nor shall it be construed as, a waiver or limitation of any State interest in the subject or any other property.

EXHIBIT "A"  
 CALENDAR PAGE 6746  
 24  
 841

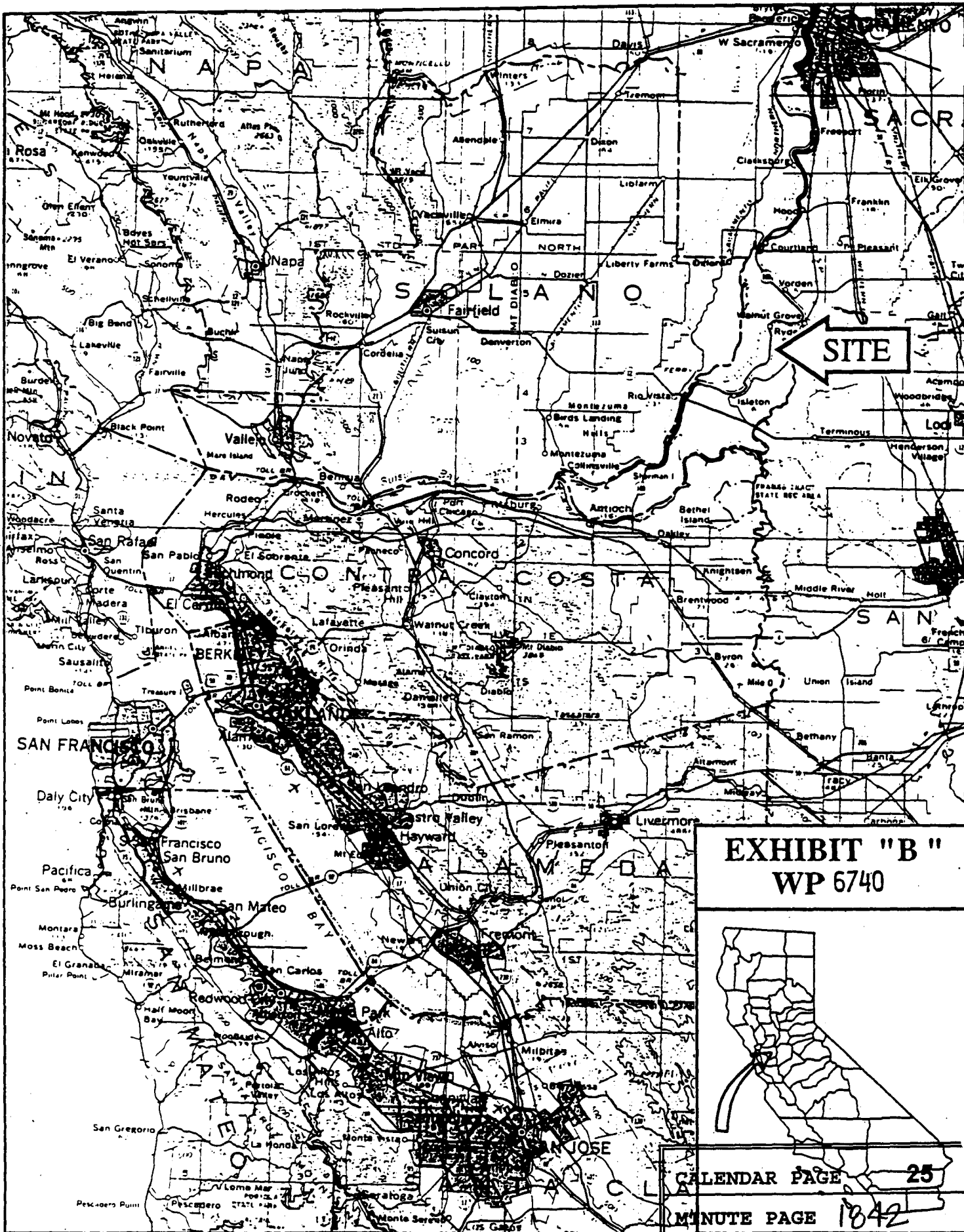

EXHIBIT "B"  
WP 6740



CALENDAR PAGE 25

MINUTE PAGE 1842