

CALENDAR ITEM
C38

MINUTE ITEM
This Calendar Item No. C38
was approved as Minute Item
No. 38 by the State Land
Commission by a vote of 3
to 0 at its 7/6/95
meeting.

A 4

07/06/95

S 1

PRC 4857.9

J. Ludlow

RECREATIONAL PIER LEASE

PARTY:

Pat F. Rice and Vera M. Rice
623 Country Club Avenue
Marysville, California 95901

LOCATION:

A parcel of submerged land located in the bed of Lake Tahoe
at Carnelian Bay, Placer County.

EXHIBIT:

A. Vicinity and Site Map

AB 884:

11/01/95

OTHER PERTINENT
INFORMATION:

1. This lease authorizes the reconstruction of the existing pier and the continued use and maintenance of one existing mooring buoy.
2. The lease is conditioned on Lessee's obtaining authorization from the Tahoe Regional Planning Agency for the existing buoy within two years of the effective date of the lease.

RECOMMENDED ACTION:

IT IS RECOMMENDED THAT THE COMMISSION:

CEQA FINDING:

(Pier)

FIND THAT THE ACTIVITY IS EXEMPT FROM THE REQUIREMENTS OF THE CEQA PURSUANT TO 14 CAL. CODE REGS. 15061 AS A CATEGORICALLY EXEMPT PROJECT, CLASS 2, REPLACEMENT OR RECONSTRUCTION, 2 CAL. CODE REGS. 2905 (b).

CEQA FINDING:

(Buoy)

FIND THAT THE ACTIVITY IS EXEMPT FROM THE REQUIREMENTS OF THE CEQA PURSUANT TO 14 CAL. CODE REGS. 15061 AS A CATEGORICALLY EXEMPT PROJECT, CLASS 1, EXISTING FACILITIES, 2 CAL. CODE REGS. 2905 (a) (2).

SIGNIFICANT LANDS

INVENTORY FINDING:

FIND THAT THIS ACTIVITY IS CONSISTENT WITH THE USE CLASSIFICATION DESIGNATED FOR THE LAND PURSUANT TO P.R.C. 6370, ET SEQ.

AUTHORIZATION:

AUTHORIZE ISSUANCE TO PAT F. RICE AND VERA M. RICE OF A TEN-YEAR RECREATIONAL PIER LEASE ON FILE IN THE COMMISSION'S OFFICES FOR ALL OF THE STATE'S SOVEREIGN LANDS BELOW THE ELEVATION OF 6223 FEET, LAKE TAHOE DATUM, UNDER APPLICANT'S PIER AND BUOY AS DEPICTED ON EXHIBIT "A" ATTACHED AND BY REFERENCE MADE A PART HEREOF, BEGINNING JULY 1, 1995; NO MONETARY CONSIDERATION PURSUANT TO SECTION 6503.5. OF THE P.R.C.

CALENDAR PAGE	236
MINUTE PAGE	1120

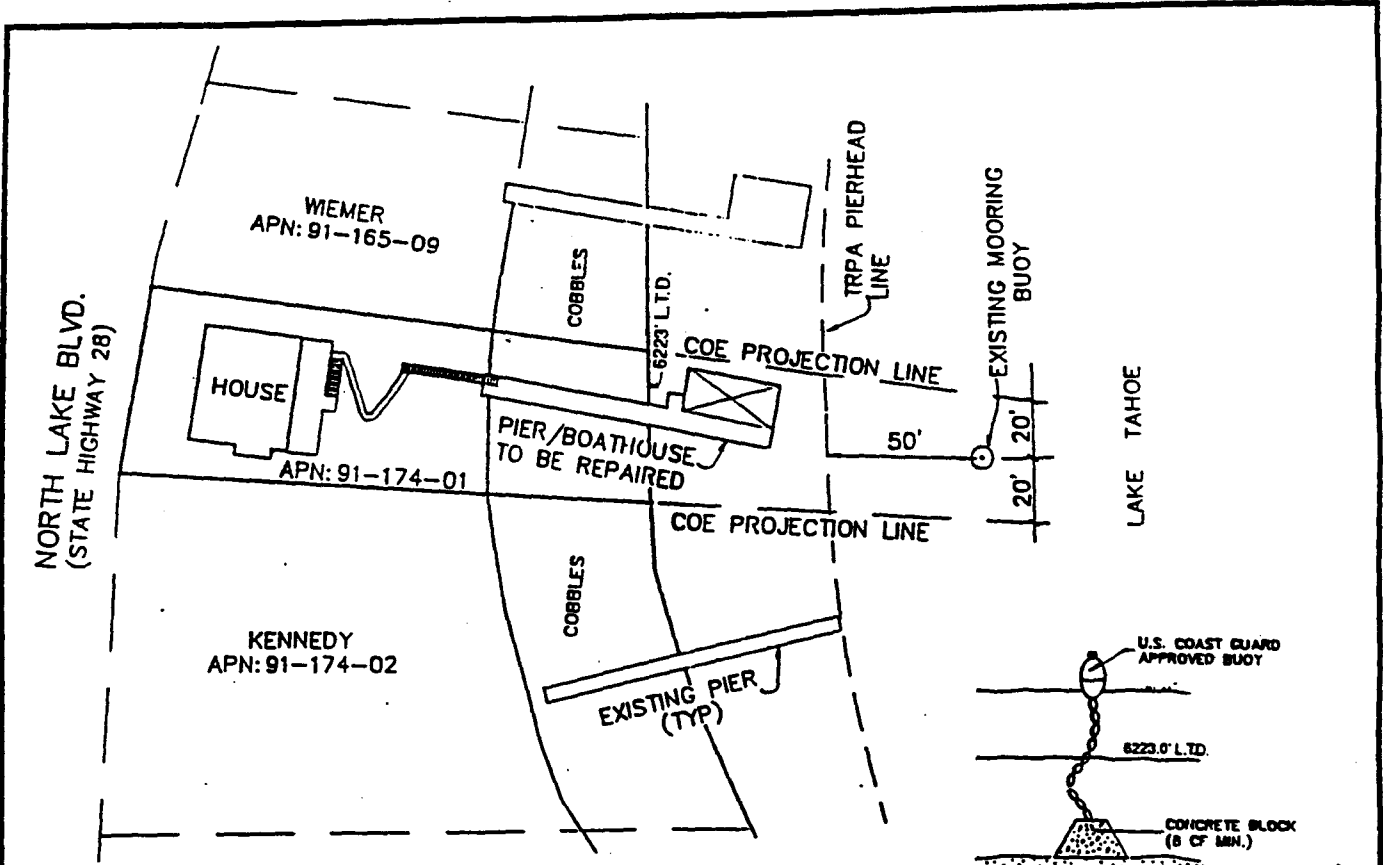

NOTE:

THIS DOCUMENT IS FOR PERMIT PURPOSES ONLY AND SHALL NOT BE USED AS A CONSTRUCTION DRAWING. THE CONSTRUCTION ACTIVITY ASSOCIATED WITH THIS PROJECT SHALL COMPLY WITH THE APPLICABLE AGENCY CODES, REGULATIONS, AND STANDARDS.

4480 North Lake Blvd.

NO SCALE

LOCATION MAP

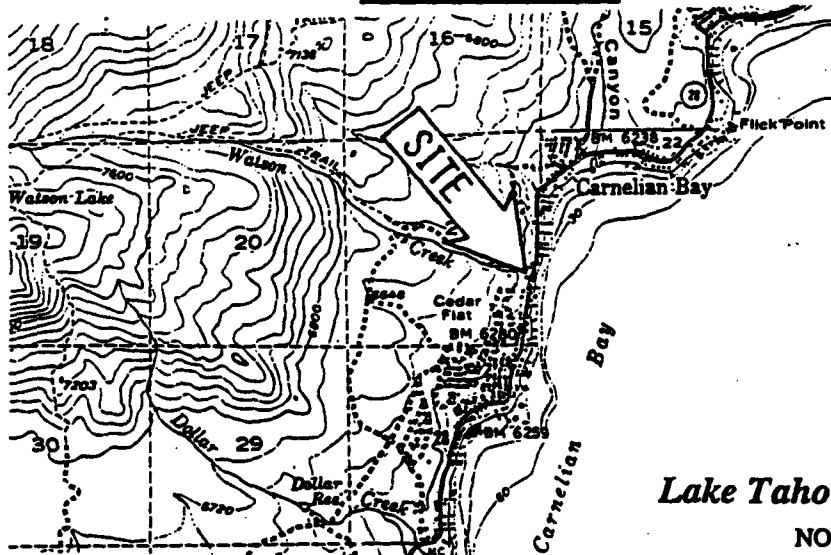

EXHIBIT "A"

PRC 4857.9

APN 91 - 174 - 01

Lake Tahoe

PLACER COUNTY

Sheet 1 of 2 Sheets

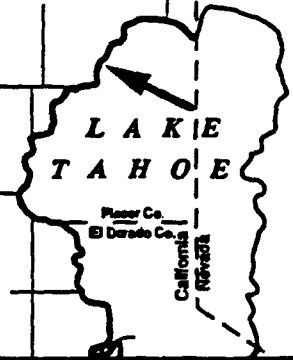

This Exhibit is solely for purposes of generally defining the lease premises, and is not intended to be, nor shall it be construed as, a waiver or limitation of any State interest in the subject or any other property.

CALENDAR PAGE

237

MINUTE PAGE

CG 6/95

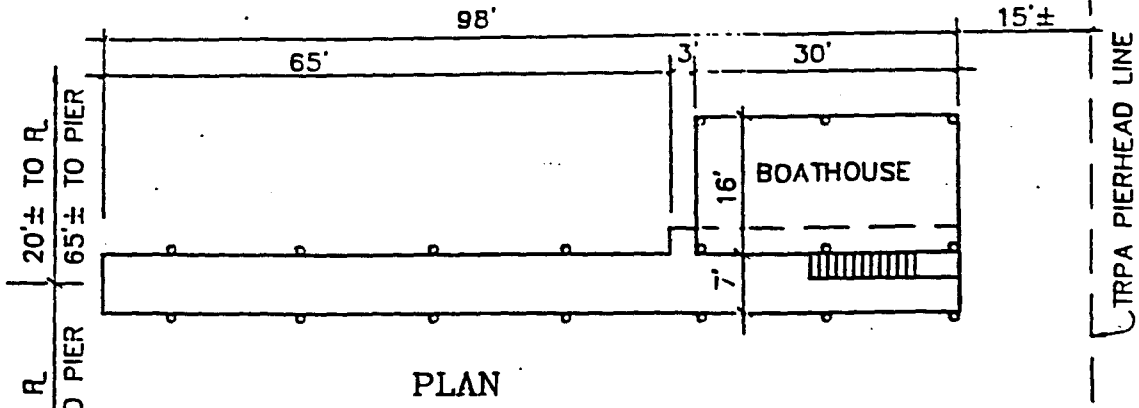

PLAN

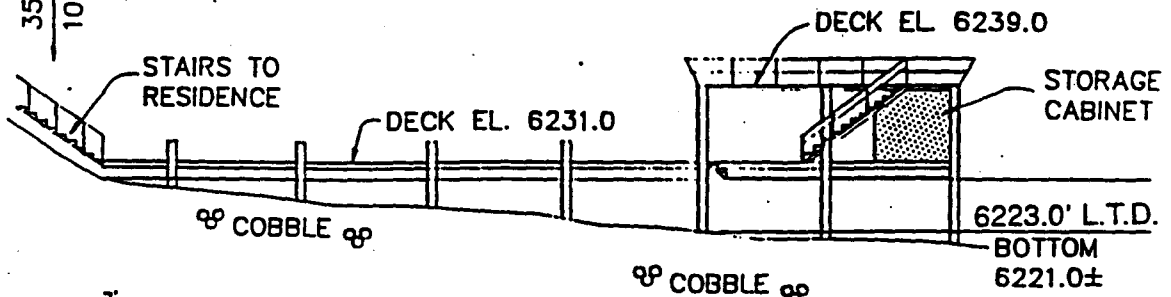

PROFILE

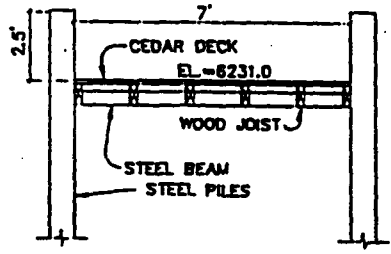

WALKWAY SECTION
N.T.S.

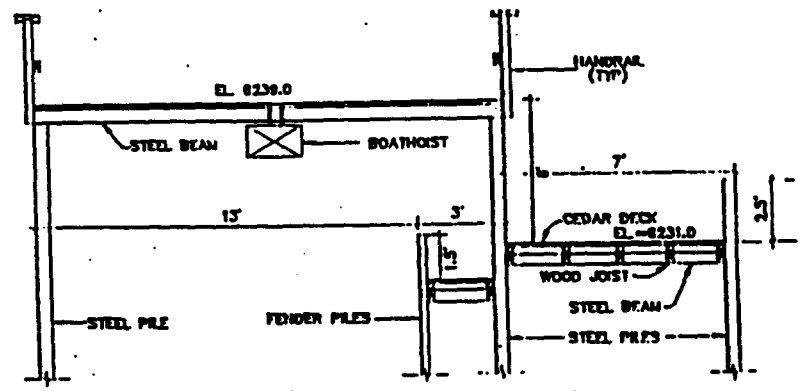

PIERHEAD/BOATHOUSE SECTION
N.T.S.

NO SCALE

EXHIBIT "A"
 PRC 4857.9
 APN 91 - 174 - 01
 Lake Tahoe
 PLACER COUNTY
 Sheet 2 of 2 Sheets

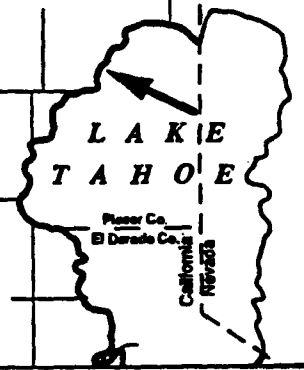

This Exhibit is solely for purposes of generally defining the lease premises, and is not intended to be, nor shall it be construed as, a waiver or limitation of any State interest in the subject or any other property.

CALENDAR PAGE 238
 MINUTE PAGE 1121

NO CALENDAR PAGES 239 _____ 241

CALENDAR PAGE _____
MINUTE PAGE <u>1122</u>