

MINUTE ITEM

This Calendar Item No. C37  
was approved as Minute Item  
No. 37 by the State Land  
Commission by a vote of 3  
to 0 at its 7/6/95  
meeting.

PRC 4994.9  
J. Ludlow

07/06/95

CALENDAR ITEM

C37

A 4

S 1

RECREATIONAL PIER LEASE

**PARTY:**

Dennis C. Pulos and Julie J. Pulos, Trustees  
1345 Easy Lane  
El Dorado Hills, California 95762

**LOCATION:**

A parcel of submerged land located in the bed of Lake Tahoe  
at Carnelian Bay, Placer County.

**EXHIBIT:**

A. Vicinity and Site Map

**AB 884:**

N/A

**OTHER PERTINENT INFORMATION:**

The lease is conditioned on lessee's obtaining authorization  
from the Tahoe Regional Planning Agency for the existing  
buoy within two years of the effective date of the lease.

**RECOMMENDED ACTION:**

IT IS RECOMMENDED THAT THE COMMISSION:

**CEQA FINDING:**

FIND THAT THE ACTIVITY IS EXEMPT FROM THE REQUIREMENTS OF  
THE CEQA PURSUANT TO 14 CAL. CODE REGS. 15061 AS A  
CATEGORICALLY EXEMPT PROJECT, CLASS 1, EXISTING FACILITIES,  
2 CAL. CODE REGS. 2905 (a) (2).

**SIGNIFICANT LANDS**

**INVENTORY FINDING:**

FIND THAT THIS ACTIVITY IS CONSISTENT WITH THE USE  
CLASSIFICATION DESIGNATED FOR THE LAND PURSUANT TO P.R.C.  
6370, ET SEQ.

**AUTHORIZATION:**

AUTHORIZE ISSUANCE TO DENNIS C. PULOS AND JULIE J. PULOS,  
TRUSTEES, OF A TEN-YEAR RECREATIONAL PIER LEASE ON FILE IN  
THE COMMISSION'S OFFICES FOR ALL OF THE STATE'S SOVEREIGN  
LANDS BELOW THE ELEVATION OF 6223 FEET LTD UNDER APPLICANT'S  
PIER AND BUOY AS DEPICTED ON EXHIBIT "A" ATTACHED AND BY  
REFERENCE MADE A PART HEREOF, BEGINNING JUNE 17, 1994; NO  
MONETARY CONSIDERATION PURSUANT TO P.R.C. SECTION 6503.5.

CALENDAR PAGE	233
MINUTE PAGE	1117

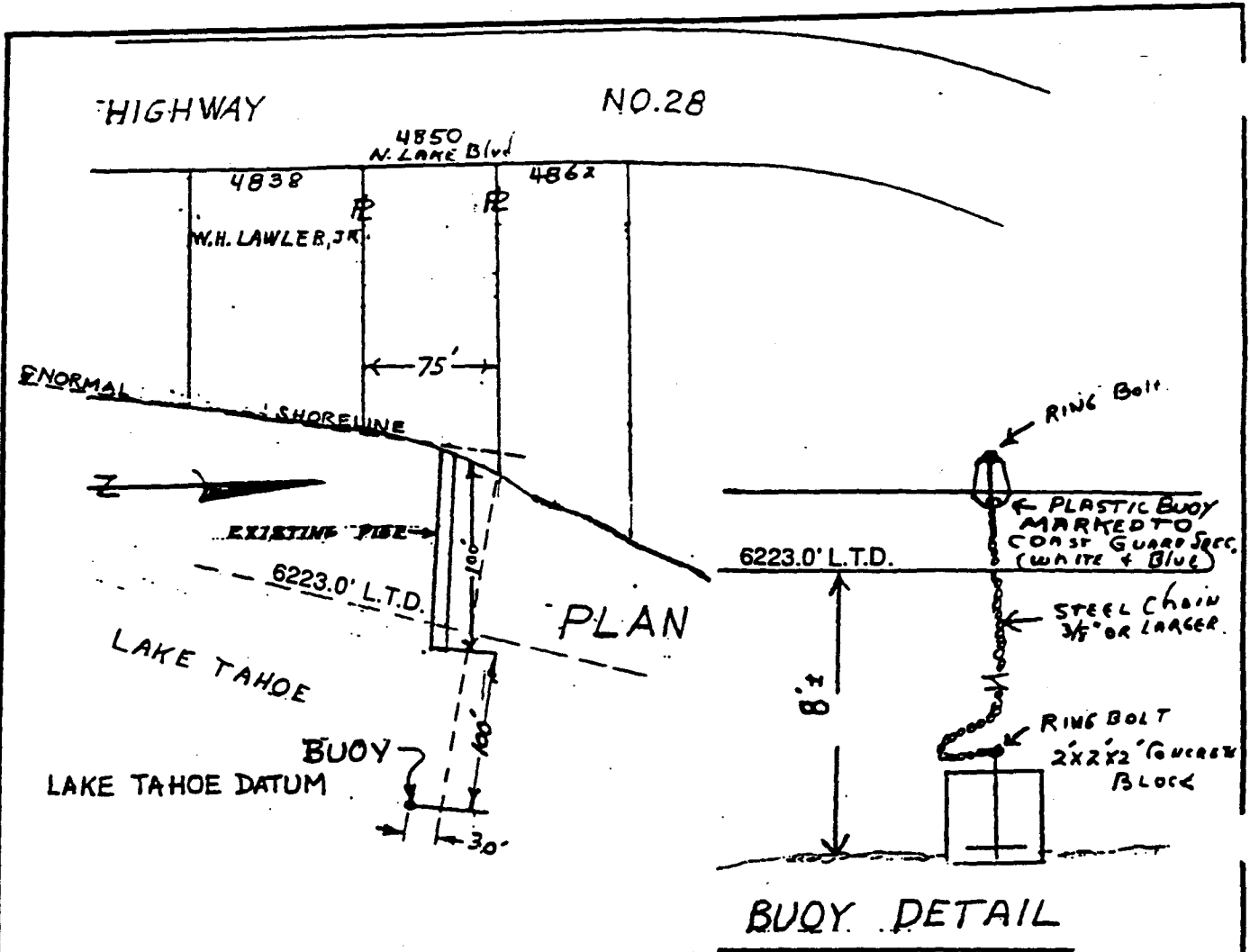

4850 North Lake Blvd.

NO SCALE

**LOCATION MAP**

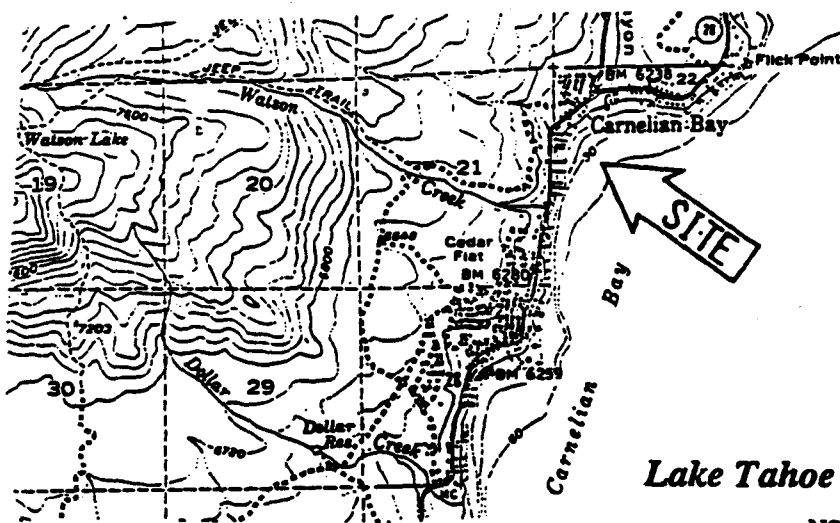

Lake Tahoe

NO SCALE

This Exhibit is solely for purposes of generally defining the lease premises, and is not intended to be, nor shall it be construed as, a waiver or limitation of any State interest in the subject or any other property.

**EXHIBIT "A"**

PRC 4994.9  
 APN 115 - 060 - 006  
 Lake Tahoe  
 PLACER COUNTY

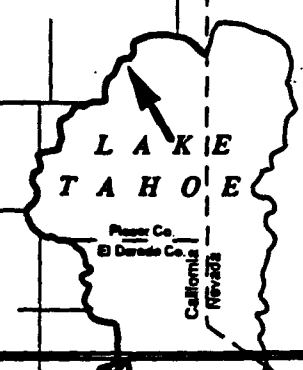

CALENDAR PAGE

234

MINUTE PAGE

1118

CG 405