

CALENDAR ITEM
C36

MINUTE ITEM
This Calendar Item No. C36
was approved as Minute Item
No. 36 by the State Lands
Commission by a vote of 3
to 0 at its 7/6/95
meeting.

A 1
S 2

PRC 4510.1
J. Ludlow
07/06/95

GENERAL LEASE - RIGHT-OF-WAY USE

PARTY:

PacifiCorp
920 Southwest Sixth Street
Portland, Oregon 97204-1256

LOCATION:

A 0.548 acre parcel of tide submerged land located in the
bed of the Klamath River near Crescent City, Del Norte
County.

EXHIBIT:

A. Vicinity and Site Map

AB 884:

N/A

RECOMMENDED ACTION:

IT IS RECOMMENDED THAT THE COMMISSION:

CEQA FINDING:

FIND THAT THE ACTIVITY IS EXEMPT FROM THE REQUIREMENTS OF
THE CEQA PURSUANT TO 14 CAL. CODE REGS. 15061 AS A
CATEGORICALLY EXEMPT PROJECT, CLASS 1, EXISTING FACILITIES,
2 CAL. CODE REGS. 2905 (a) (2).

SIGNIFICANT LANDS

INVENTORY FINDING:

FIND THAT THIS ACTIVITY IS CONSISTENT WITH THE USE
CLASSIFICATION DESIGNATED FOR THE LAND PURSUANT TO P.R.C.
6370, ET SEQ.

AUTHORIZATION:

AUTHORIZE ISSUANCE TO PACIFICORP OF A 15-YEAR GENERAL LEASE
- RIGHT-OF-WAY USE, BEGINNING MAY 20, 1995; IN CONSIDERATION
OF ANNUAL RENT IN THE AMOUNT OF \$144.00, WITH THE STATE
RESERVING THE RIGHT TO FIX A DIFFERENT RENTAL ON EACH FIFTH
ANNIVERSARY OF THE LEASE; PROVISION OF PUBLIC LIABILITY
INSURANCE FOR COMBINED COVERAGE OF \$1,000,000; FOR THE
CONTINUED USE AND MAINTENANCE OF AN OVERHEAD 12.5 KV POWER
DISTRIBUTION LINE ON THE LAND DESCRIBED ON EXHIBIT "A"
ATTACHED AND BY REFERENCE MADE A PART HEREOF.

CALENDAR PAGE

231

MINUTE PAGE

1115

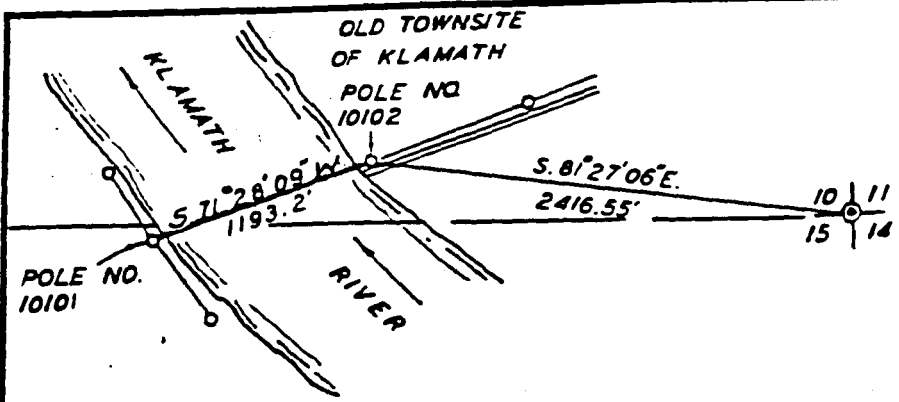

PLAN
SCALE 1"=1000'

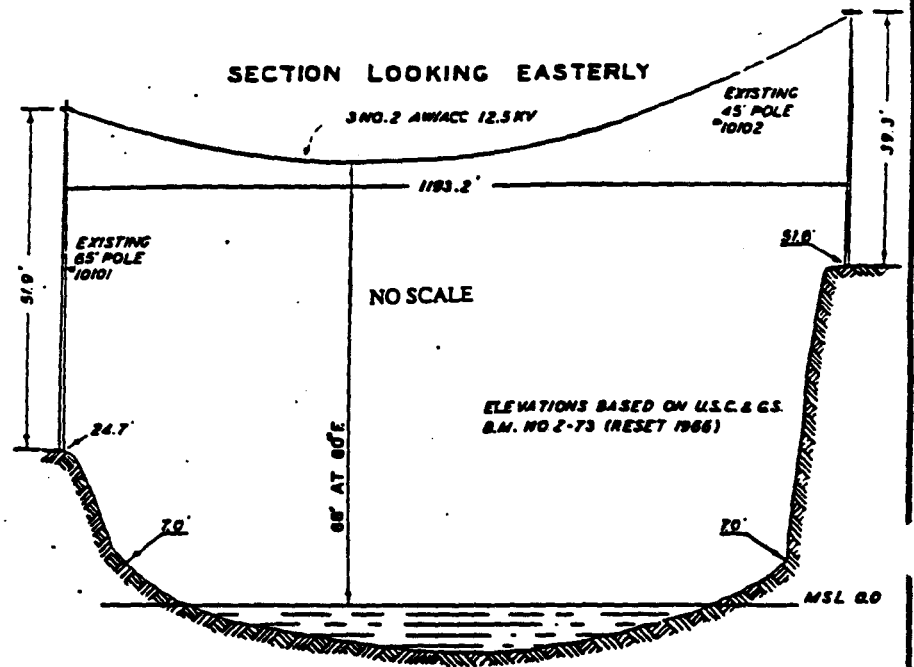

APPLICATION BY
PACIFIC POWER & LIGHT COMPANY
PORTLAND OREGON
FOR EXISTING
OVERHEAD WIRE CROSSING
OVER
KLAMATH RIVER
DEL NORTE COUNTY, CALIF.

ELEVATIONS BASED ON U.S.C. & G.S.
B.M. NO 2-73 (RESET 1966)

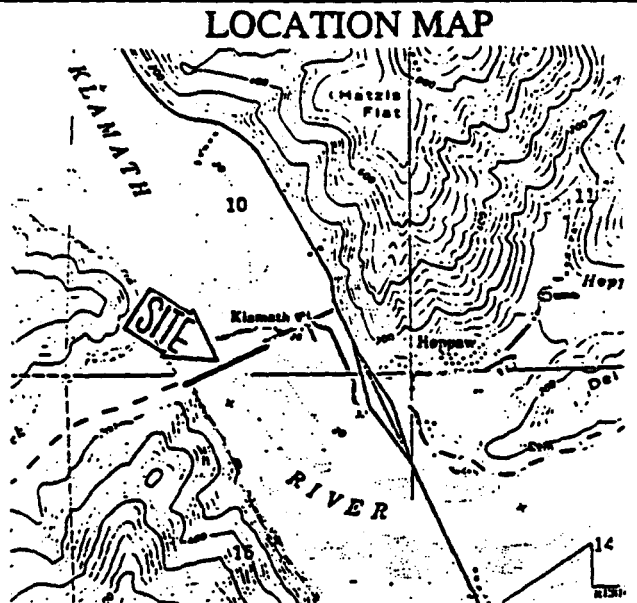

EXHIBIT "A"
PRC 4510.1
S 10 & 15, T13N, R1E, HM
Powerline R/W
Klamath River
DEL NORTE COUNTY



This Exhibit is solely for purposes of generally defining the lease premises, and is not intended to be, nor shall it be construed as, a waiver or limitation of any State interest in the subject or any other property.