

CALENDAR ITEM

C19

MINUTE ITEM

This Calendar Item No. C19 was approved as Minute Item No. 19 by the State Lands Commission by a vote of 3 to 0 at its 7/6/95 meeting.

A 6

S 9

GENERAL LEASE - RECREATIONAL AND PROTECTIVE STRUCTURE USE

07/06/95  
WP 6824  
D.Jones

APPLICANT:

Alfred and Hildagard Zacharias and  
Erwin and Veronika Zacharias  
4205 Burrell Way  
Sacramento, California 95864

LOCATION:

Tide and submerged land in the Sacramento River adjacent to  
APN 35-352-005, Sutter County.

EXHIBITS:

- A. Site Map
- B. Location Map

AB 884:

N/A

RECOMMENDED

ACTION:

IT IS RECOMMENDED THAT THE COMMISSION:

CEQA FINDING:

FIND THAT THE ACTIVITY IS EXEMPT FROM THE REQUIREMENTS OF  
THE CEQA PURSUANT TO 14 CAL. CODE REGS. 15061 AS A  
CATEGORICALLY EXEMPT PROJECT, CLASS 1, EXISTING FACILITIES,  
2 CAL. CODE REGS. 2905 (a) (2).

SIGNIFICANT LANDS

INVENTORY FINDING:

FIND THAT THIS ACTIVITY IS CONSISTENT WITH THE USE  
CLASSIFICATION DESIGNATED FOR THE LAND PURSUANT TO P.R.C.  
6370, ET SEQ.

AUTHORIZATION:

AUTHORIZE ISSUANCE TO ALFRED AND HILDAGARD ZACHARIAS AND  
ERWIN AND VERONIKA ZACHARIAS OF A TEN-YEAR GENERAL LEASE -  
RECREATIONAL AND PROTECTIVE STRUCTURE USE, BEGINNING APRIL  
1, 1995; IN CONSIDERATION OF \$383.00 PER ANNUM, WITH THE  
STATE RESERVING THE RIGHT AT ANY TIME TO SET A MONETARY  
RENTAL IF THE COMMISSION FINDS SUCH ACTION TO BE IN THE  
STATE'S BEST INTEREST; PROVISION OF PUBLIC LIABILITY  
INSURANCE FOR COMBINED SINGLE LIMIT COVERAGE OF \$500,000;  
FOR A 22 FT. X 38 FT. FLOATING BOAT DOCK, A 3 FT. X 10 FT.  
FLOATING WALKWAY, AND THE MAINTENANCE OF EXISTING BANK  
PROTECTION; ON THE LAND DESCRIBED ON EXHIBIT "A" ATTACHED  
AND BY REFERENCE MADE A PART HEREOF.

CALENDAR PAGE

73

MINUTE PAGE

954

Area to be leased lies directly beneath dock and walkway, plus a necessary use area 10 feet in width around the entire dock and walkway. Excepting therefrom any portion lying above the ordinary high water mark.

**SITE PLAN**

SCALE 1" = 60'

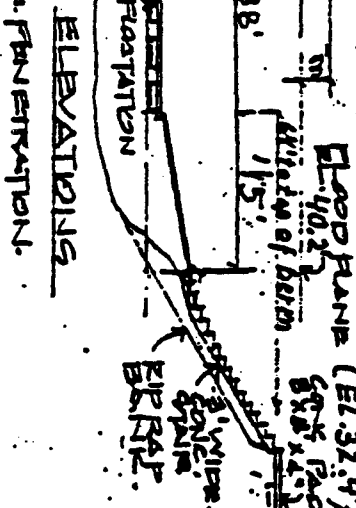
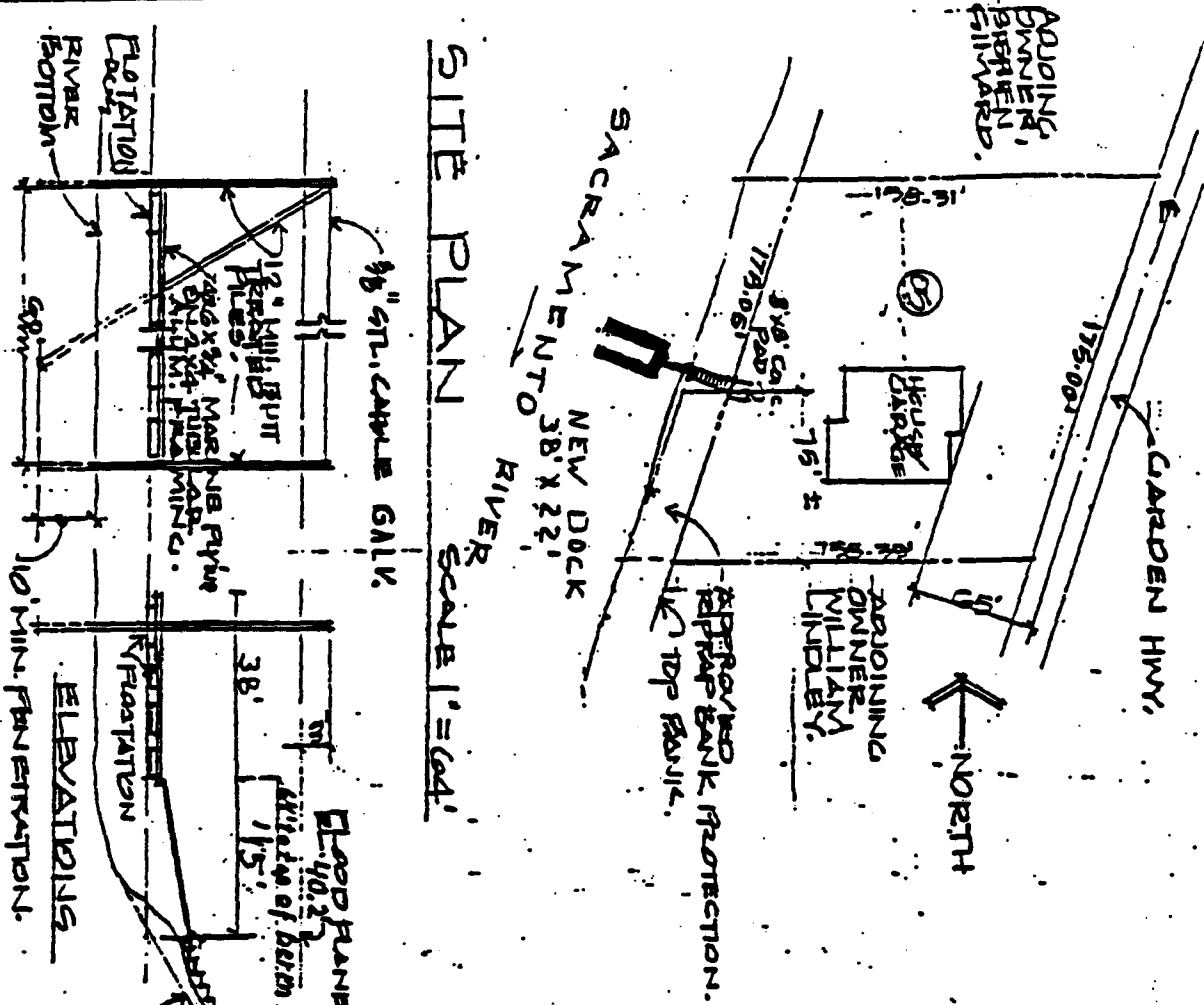

**VICINITY MAP**  
 PROPOSED RECREATION FLAT  
 APPLICATION BY:  
 ALFRED BRAVIN  
 4209 BURELL WAY  
 SACRAMENTO, CA  
 95864  
 LOCATION:  
 BENNETT SUB-DIV.  
 ADJACENT PARCEL  
 NO. 85-952-08  
 SUTTER CO., CA.

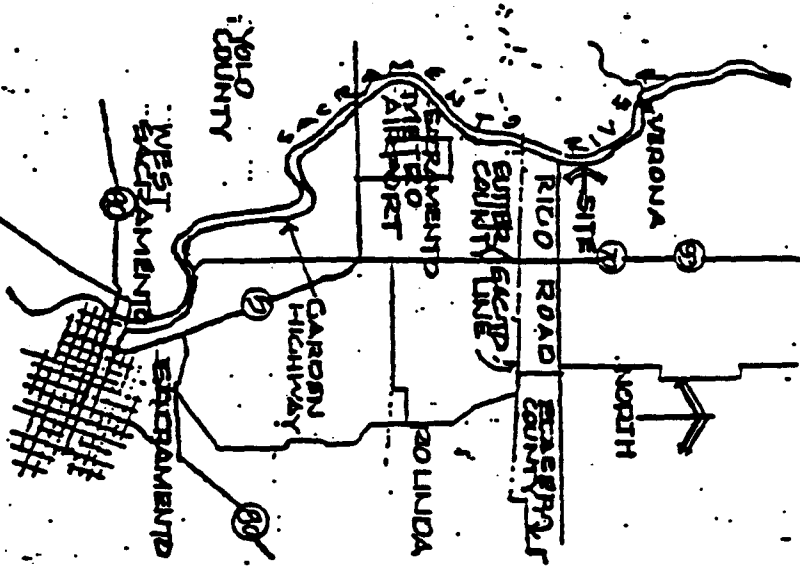

This exhibit is solely for purposes of generally defining the lease premises and is not intended to be, nor shall it be construed as, a waiver or limitation of any State interest in the subject or any other property.

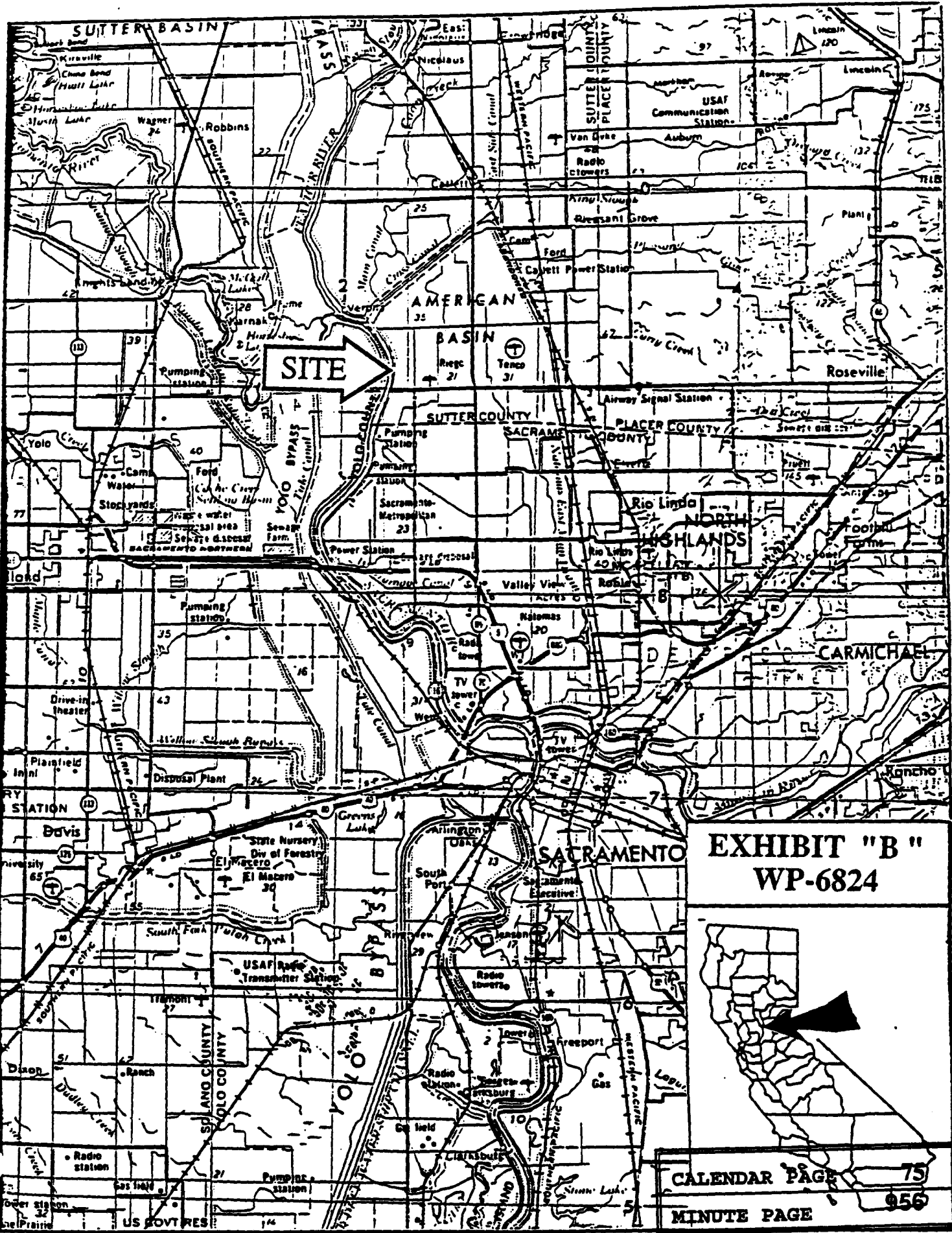

**EXHIBIT "B"**  
**WP-6824**



CALENDAR PAGE **75**  
 MINUTE PAGE **956**