

CALENDAR ITEM
C07

MINUTE ITEM
This Calendar Item No. C07
was approved as Minute Item
No. 07 by the State Land
Commission by a vote of 3
to 0 at its 7/6/95
meeting.
PRC 6891 WP 6891
Burks
07/06/95

A 5
S 6

GENERAL LEASE - PROTECTIVE STRUCTURE USE

APPLICANT:

Victor F. and Nancy H. Stefan
4061 Garden Highway
Sacramento, California 95834

LOCATION:

Tide and submerged land located in the Sacramento River,
Mile 66.1, adjacent to Garden Highway (APN 225-0090-019),
Sacramento County.

EXHIBITS:

- A. Site Map
- B. Location Map

AB 884:

N/A

RECOMMENDED ACTION:

IT IS RECOMMENDED THAT THE COMMISSION:

CEQA FINDING:

FIND THAT THE ACTIVITY IS EXEMPT FROM THE REQUIREMENTS OF
THE CEQA PURSUANT TO 14 CAL. CODE REGS. 15061 AS A
CATEGORICALLY EXEMPT PROJECT, CLASS 1, 2 CAL. CODE REGS.
2905 (a)(2).

SIGNIFICANT LANDS

INVENTORY FINDING:

FIND THAT THIS ACTIVITY IS CONSISTENT WITH THE USE
CLASSIFICATION DESIGNATED FOR THE LAND PURSUANT TO
P.R.C. 6370, ET. SEQ.

AUTHORIZATION:

AUTHORIZE ISSUANCE TO VICTOR AND NANCY STEFAN OF A 15-YEAR
GENERAL LEASE - PROTECTIVE STRUCTURE USE, BEGINNING
SEPTEMBER 26, 1995; BANK PROTECTION - PUBLIC USE AND
BENEFIT, WITH THE STATE RESERVING THE RIGHT AT ANY TIME TO
SET A MONETARY RENTAL IF THE COMMISSION FINDS SUCH ACTION TO
BE IN THE STATE'S BEST INTEREST; PROVISION OF PUBLIC
LIABILITY INSURANCE FOR A COMBINED SINGLE LIMIT COVERAGE OF
\$500,000; FOR CONTINUED USE AND MAINTENANCE OF EXISTING BANK
PROTECTION; ON THE LAND DESCRIBED ON EXHIBIT "A" ATTACHED
AND BY REFERENCE MADE A PART HEREOF.

CALENDAR PAGE	25
MINUTE PAGE	878

Area to be leased lies directly beneath dock and walkway, plus a necessary use area 10 feet in width around the entire dock and walkway. Excepting therefrom any portion lying above the ordinary high water mark.

No. 9028

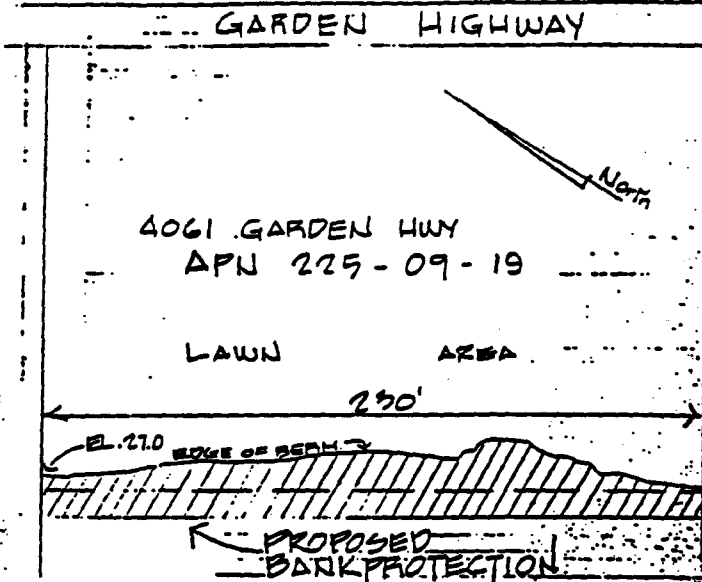

SACRAMENTO RIVER

PLAN VIEW

no scale

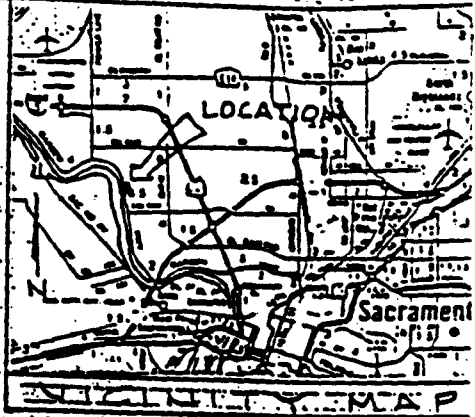
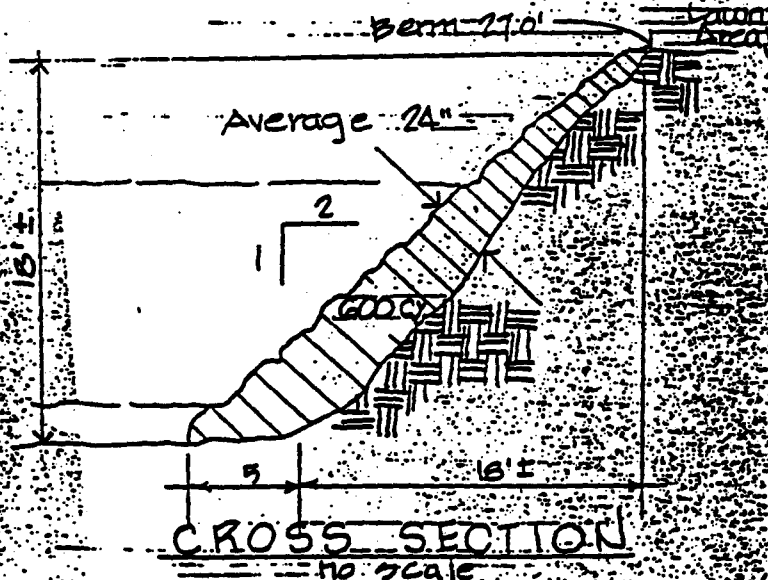

Note:
bank protection material will consist of broken concrete rubble free of rebar and asphalt material

BANK PROTECTION

Applicant:
Ed Victor Stefan
4061 Garden Hwy
Sacramento, Ca

Date: June 7, 1965
Sheet 1 of 1

Approved: [Signature]
Date: 6-27-65

This exhibit is solely for purposes of generally defining the lease premises, and is not intended to be, nor shall it be construed as, a waiver or limitation of any State interest in the subject or any other property.

EXHIBIT "A"

WP-6891-26

CALENDAR PAGE

26

MINUTE PAGE

879

