

CALENDAR ITEM  
C30

MINUTE ITEM  
This Calendar Item No. C30  
was approved as Minute Item  
No. 30 by the State Land  
Commission by a vote of 3  
to 0 at its 3/1/95  
meeting.

A 4  
S 1

03/01/95  
PRC 5648.9  
J. Ludlow

REPLACEMENT OF RECREATIONAL PIER PERMIT

**PARTY:**

Otis Russell Johnson, III,  
Forest Lowell Jones, and  
Daniel George Volkman, III, Co-Trustees  
P.O. Box 3364  
Truckee, California 96160

**LOCATION:**

A parcel of submerged land located in the bed of Lake Tahoe  
at Carnelian Bay, Placer County.

**EXHIBITS:**

A. Vicinity and Site Map

**AB 884:**

N/A

**OTHER PERTINENT INFORMATION:**

Due to adverse weather conditions at Lake Tahoe, the  
required site inspection will be made as weather permits.

**RECOMMENDED**

**ACTION:**

IT IS RECOMMENDED THAT THE COMMISSION:

**CEQA**

**FINDING:**

FIND THAT THE ACTIVITY IS EXEMPT FROM THE REQUIREMENTS OF  
THE CEQA PURSUANT TO 14 CAL. CODE REGS. 15061 AS A  
CATEGORICALLY EXEMPT PROJECT, CLASS 1, 2 CAL. CODE  
REGS. 2905 (a) (2).

**SIGNIFICANT LANDS**

**INVENTORY FINDING:**

FIND THAT THIS ACTIVITY IS CONSISTENT WITH THE USE  
CLASSIFICATION DESIGNATED FOR THE LAND PURSUANT TO P.R.C.  
6370, ET SEQ.

CALENDAR PAGE	183
MINUTE PAGE	197

CALENDAR ITEM NO. C30 (CONT'D)

**AUTHORIZATION:**

1. AUTHORIZE ISSUANCE TO OTIS RUSSELL JOHNSON, III, FOREST LOWELL JONES, AND DANIEL GEORGE VOLKMAN, III, CO-TRUSTEES OF THE 10-YEAR RECREATIONAL PIER PERMIT ON FILE IN THE COMMISSION'S OFFICES FOR ALL OF THE STATE'S SOVEREIGN LANDS BELOW THE ELEVATION OF 6223 LTD UNDER APPLICANT'S PIER AS DEPICTED ON EXHIBIT "A" ATTACHED AND BY REFERENCE MADE A PART HEREOF, BEGINNING MARCH 28, 1994; NO MONETARY CONSIDERATION PURSUANT TO P.R.C. SECTION 6503.5.
2. AUTHORIZE STAFF TO PERFORM THE REQUIRED LAKE TAHOE SITE INSPECTION AT A LATER DATE, WEATHER PERMITTING.

CALENDAR PAGE	184
MINUTE PAGE	198

**REPAIR PROGRAM**  
 15'x15' ROCK CRIB STRUCTURE  
 TO BE REBUILT FROM EL.  
 6225 UP TO DECK.

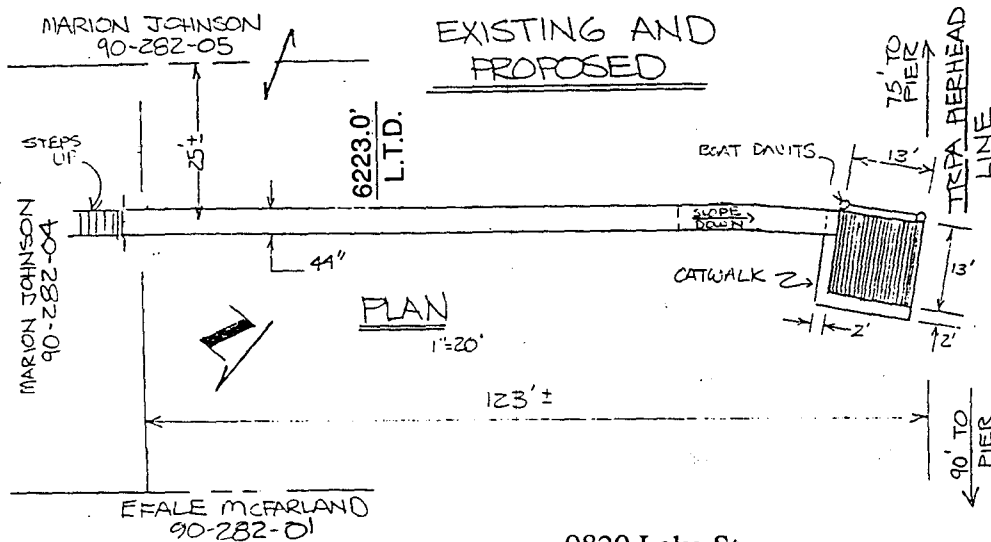
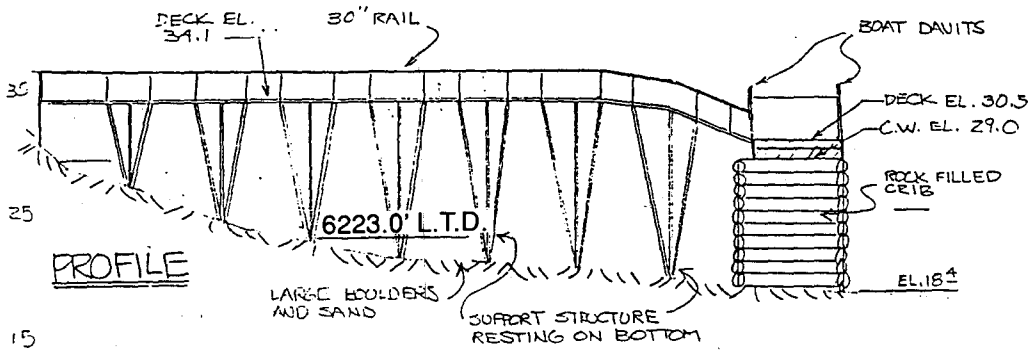

Lake Tahoe

9820 Lake St.

NO SCALE

**LOCATION MAP**

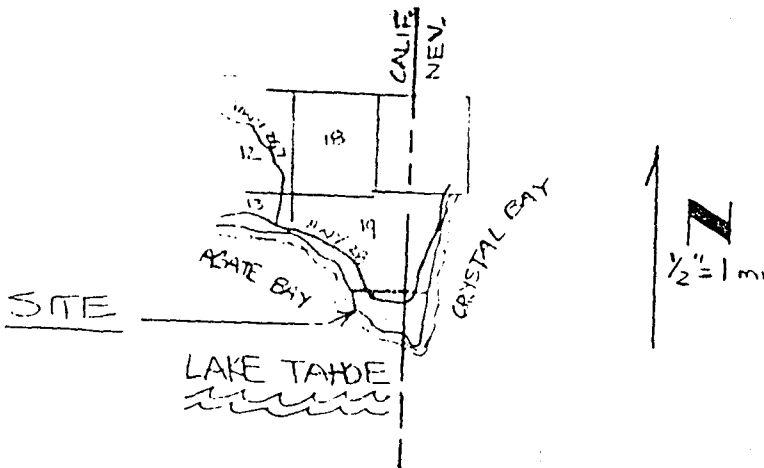

**EXHIBIT "A"**  
 WP 5648  
 APN 90 - 282 - 04  
 Lake Tahoe  
 PLACER COUNTY

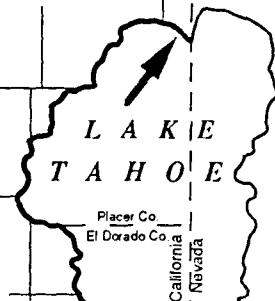

This Exhibit is solely for purposes of generally defining the lease premises, and is not intended to be, nor shall it be construed as, a waiver or limitation of any State interest in the subject or any other property.

CALENDAR PAGE	185
MINUTE PAGE	199