

MINUTE ITEM  
This Calendar Item No. C20  
was approved as Minute Item  
No. 20 by the State Lands  
Commission by a vote of 3  
to 0 at its 3/1/95  
meeting.

CALENDAR ITEM

A 8

C20

S 4

GENERAL LEASE - RECREATIONAL USE

03/01/95

WP 4809

JONES

PRC 4809

APPLICANT:

Frank E. Silva, Jr., and Steven A. Silva,  
as Co-Trustees of the Frank Enos Silva and Eleanor Nunes  
Silva Irrevocable Living Trust Agreement #3 dated  
December 3, 1976  
14686 State Highway 160  
Walnut Grove, California 95690

LOCATION:

Sacramento River at Long Island, adjacent to APN 142-0140-  
008, Sacramento County.

EXHIBIT: A. Site Plan B. Location Map.

AB 884: N/A.

RECOMMENDED

ACTION:

IT IS RECOMMENDED THAT THE COMMISSION:

CEQA

FINDING:

FIND THAT THE ACTIVITY IS EXEMPT FROM THE REQUIREMENTS OF  
THE CEQA PURSUANT TO 14 CAL. CODE REGS. 15061 AS A  
CATEGORICALLY EXEMPT PROJECT: FOR THE FLOATING DOCK, RAMP,  
WOOD DECK, AND WOODEN BULKHEAD - CLASS 3, NEW CONSTRUCTION  
OF SMALL STRUCTURES, 14 CAL. CODE REGS. 15303.

SIGNIFICANT

LANDS:

FIND THAT THIS ACTIVITY IS CONSISTENT WITH THE USE  
CLASSIFICATION DESIGNATED FOR THE LAND PURSUANT TO  
P.R.C. 6370, ET SEQ.

AUTHORIZATION:

AUTHORIZE ISSUANCE TO FRANK E. SILVA., JR., AND STEVEN A.  
SILVA, AS CO-TRUSTEES OF THE FRANK ENOS SILVA AND ELEANOR  
NUNES SILVA IRREVOCABLE LIVING TRUST AGREEMENT #3, DATED  
DECEMBER 3, 1976, OF A TEN YEAR GENERAL LEASE - RECREATIONAL  
USE, BEGINNING SEPTEMBER 27, 1993; IN CONSIDERATION AS  
FOLLOWS: NO CONSIDERATION FOR THE FLOATING DOCK AND  
STAIRWAY, GANGWAY, AND PIER WITH SHED, PURSUANT TO SECTION  
6503.5 OF THE P.R.C.; FOR A 25 FT. X 28 FT. PIER WITH SHED,  
A 3 FT. X 16 FT. GANGWAY, AN 8 FT. X 25 FT. FLOATING DOCK  
AND STAIRWAY, ON THE LAND DESCRIBED ON EXHIBIT "A" ATTACHED  
AND BY REFERENCE MADE A PART HEREOF.

CALENDAR PAGE

88

MINUTE PAGE

104

Area to be leased lies directly beneath dock and walkway, plus a necessary use area 10 feet in width around the entire dock and walkway. Excepting therefrom any portion lying above the ordinary high water mark.

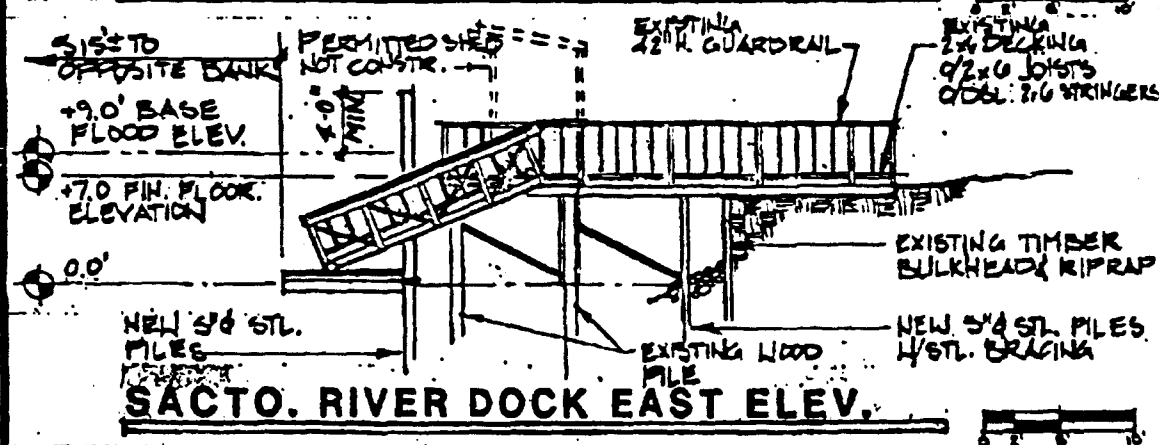
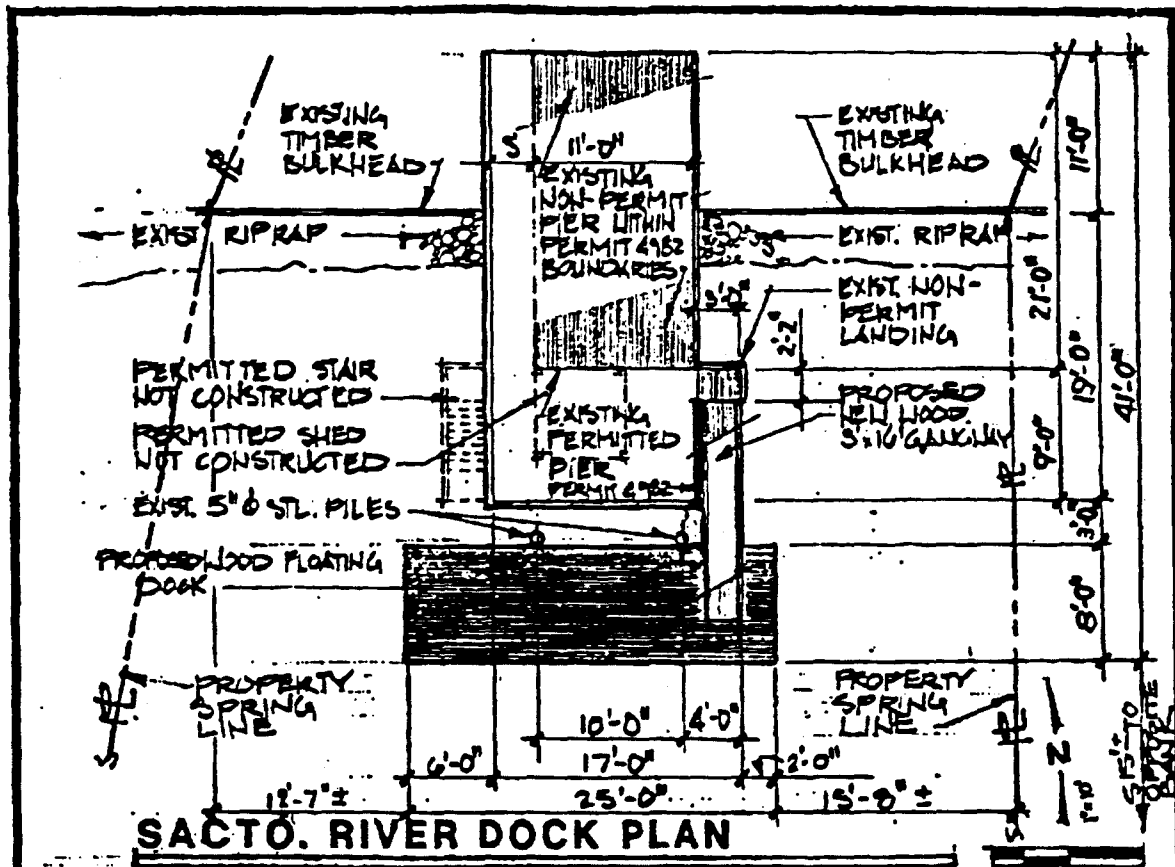

PURPOSE: PRIVATE RECREATION DATUM: U.S.G.S.	CONTENTS: SACTO. RIVER DOCK PLAN & ELEVATION	PROJECT: MODIFICATION TO EXISTING PERMIT FOR PIER SHEET 2 OF 2, REV.
--	---	---

This exhibit is solely for purposes of generally defining the lease premises, and is not intended to be, nor shall it be construed as, a waiver or limitation of any State interest in the subject or any other property.

EXHIBIT "A"  
 CALENDAR PAGE WP-4869  
 104.1  
 HENGE PAGE

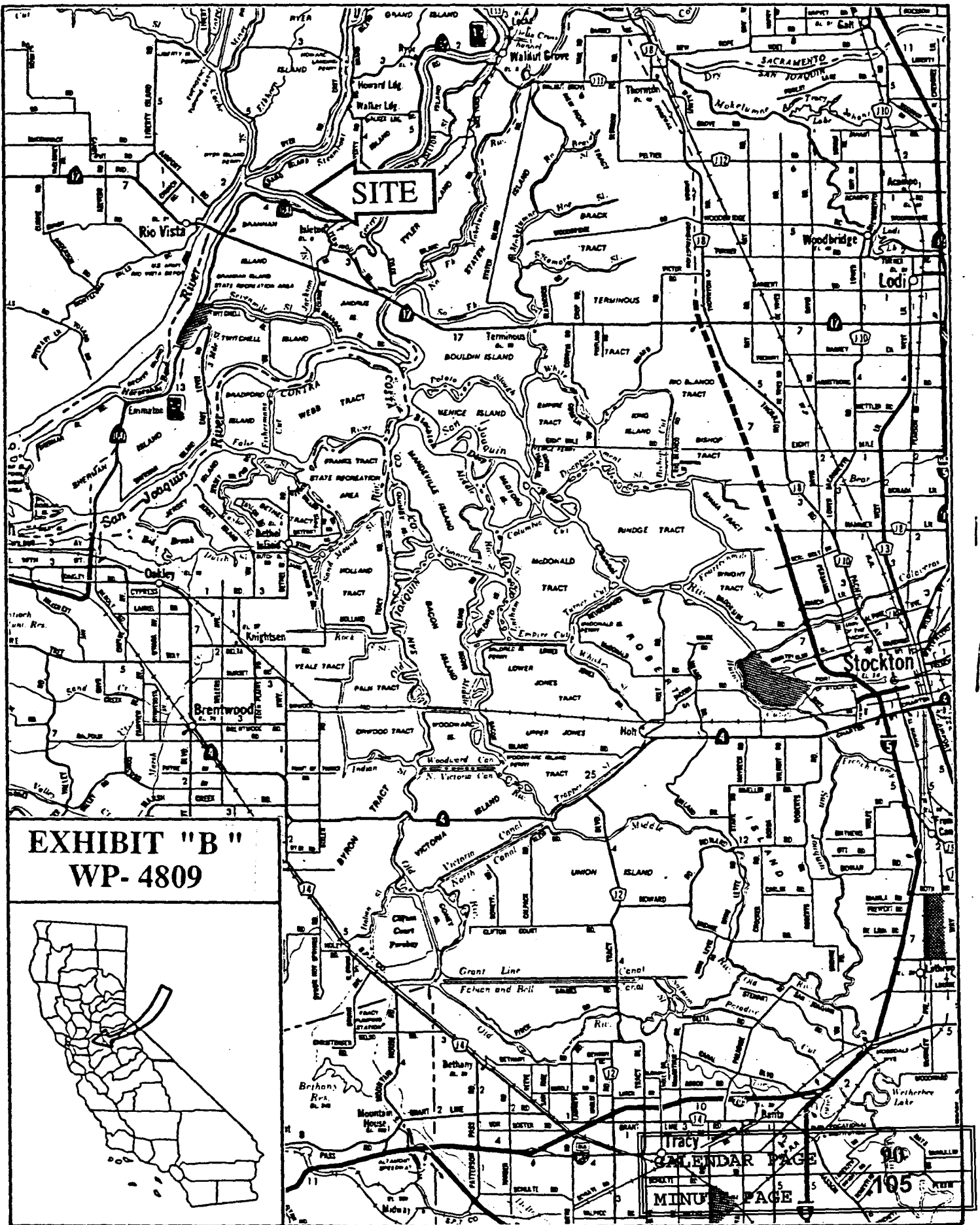

**SITE**

**EXHIBIT "B"**  
**WP-4809**



**CALENDAR PAGE 105**  
**MINUTE PAGE 105**