

MINUTE ITEM

This Calendar Item No. C19  
was approved as Minute Item  
No. 19 by the State Lands  
Commission by a vote of 3  
to 0 at its 3/1/95  
meeting.

CALENDAR ITEM  
C19

A 9  
S 6

03/01/95  
W 25156 PRC 7817  
D. Jones

GENERAL LEASE -  
RECREATIONAL AND PROTECTIVE STRUCTURE USE

APPLICANT:

George and Delia Grinzewitsch  
4141 Garden Highway  
Sacramento, California 95833

LOCATION:

A parcel of tide and submerged land adjacent to APN 225-09-054 in the Sacramento River, Sacramento County.

EXHIBITS:

- A. Site Plan
- A-1. Site Plan
- B. Location Map

AB 884:

06/17/95

RECOMMENDED

ACTION:

IT IS RECOMMENDED THAT THE COMMISSION:

CEQA

FINDING:

FIND THAT THE ACTIVITY IS EXEMPT FROM THE REQUIREMENTS OF THE CEQA PURSUANT TO 14 CAL. CODE REGS. 15061 AS A CATEGORICALLY EXEMPT PROJECT; THE BOAT DOCK AND RAMP: 2 CAL. CODE REGS. 2905 (c) (1), CLASS 3, NEW CONSTRUCTION OF SMALL STRUCTURES, AND THE MAINTENANCE OF EXISTING BANK PROTECTION: 14 CAL. CODE REGS. 15304, CLASS 4, MINOR ALTERATIONS TO LAND.

AUTHORIZATION:

AUTHORIZE THE ISSUANCE OF A 10-YEAR GENERAL LEASE - RECREATIONAL AND PROTECTIVE STRUCTURE USE TO GEORGE AND DELIA GRINZEWITSCH BEGINNING FEBRUARY 1, 1995, IN CONSIDERATION OF THE FOLLOWING: PURSUANT TO SECTION 6503.5 OF THE P.R.C., NO CONSIDERATION FOR THE FLOATING BOAT DOCK AND RAMP; AND FOR THE MAINTENANCE OF THE EXISTING BANK PROTECTION, THE PUBLIC USE AND BENEFIT WITH THE STATE

CALENDAR PAGE	83
MINUTE PAGE	99

CALENDAR ITEM NO. C19 (CONT'D)

RESERVING THE RIGHT AT ANY TIME TO SET A MONETARY RENTAL IF THE COMMISSION FINDS SUCH ACTION TO BE IN THE STATE'S BEST INTEREST; PROVISION OF PUBLIC LIABILITY INSURANCE FOR COMBINED SINGLE LIMIT COVERAGE OF \$500,000; FOR A 10 FT. X 50 FT. FLOATING BOAT DOCK, A 45 FT., 6 INCH X 4 FT. STEEL RAMP, AND THE MAINTENANCE OF EXISTING BANK PROTECTION ON THE LAND DESCRIBED ON EXHIBIT "A" AND "A-1" ATTACHED AND BY REFERENCE MADE A PART HEREOF.

CALENDAR PAGE	84
MINUTE PAGE	100

This exhibit is solely for purposes of generally defining the lease premises, and is not intended to be, nor shall it be construed as, a waiver or limitation of any State interest in the subject or any other property.

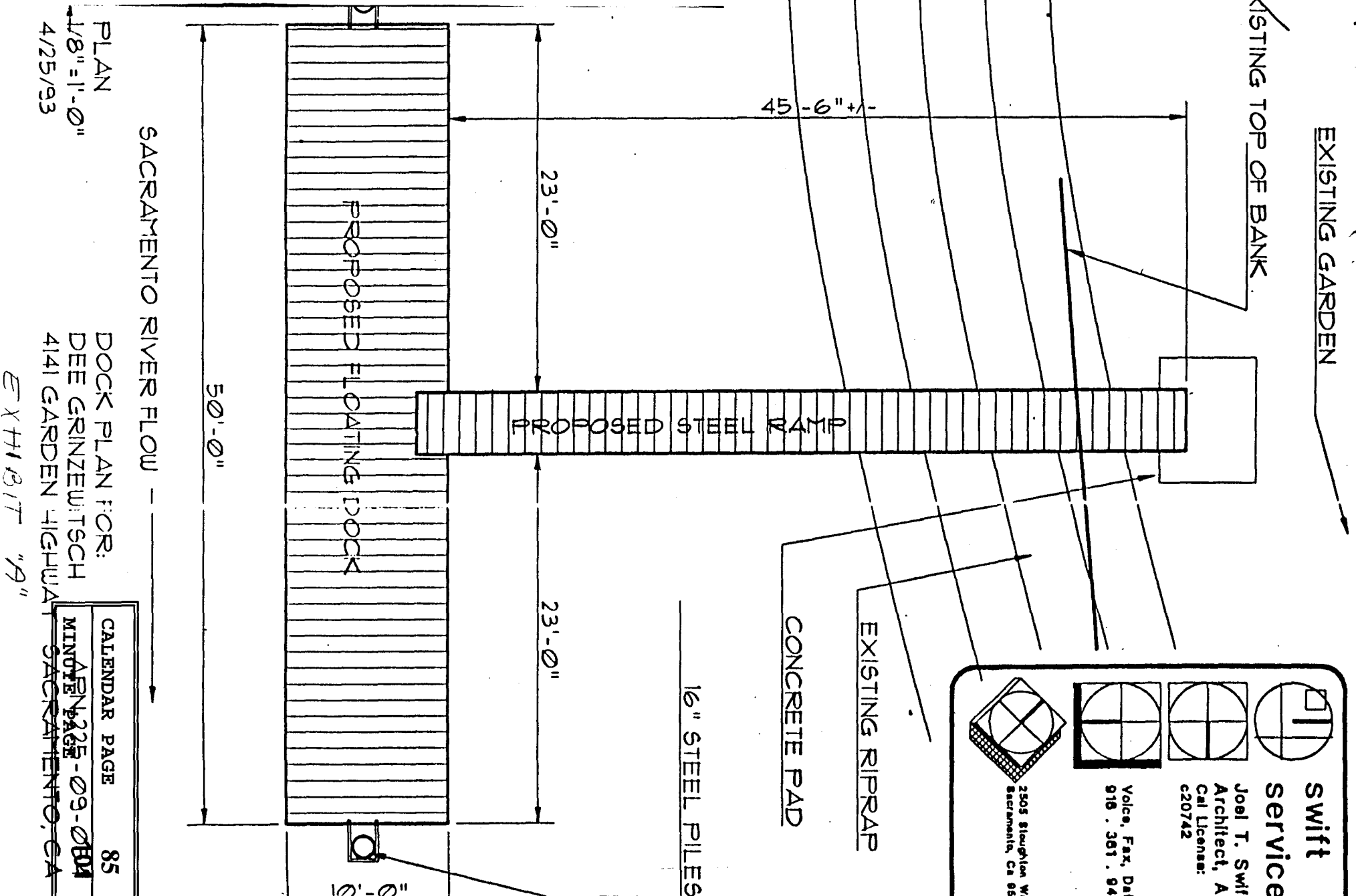

PLAN  
1/8" = 1'-0"  
4/25/93

SACRAMENTO RIVER FLOW

PROPOSED FLOATING DOCK

PROPOSED STEEL RAMP

EXISTING RIPRAP  
CONCRETE PAD

16" STEEL PILES

	<b>Swift Service</b>
Joel T. Swift, Architect, AIA Cal License: c20742	
Voice, Fax, Data: 916 . 361 . 9402	
2505 Stoughton Way, Sacramento, Ca 95827	

Area to be leased lies directly beneath dock and walkway, plus a necessary use area 10 feet in width around the entire dock and walkway. Excepting therefrom any portion lying above the ordinary high water mark.

DOCK PLAN FOR:  
DEE GRINZEWITSCH  
4141 GARDEN HIGHWAY  
SACRAMENTO, CA

CALENDAR PAGE	85
MINUTE PAGE	225 - 09 - 004

EXHIBIT "A"

DATE: 11/11/11  
25x10'

**swift service**

Joel T. Swift,  
Architect, AIA  
Cal License:  
c20742

Voice, Fax, Data:  
916 . 361 . 9402

2505 Stoughton Way,  
Sacramento, Ca 95827

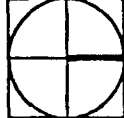
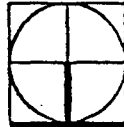
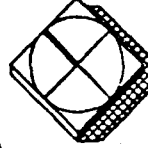
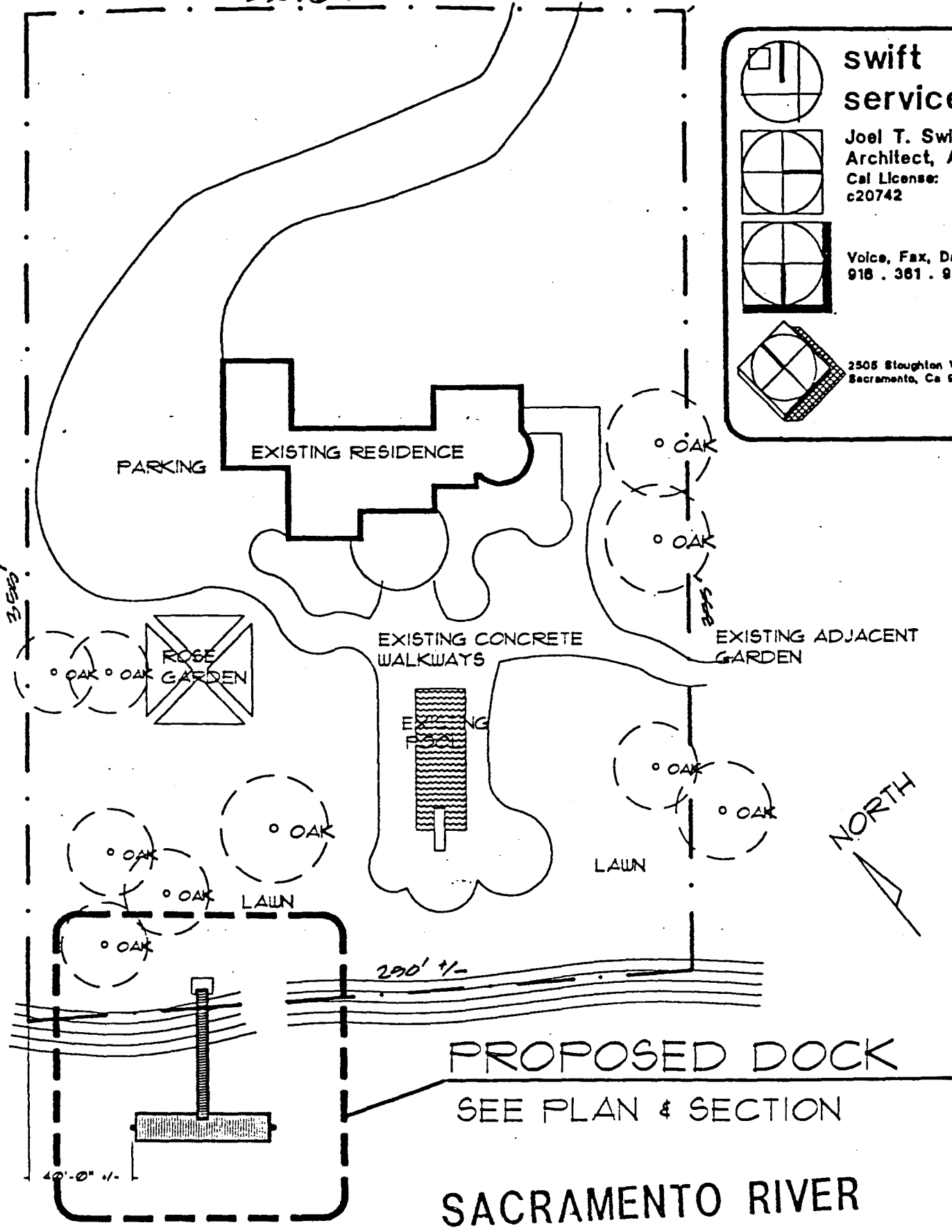





SITE PLAN  
1"=60.00'

DOCK PLAN FOR:  
DEE GRINZEWITSCH  
4141 GARDEN HIGHWAY

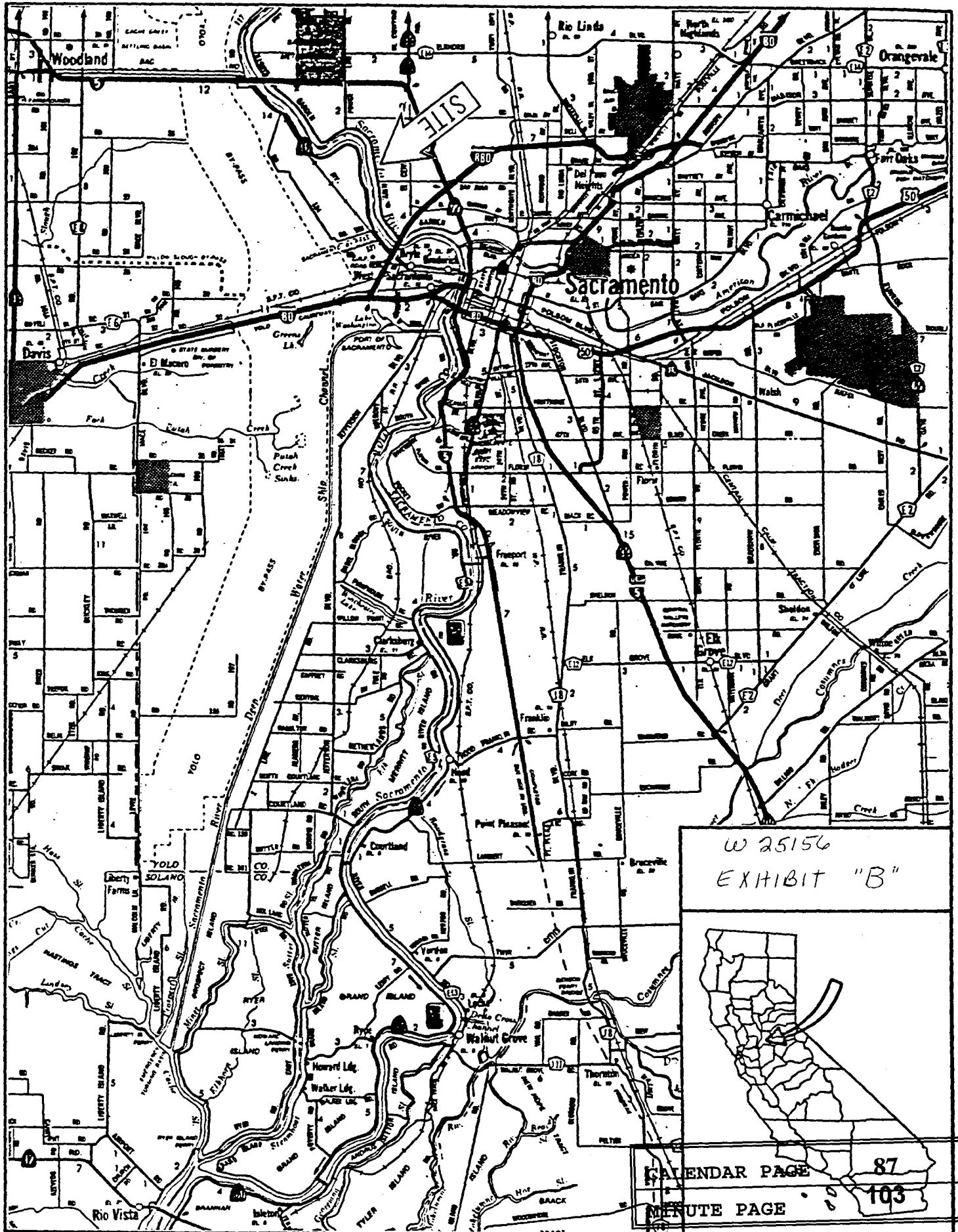
CALENDAR PAGE	86
AFN-225-09-054	102
MINUTE PAGE	2

EXHIBIT "A-1"



W 25156  
EXHIBIT "B"

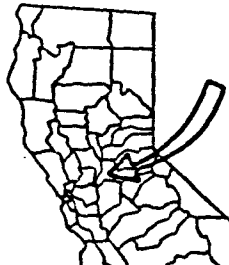

CALENDAR PAGE 87  
MINUTE PAGE 103