

CALENDAR ITEM  
C08

MINUTE ITEM  
This Calendar Item No. C08  
was approved as Minute Item  
No. 08 by the State Lands  
Commission by a vote of 3  
to 0 at its 3/1/95  
meeting.

A 4  
S 1

03/01/95  
Greif  
PRC 4471.9

REPLACEMENT OF RECREATIONAL PIER PERMIT

PARTY:

Harriet W. Henderson  
77 New Place Road  
Hillsborough, California 94010-6446

LOCATION:

A parcel of submerged land located in the bed of Lake Tahoe  
at Rubicon, El Dorado County.

EXHIBIT:

A. Vicinity and Site Map

AB 884:

N/A

OTHER PERTINENT  
INFORMATION:

Because of weather conditions a Required Site Inspection of  
the property will be made at a later date.

RECOMMENDED

ACTION:

IT IS RECOMMENDED THAT THE COMMISSION:

CEQA

FINDING:

FIND THAT THE ACTIVITY IS EXEMPT FROM THE REQUIREMENTS OF  
THE CEQA PURSUANT TO 14 CAL. CODE REGS. 15061 AS A  
CATEGORICALLY EXEMPT PROJECT, CLASS 1, 2 CAL. CODE REGS.  
2905 (A) (2).

SIGNIFICANT LANDS

INVENTORY FINDING:

FIND THAT THIS ACTIVITY IS CONSISTENT WITH THE USE  
CLASSIFICATION DESIGNATED FOR THE LAND PURSUANT TO P.R.C.  
6370, ET SEQ.

AUTHORIZATION:

AUTHORIZE ISSUANCE TO HARRIET W. HENDERSON OF THE 10-YEAR  
RECREATIONAL PIER PERMIT ON FILE IN THE COMMISSION'S OFFICES  
FOR ALL OF THE STATE'S SOVEREIGN LANDS BELOW THE ELEVATION  
OF 6223 LTD UNDER APPLICANT'S PIER AND BUOYS AS DEPICTED ON  
EXHIBIT "A" ATTACHED AND BY REFERENCE MADE A PART HEREOF,  
BEGINNING MAY 18, 1995; NO MONETARY CONSIDERATION PURSUANT  
TO P.R.C. SECTION 6503.5.

CALENDAR PAGE 31

MINUTE PAGE 49

Lake Tahoe

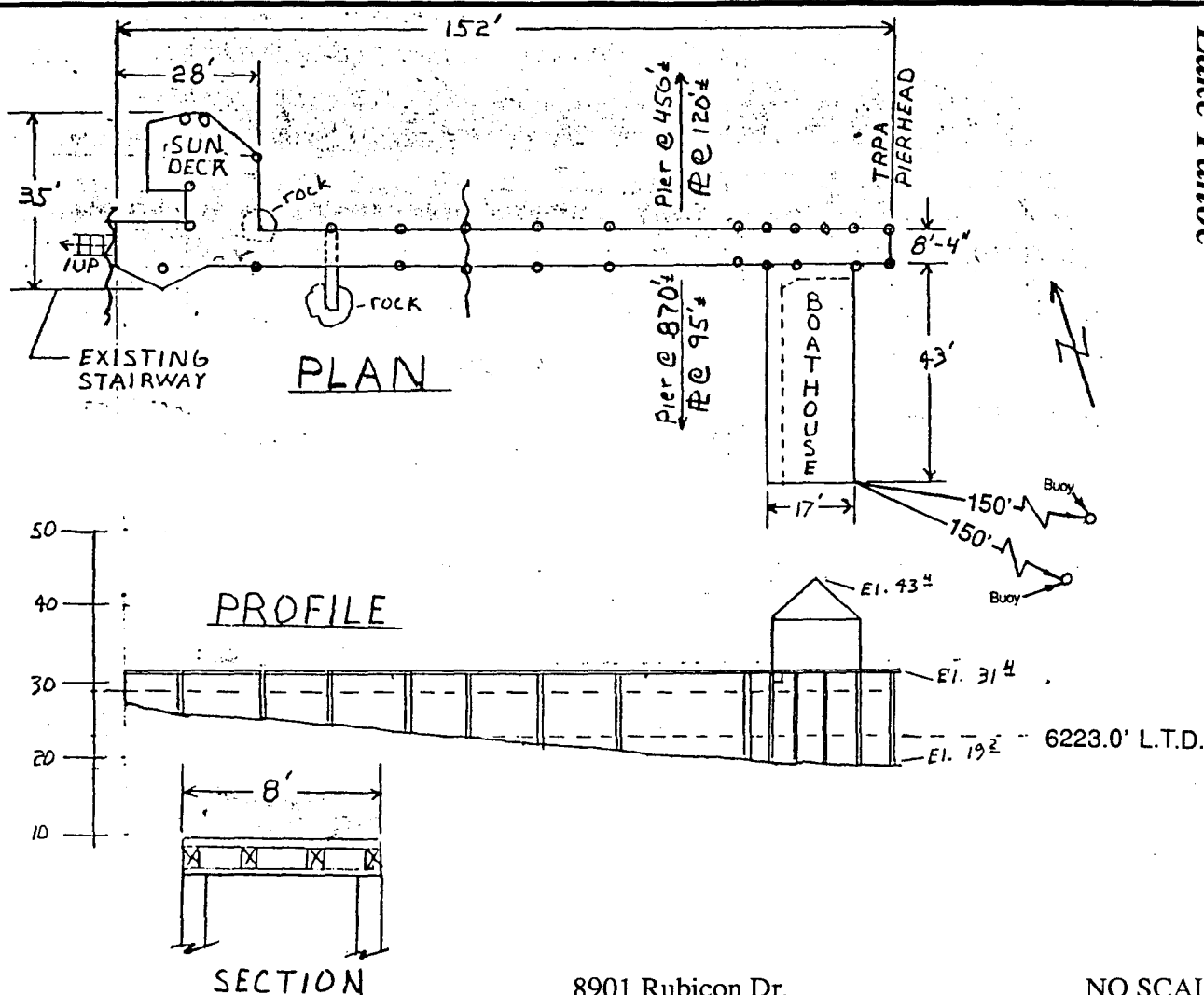

8901 Rubicon Dr.

NO SCALE

**LOCATION MAP**

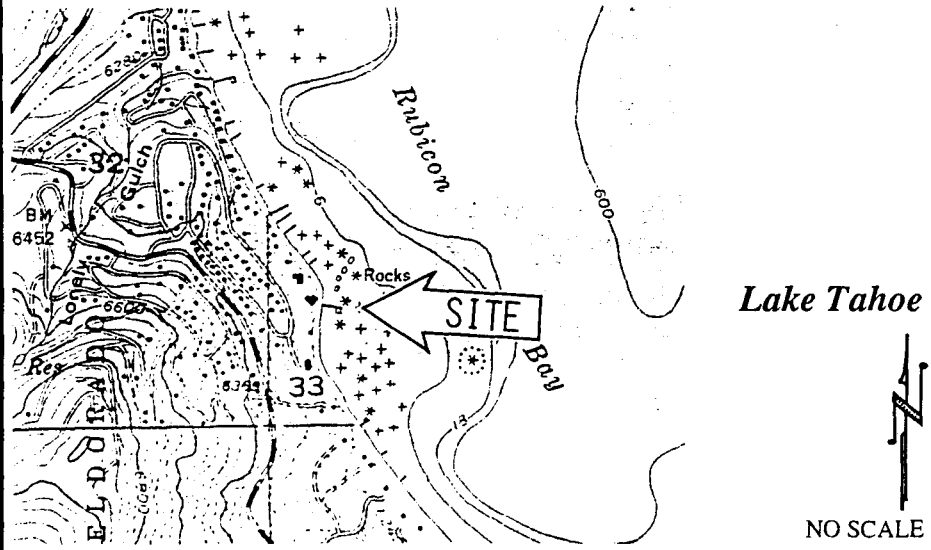

NO SCALE

**EXHIBIT "A"**  
 PRC 4471.9  
 APN 016 - 251 - 021  
 Lake Tahoe  
 EL DORADO COUNTY

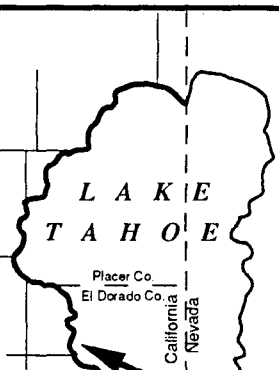

This Exhibit is solely for purposes of generally defining the lease premises, and is not intended to be, nor shall it be construed as, a waiver or limitation of any State interest in the subject or any other property.

CALENDAR PAGE	32
MINUTE PAGE	50