

CALENDAR ITEM

C06

MINUTE ITEM

This Calendar Item No. C06 was approved as Minute Item No. 06 by the State Lands Commission by a vote of 2 to 0 at its 12/21/94 meeting.

A 5  
S 6

RECREATIONAL PIER PERMIT

APPLICANT:

Ted L. and Joan E. Haugum  
P. O. Box 8299  
Incline Village, Nevada 89452

12/21/94  
WP 4939  
Burks  
PRC4939

LOCATION:

Tide and submerged land located in the Sacramento River (APN 274-250-27), Sacramento County.

EXHIBITS:

- A. Site Map
- B. Location Map

AB 884:  
N/A

RECOMMENDED

ACTION:

IT IS RECOMMENDED THAT THE COMMISSION:

CEQA

FINDING:

FIND THAT THE ACTIVITY IS EXEMPT FROM THE REQUIREMENTS OF THE CEQA PURSUANT TO 14 CAL. CODE REGS. 15061 AS A CATEGORICALLY EXEMPT PROJECT, CLASS 1, 2 CAL. CODE REGS. 2905 (a) (2).

SIGNIFICANT LANDS

INVENTORY FINDING:

FIND THAT THIS ACTIVITY IS CONSISTENT WITH THE USE CLASSIFICATION DESIGNATED FOR THE LAND PURSUANT TO P.R.C. 6370, ET. SEQ.

AUTHORIZATION:

AUTHORIZE ISSUANCE TO TED L. AND JOAN E. HAUGUM OF A TEN YEAR RECREATIONAL PIER PERMIT, BEGINNING AUGUST 16, 1994; NO MONETARY CONSIDERATION PURSUANT TO SECTION 6503.5 OF THE P.R.C.; FOR CONTINUED USE AND MAINTENANCE OF AN EXISTING 8 FT. X 32 FT. FLOATING BOAT DOCK AND 24 FT. ADJUSTABLE WALKWAY; ON THE LAND DESCRIBED ON EXHIBIT "A" ATTACHED AND BY REFERENCE MADE A PART HEREOF.

Area to be leased lies directly beneath dock and walkway, plus a necessary use area 10 feet in width around the entire dock and walkway. Excepting therefrom any portion lying above the ordinary high water mark.

No. 5211

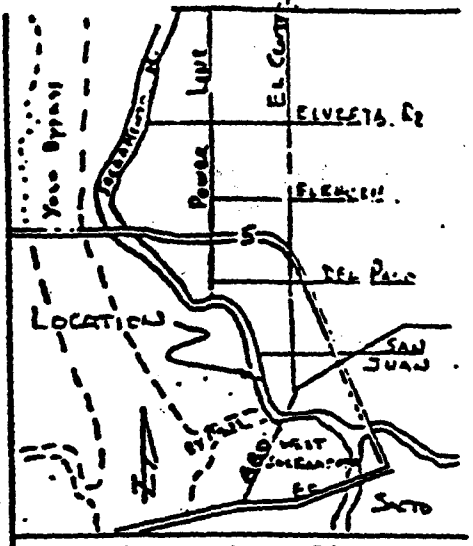
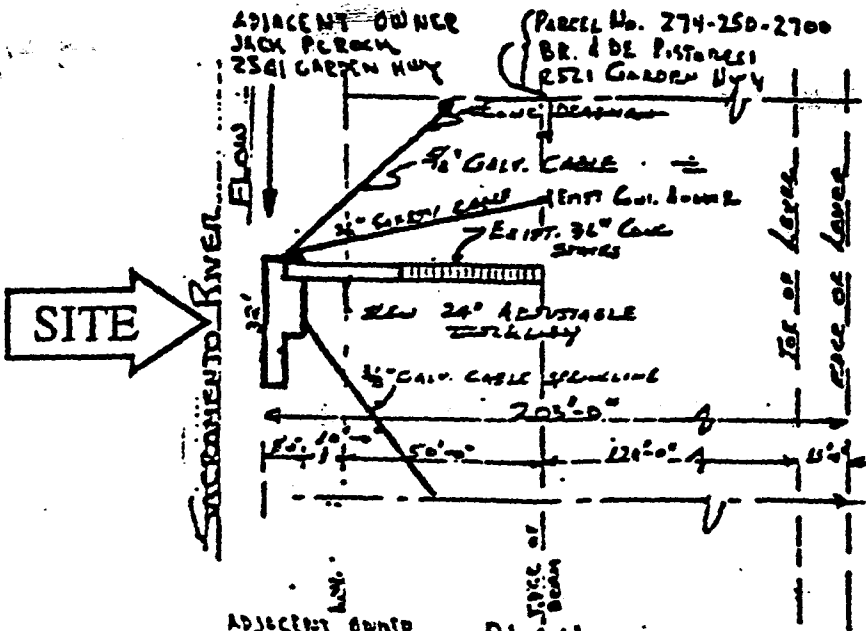

VICINITY MAP

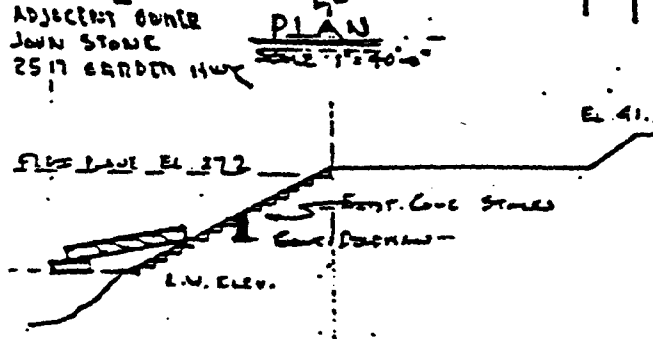

ELEVATION  
 Scale 1" = 40'-0"

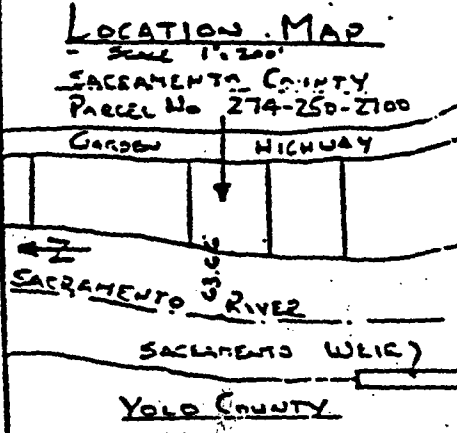

PROPOSED DOCK

LOCATION: PARCEL 274-250-2700  
 NATOMAS RIVERSIDE SUBDIV. 2  
 SACRAMENTO COUNTY, CAL.

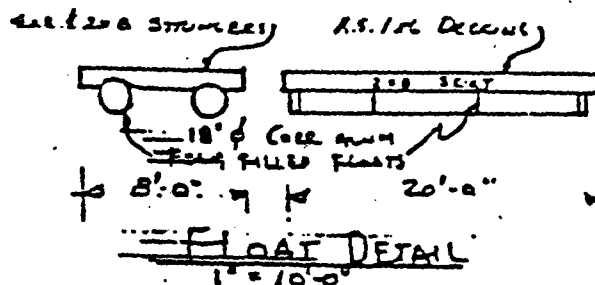

SEE SH. 2 FOR DETAILS

MAY 1, 1974 SHEET 1 OF 2

This exhibit is solely for purposes of generally defining the lease premises, and is not intended to be, nor shall it be construed as, a waiver or limitation of any State interest in the subject or any other property.

CALNDAR PAGE	30
EXHIBIT MAP	4695
MINUTE PAGE	P. 4939

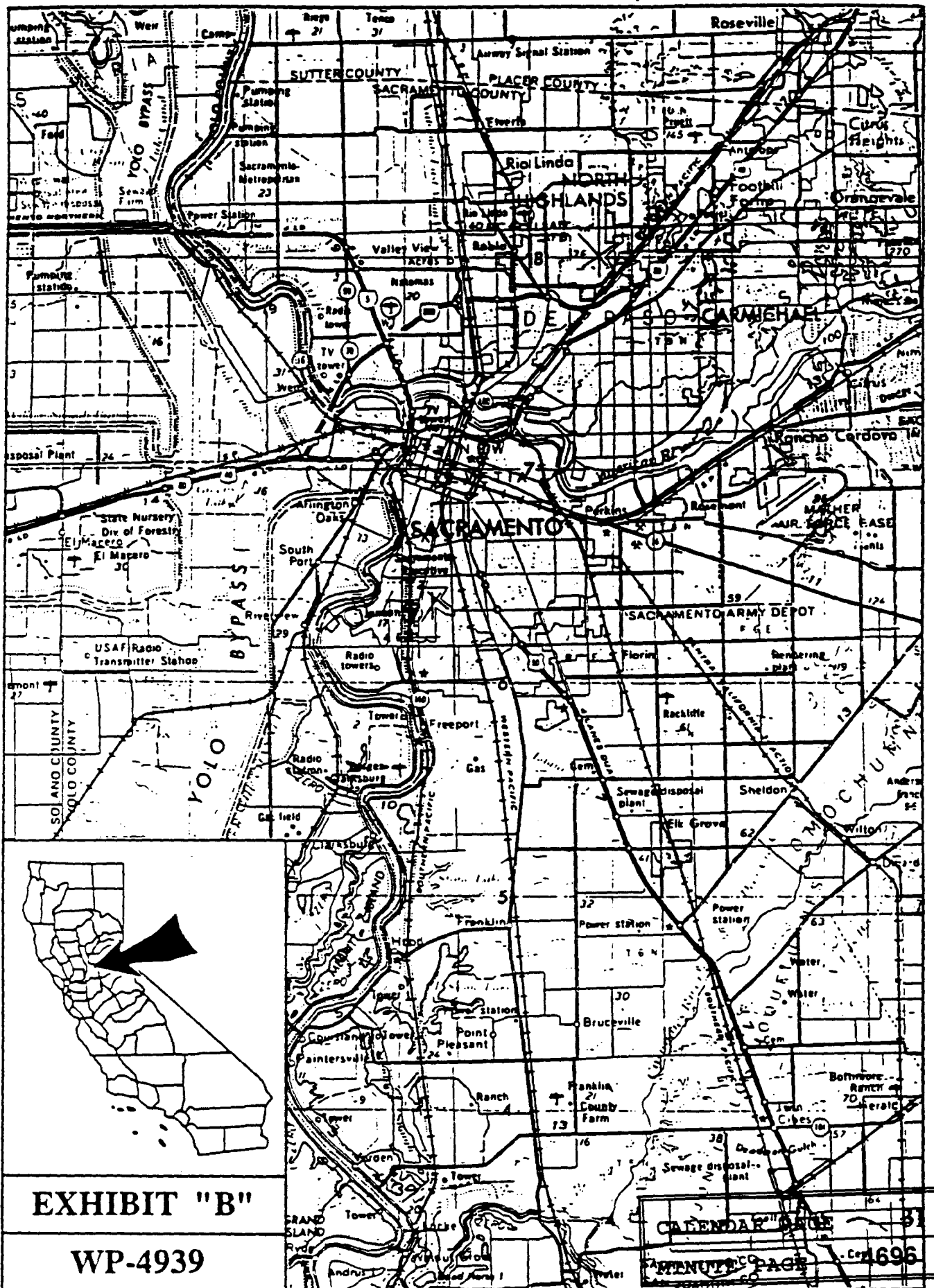

EXHIBIT "B"

WP-4939

CALENDAR PAGE

APPENDIX PAGE

1696