

MINUTE ITEM
This Calendar Item No. C11
was approved as Minute Item
No. 11 by the State Lands
Commission by a vote of 3
to 0 at its 11/15/94
meeting.

CALENDAR ITEM

C11

A 5

11/15/94

S 6

WP 6670

Burks

PRC 6670

GENERAL LEASE - PROTECTIVE STRUCTURE AND RECREATIONAL USE

APPLICANT:

Walter S. and Sharon J. Martin
4229 Garden Highway
Sacramento, California 95834

LOCATION:

Tide and submerged land located in the Sacramento River,
Lot 23, Natomas Riverside Subdivision No. 3, adjacent to the
Garden Highway (APN 225-090-45), Sacramento County.

EXHIBITS:

A. Site Map

B. Location Map

AB 884:

N/A

RECOMMENDED

ACTION:

IT IS RECOMMENDED THAT THE COMMISSION:

CEQA FINDING:

(Bank Protection)

FIND THAT THE ACTIVITY IS EXEMPT FROM THE REQUIREMENTS OF
THE CEQA PURSUANT TO 14 CAL. CODE REGS. 15061 AS A
CATEGORICALLY EXEMPT PROJECT, CLASS 4, 14 CAL. CODE REGS.
15304.

(Recreational Dock)

FIND THAT THE ACTIVITY IS EXEMPT FROM THE REQUIREMENTS OF
THE CEQA PURSUANT TO 14 CAL. CODE REGS. 15061 AS A
CATEGORICALLY EXEMPT PROJECT, CLASS 1, 2 CAL. CODE REGS.
2905(a)(2).

SIGNIFICANT LANDS

INVENTORY FINDING:

FIND THAT THIS ACTIVITY IS CONSISTENT WITH THE USE
CLASSIFICATION DESIGNATED FOR THE LAND PURSUANT TO P.R.C.
6370, ET SEQ.

CALENDAR PAGE	32
MINUTE PAGE	3615

AUTHORIZATION:

AUTHORIZE ISSUANCE TO WALTER S. AND SHARON J. MARTIN OF A TEN YEAR GENERAL LEASE - PROTECTIVE STRUCTURE AND RECREATIONAL USE, BEGINNING MAY 24, 1994; BANK PROTECTION - PUBLIC USE AND BENEFIT, WITH THE STATE RESERVING THE RIGHT AT ANY TIME TO SET A MONETARY RENTAL IF THE COMMISSION FINDS SUCH ACTION TO BE IN THE STATE'S BEST INTEREST; RECREATIONAL DOCK - NO MONETARY CONSIDERATION PURSUANT TO SECTION 6503.5 OF THE P.R.C.; PROVISION OF PUBLIC LIABILITY INSURANCE FOR A COMBINED SINGLE LIMIT COVERAGE OF \$500,000; FOR CONTINUED USE AND MAINTENANCE OF AN EXISTING 28 FT. X 48 FT. SINGLE-BERTH UNCOVERED FLOATING BOAT DOCK WITH WALKWAY, AND AUTHORIZE PREVIOUSLY UNAUTHORIZED BANK PROTECTION; ON THE LAND DESCRIBED ON EXHIBIT "A" ATTACHED AND BY REFERENCE MADE A PART HEREOF.

CALENDAR PAGE	33
MINUTE PAGE	3616

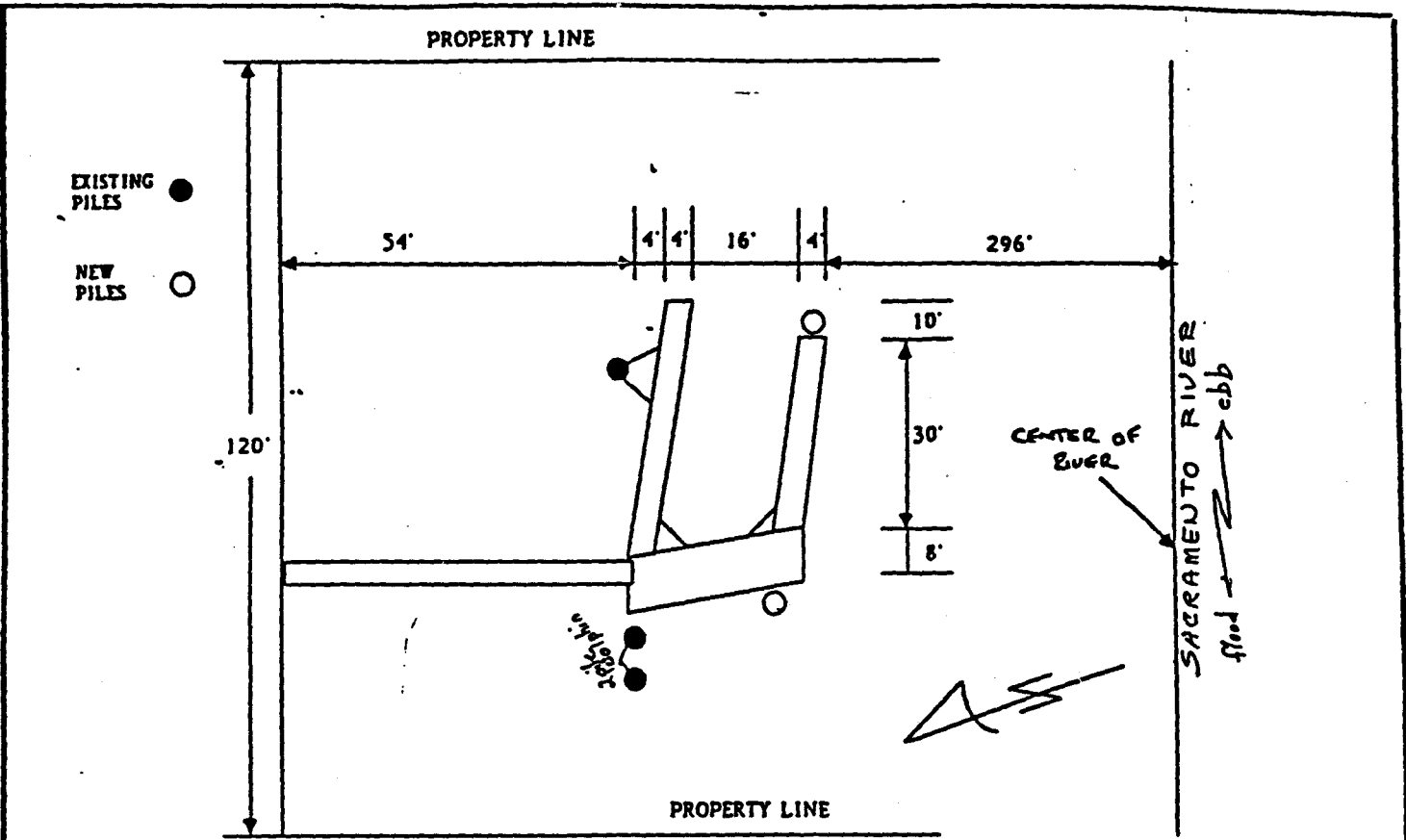

PARCEL NUMBER 225 - 090 - 45

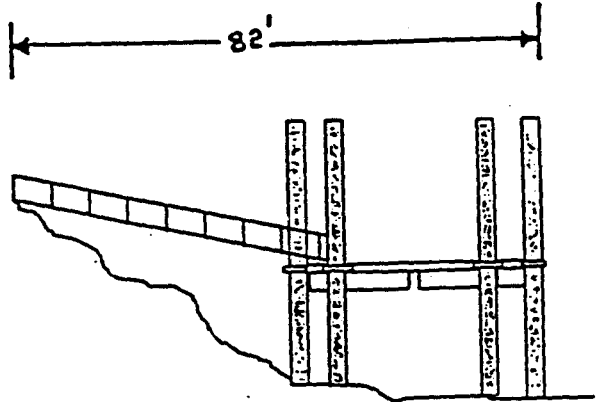
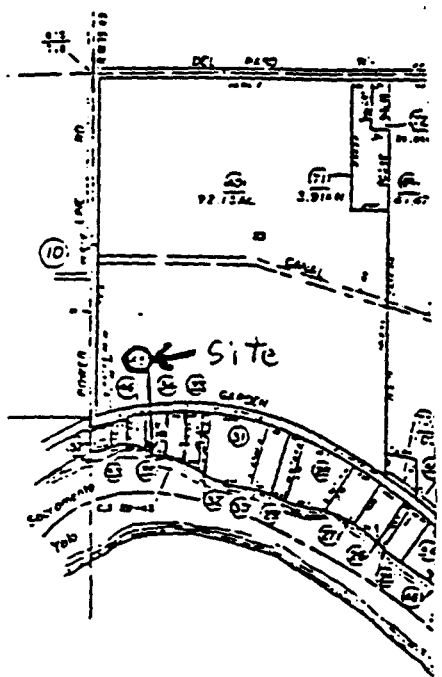

EXHIBIT A
WP 6670

This Land description is solely for purposes of generally defining the lease premises, and is not intended to be, nor shall it be construed as, a waiver or limitation of any State interest in the subject or any other property.

REPLACE FLOATING DOCK

OWNER: **CALENDAR PAGE 34**
MINUTE PAGE 3617
 4229 Garden Highway
 SACRAMENTO, CA 95834

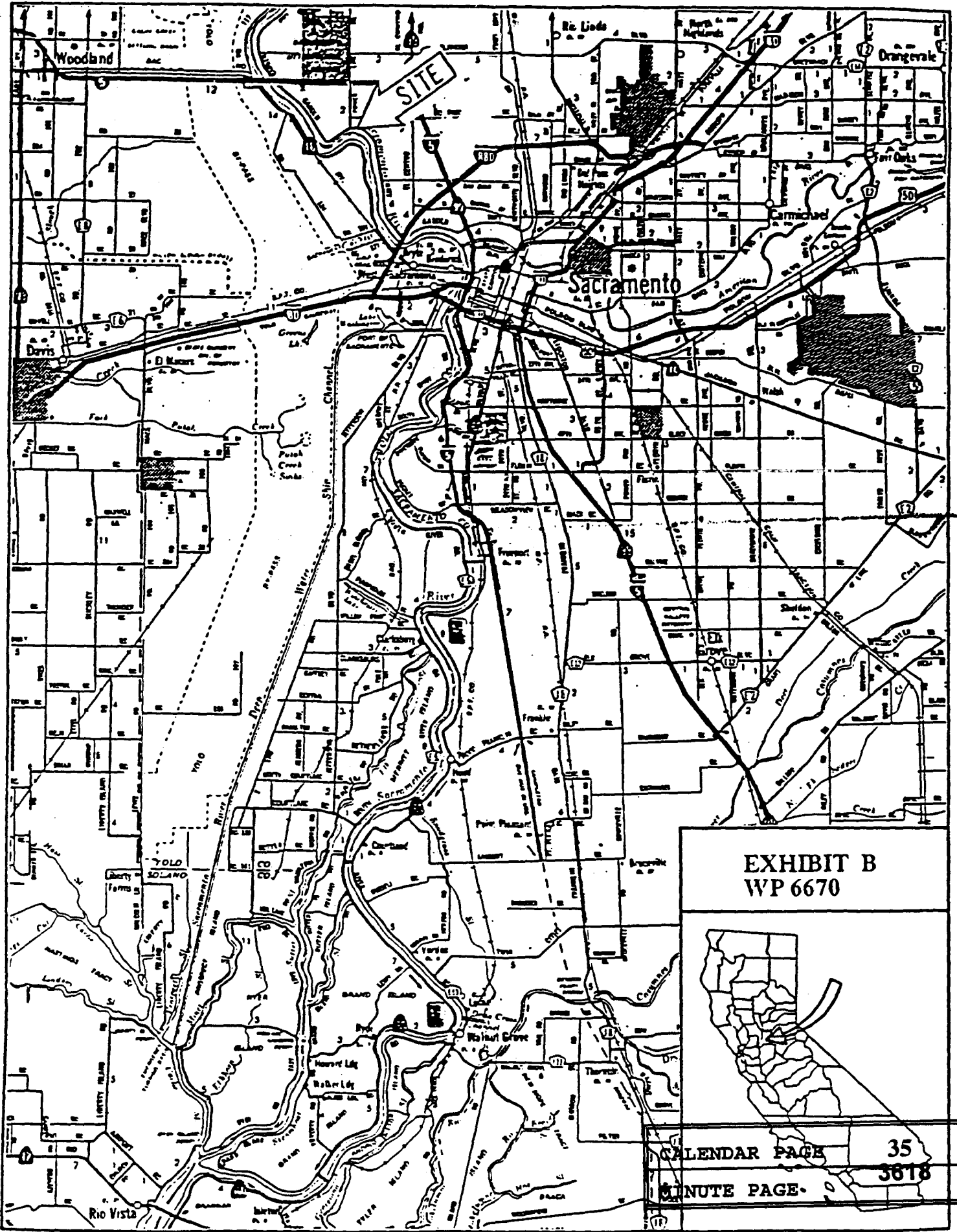

EXHIBIT B
WP 6670



CALENDAR PAGE	35
MINUTE PAGE	3618