

CALENDAR ITEM

C21

MINUTE ITEM
This Calendar Item No. C21
was approved as Minute Item
No. 21 by the State Lands
Commission by a vote of 3
to 0 at its 4/6/94
meeting

A 6
S 3

04/06/94
W 25055
Lam
PRC 7759

RECREATIONAL PIER PERMIT

PARTY: Lura Crossley
19 Greenbrae Boardwalk
Greenbrae, California 94904

LOCATION: Tide and submerged land in Corte Madera Creek, City
of Larkspur, Marin County.

EXHIBITS: A. Site Map B. Location Map

AB 884: 07/05/94

CEQA

FINDING: FIND THAT THE ACTIVITY IS EXEMPT FROM THE
REQUIREMENTS OF THE CEQA PURSUANT TO 14 CAL. CODE
REGS. 15061 AS A CATEGORICALLY EXEMPT PROJECT,
CLASS 3, 2 CAL. CODE REGS. 2905(c)(1).

SIGNIFICANT LANDS

INVENTORY

FINDING: FIND THAT THIS ACTIVITY IS CONSISTENT WITH THE USE
CLASSIFICATION DESIGNATED FOR THE LAND PURSUANT TO
P.R.C. 6370, ET. SEQ.

RECOMMENDED

ACTION: IT IS RECOMMENDED THAT THE COMMISSION:

AUTHORIZE ISSUANCE TO LURA CROSSLEY OF A TEN YEAR
RECREATIONAL PIER PERMIT, BEGINNING APRIL 1, 1994;
NO MONETARY CONSIDERATION PURSUANT TO SECTION
6503.5 OF THE P.R.C., FOR CONTINUED USE AND
MAINTENANCE OF A 40 FT. X 13.5 FT. FLOATING DOCK, A
3 FT. X 37.5 FT. GANGWAY AND A 4.5 FT. X 77.5 FT.
WALKWAY; ON THE LAND DESCRIBED ON EXHIBIT "A"
ATTACHED AND BY REFERENCE MADE A PART HEREOF.

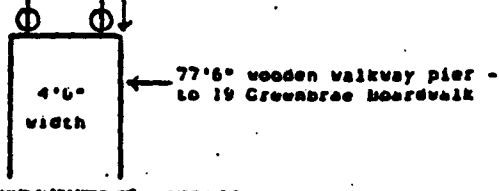
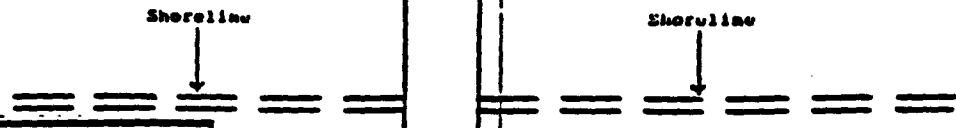
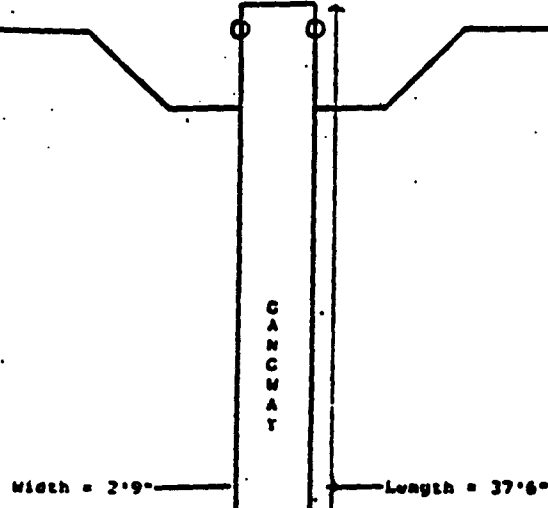
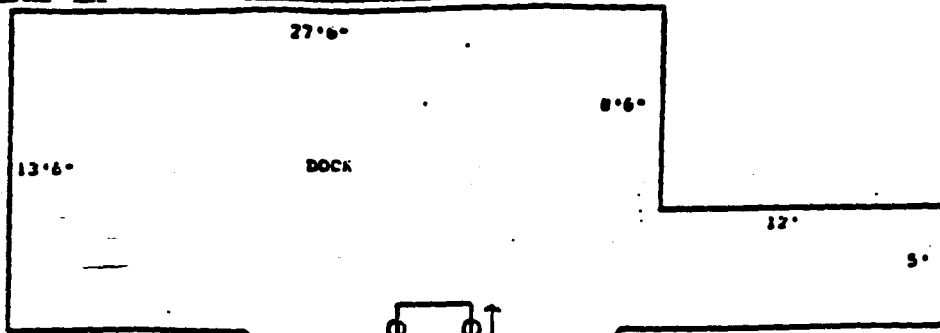

EXHIBIT "A"
Site Map W 25055
CROSSLEY
Corte Madera Creek
City of Lakespur
Marin County



NOTE:
THIS EXHIBIT IS NOT A SURVEY,
NOR DOES ANY LINE APPEARING
HEREON REPRESENT A BOUNDARY
LINE.

NOTE:
THIS EXHIBIT IS SOLELY FOR PURPOSE OF GENERALLY
DEFINING THE LEASE PREMISE, AND IS NOT INTENDED TO BE,
NOR SHALL IT BE CONSTRUED AS, A WAIVER OR LIMITATION
OF ANY STATE INTEREST IN THE SUBJECT OR ANY OTHER
PROPERTY.

