

MINUTE ITEM

This Calendar item No. 24
was approved as Minute Item
No. 24 by the State Lands
Commission by a vote of 2
0 at its 3/2/92
meeting.

CALENDAR ITEM

A 3

~ 24

03/02/92

S 1

W 8670.115
Gordon

PRC 7619

GENERAL PERMIT - RECREATIONAL USE

APPLICANT:

John E. McAmis and Renee McAmis
390 Honey Run Road
Chico, California 95928

AREA, TYPE LAND AND LOCATION:

A 0.027-acre parcel of submerged land located in Donner Lake
at Truckee, Nevada County.

LAND USE:

Construction and maintenance of a pier which is to be used
for recreational boating.

TERMS OF PROPOSED PERMIT:

Initial period:

Ten (10) years beginning March 2, 1992.

Public liability insurance:

Combined single limit coverage of \$500,000.

Special:

(1) The permit is conditioned on the consent of the
littoral owner.

(2) The permit prohibits the use of the facilities
for residential purposes.

(3) The permit conforms to the Lyon/Fogerty decision.

CONSIDERATION:

\$254 per annum; with the State reserving the right to fix a
different rental on each fifth anniversary of the permit.

BASIS FOR CONSIDERATION:

Pursuant to 2 Cal. Code Regs. 2003.

APPLICANT STATUS:

Applicant is not the owner of the upland.

PREREQUISITE CONDITIONS, FEES AND EXPENSES:

Filing fee and estimated processing costs have been received.

STATUTORY AND OTHER REFERENCES:

A. P.R.C.: Div. 6, Parts 1 and 2; Div. 13.

B. Cal. Code Regs.: Title 3, Div. 3; Title 14, Div. 6.

AE 884:

03/18/92

OTHER PERTINENT INFORMATION:

1. Applicant is not the littoral owner. The proposed pier will extend into Donner Lake from common area littoral lands vested in the Donner Lakeside Landing Homeowners Association. Applicant is a homeowner and member of the association. The proposed permit is subject to the written consent and approval of the littoral owner.
2. Pursuant to the Commission's delegation of authority and the State CEQA Guidelines (14 Cal. Code Regs. 15025), the staff has prepared a Proposed Negative Declaration identified as EIR ND 590, State Clearinghouse No. 92023003. Such Proposed Negative Declaration was prepared and circulated for public review pursuant to the provisions of CEQA.

Based upon the Initial Study, the Proposed Negative Declaration, and the comments received in response thereto, there is no substantial evidence that the project will have a significant effect on the environment. (14 Cal. Code Regs. 15074(b))

3. This activity involves lands identified as possessing significant environmental values pursuant to P.R.C. 6370, et seq. Based upon the staff's consultation with the persons nominating such lands and through the CEQA review process, it is the staff's opinion that the project, as proposed, is consistent with its use classification.

APPROVALS OBTAINED:

California Department of Fish and Game.

FURTHER APPROVALS REQUIRED:

Lahontan Regional Water Quality Control Board and the County of Nevada.

EXHIBITS:

- A. Land Description
- B. Location Map
- C. Proposed Negative Declaration

IT IS RECOMMENDED THAT THE COMMISSION:

1. CERTIFY THAT A NEGATIVE DECLARATION, EIR ND 580, STATE CLEARINGHOUSE NO. 92023003, WAS PREPARED FOR THIS PROJECT PURSUANT TO THE PROVISIONS OF THE CEQA AND THAT THE COMMISSION HAS REVIEWED AND CONSIDERED THE INFORMATION CONTAINED THEREIN.
2. ADOPT THE PROPOSED NEGATIVE DECLARATION AND DETERMINE THAT THE PROJECT, AS APPROVED, WILL NOT HAVE A SIGNIFICANT EFFECT ON THE ENVIRONMENT.
3. AUTHORIZE ISSUANCE TO JOHN E. McAMIS AND RENEE McAMIS A TEN-YEAR GENERAL PERMIT - RECREATIONAL USE, BEGINNING MARCH 2, 1992, SUBJECT TO STAFF'S PRIOR RECEIPT OF THE LITTORAL OWNER'S WRITTEN CONSENT AND APPROVAL OF THIS PERMIT AND STRUCTURE; IN CONSIDERATION OF ANNUAL RENT IN THE AMOUNT OF \$254, WITH THE STATE RESERVING THE RIGHT TO FIX A DIFFERENT RENTAL ON EACH FIFTH ANNIVERSARY OF THE PERMIT; PROVISION OF PUBLIC LIABILITY INSURANCE FOR COMBINED SINGLE LIMIT COVERAGE OF \$500,000 FOR CONSTRUCTION AND MAINTENANCE OF A PIER UTILIZED FOR RECREATIONAL BOATING ON THE LAND DELINEATED ON EXHIBIT "A" ATTACHED AND BY REFERENCE MADE A PART HEREOF.

EXHIBIT "A"
LAND DESCRIPTION

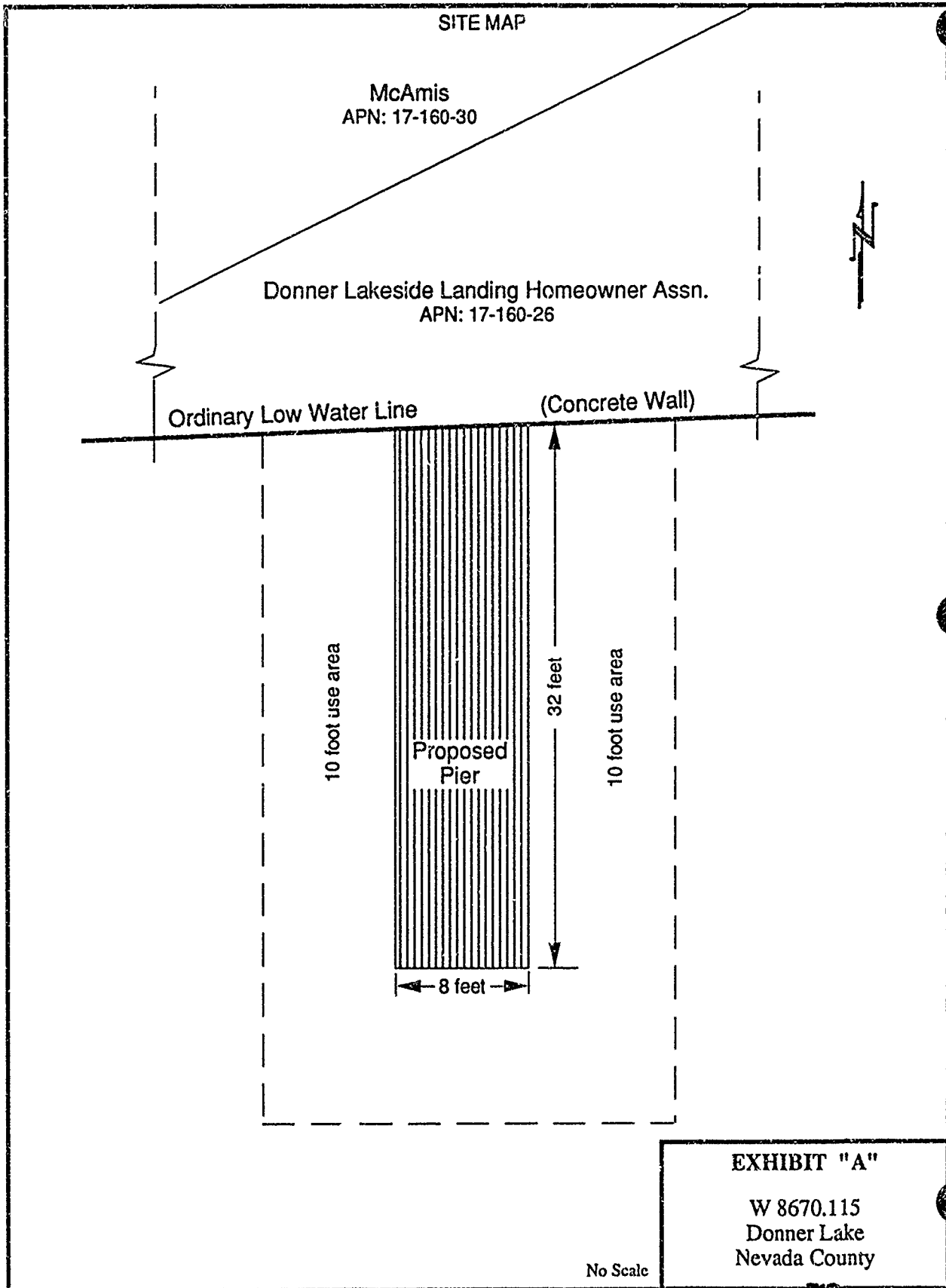

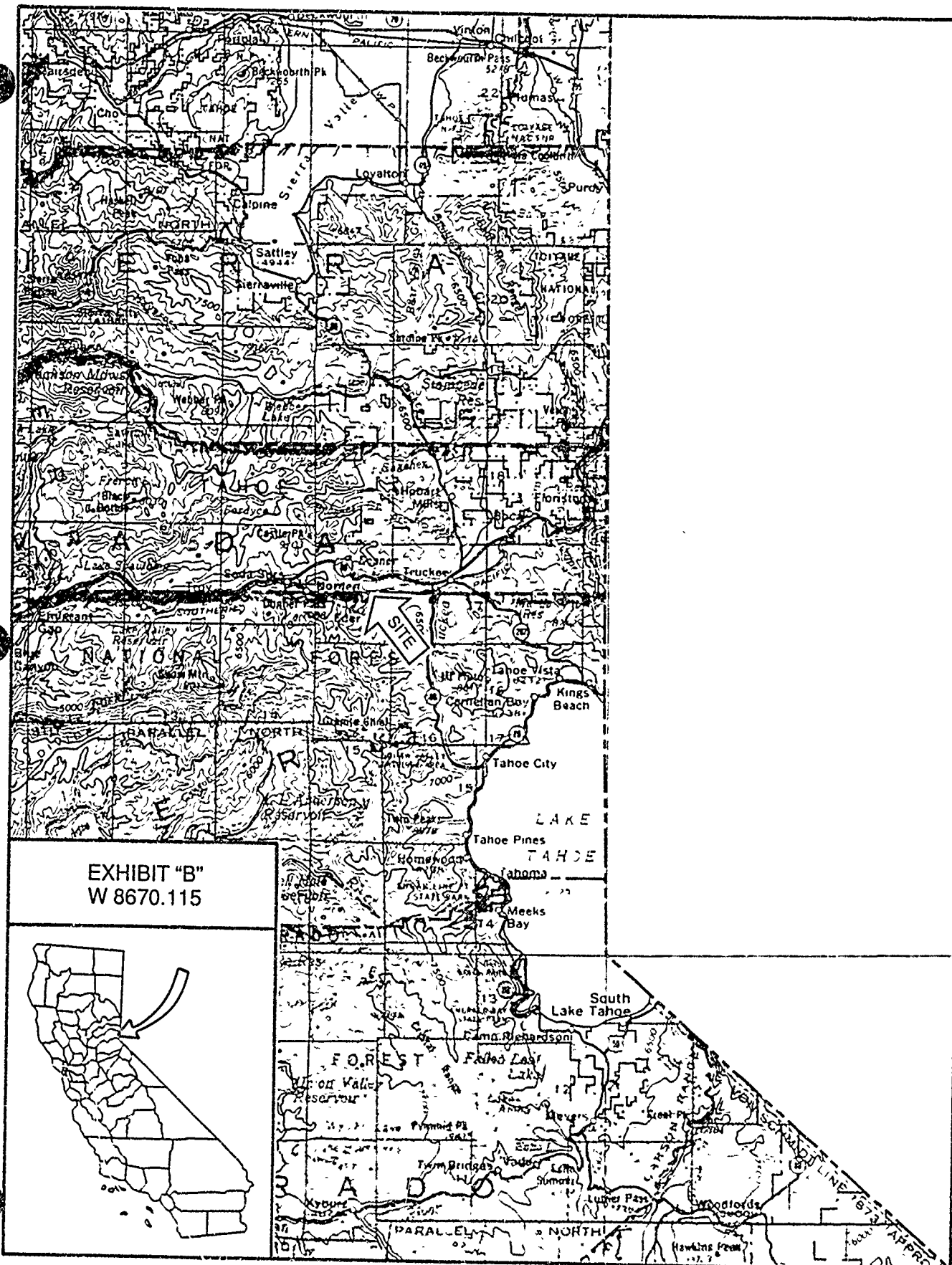

EXHIBIT "B"
W 8670.115

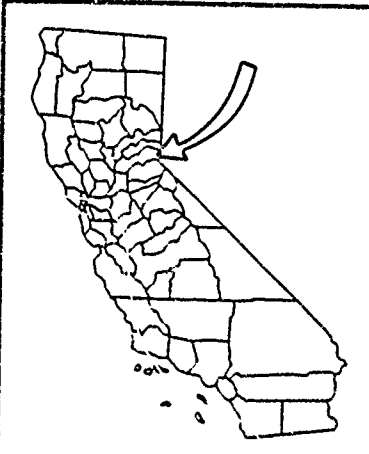

EXHIBIT "C"

REQUEST FOR SHORTENED REVIEW

Mc AMIS RECREATIONAL PIER

Exceptional Circumstances

This project is a proposed recreational pier at Donner Lake in Nevada County.

The staff of the State Lands Commission is requesting a Shortened Review pursuant to PRC Section 21091 because the project applicant is under severe time constraints with respect to his exercising available options.

The project applicant has received a Stream or Lake Alteration Permit (II-651-91) from the California Department of Fish and Game (CDFG). One of the conditions of this permit is that "work in the lake bed shall be conducted only in dry areas; concrete forms and concrete shall only be poured in leak proof forms in dry areas" (emphasis added). The CDFG permit also requires that construction be confined to the period March 1 through October 15.

Historically, the Sierra Pacific Power Company, which controls the storage and release of water from the dam at Donner Lake, has restricted the outflow from the lake on April 15. In a conversation with that agency on January 31, 1992, staff was advised that, because of the extreme drought conditions, the company will begin holding water in the lake on March 15, a month ahead of schedule. Due to the subsequent rise of the water level in the lake, the applicant will no longer be able to meet Fish and Game's condition regarding construction only in a dry area of the lake.

To ensure the applicant's ability to construct the facility in compliance with the conditions imposed by Fish and Game, the State Lands Commission must act on this application at its next meeting. While the meeting date has not yet been set, staff anticipates that a meeting will be set during the week of March 2, 1992.

A shortened review period of 21 days for the attached Initial Study/Proposed Negative Declaration will allow the Commission to consider the project and the applicant to meet the time constraints of the CDFG permit.

CALENDAR PAGE	200
MINUTE PAGE	817

Shortened Review Request Form

(To be filled out and signed by the Lead Agency and submitted with project documents to SCH)

To: State Clearinghouse
1400 Tenth Street
Sacramento, CA 95814

From: State Lands Commission
Lead Agency
1807 13th Street
Address
Sacramento, CA 95814
Phone #: (916) 324-4715

SCH # _____

Contact: _____

Project Title: Mc Amis Recreational Area

Project Location: Donner Lake Nevada
City *County*

Explain "exceptional circumstances" (CEQA, Section 15205(d)) for requesting a shortened review:

PLEASE SEE ATTACHED

List state responsible & trustee agencies, as well as any agencies that have commented on the project (Send advance copies of the document to these agencies):

Department of Fish and Game
Truckee-Donner Recreation & Park District

As designated representative for the lead agency, I verify, in their behalf, that there is no "statewide, regional, or areawide significance" to this project.

Today's date: January 31 1992

DWIGHT E. SANDERS
Print Name

Dwight E. Sanders
Signature
MINUTE PAGE 201
818

STATE LANDS COMMISSION

LEO T. McCARTHY, *Lieutenant Governor*
GRAY DAVIS, *Controller*
THOMAS W. HAYES, *Director of Finance*

EXECUTIVE OFFICE
1607 - 13th Street
Sacramento, CA 95814

CHARLES WARR
Executive Officer

January 31, 1992
File: W 8670.115
ND 580

**NOTICE OF PUBLIC REVIEW OF A PROPOSED NEGATIVE DECLARATION
(SECTION 15073 CCR)**

A Negative Declaration has been prepared pursuant to the requirements of the California Environmental Quality Act (Section 21000 et seq., Public Resources Code), the State CEQA guidelines (Section 15000 et seq., Title 14, California Code Regulations), and the State Lands Commission Regulations (Section 2901 et seq., Title 2, California Code Regulations) for a project currently being processed by the staff of the State Lands Commission.

The document is attached for your review. Comments should be addressed to the State Lands Commission office shown above with attention to the undersigned. All comments must be received by February 24, 1992.

Should you have any questions or need additional information, please call the undersigned at (916) 324-4715.

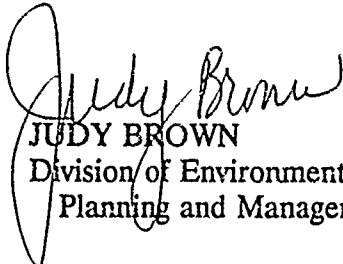
JUDY BROWN
Division of Environmental
Planning and Management

Attachment

CALENDAR PAGE -- 202
MINUTE PAGE -- 819

STATE LANDS COMMISSION

LEC T. McCARTHY, *Lieutenant Governor*
GRAY DAVIS, *Controller*
THOMAS W. HAYES, *Director of Finance*

EXECUTIVE OFFICE
1807 - 13th Street
Sacramento, CA 95814

CHARLES WARREN
Executive Officer

PROPOSED NEGATIVE DECLARATION

File: W 8670.115
ND 580
SCH No. 92023003

Project Title: McAmis Recreational Pier

Proponent: John McAmis

Project Location: Northwest shore of Donner Lake, 15837 Lakeside Landing, adjacent to APN 17-160-12, Nevada County.

Project Description: Proposed construction of an 8' x 32' recreational dock on the northwest shore of Donner Lake. Ten wooden pilings will be used to support a wooden deck. Pilings will be attached to 2'6" concrete blocks. The blocks will be placed a minimum of 18" into the lake bed. Construction will occur on the dry lake bed as water levels permit.

Contact Person: Judy Brown Telephone: 916/324-4715

This document is prepared pursuant to the requirements of the California Environmental Quality Act (Section 21000 et seq., Public Resources Code), the State CEQA Guidelines (Section 15000 et seq., Title 14, California Code Regulations), and the State Lands Commission regulations (Section 2901 et seq., Title 2, California Code Regulations).

Based upon the attached Initial Study, it has been found that:

this project will not have a significant effect on the environment.

mitigation measures included in the project will avoid potentially significant effects.

CALENDAR PAGE	203
MINUTE PAGE	820

ENVIRONMENTAL IMPACT ASSESSMENT CHECKLIST - PART II

Form 13.20 (7/82)

File Ref.: W 8670.115

I. BACKGROUND INFORMATION

A. Applicant: John McAmis
390 Honey Run Road
Chico, CA 95928

B. Checklist Date: 01 / 30 / 92

C. Contact Person: Judy Brown
Telephone: (916) 324-4715

D. Purpose: To construct a private dock for recreational purposes

E. Location: Northwest shore of Donner Lake, 15837 Lakeside Landing, adjacent to APN: 17-160-12, Nevada County

F. Description: Proposed construction of an 8' X 32', open piling recreational pier. Pilings will be attached to 2'6" concrete blocks and set in the lake bed a minimum of 18". Construction will be performed on the dry

G. Persons Contacted: lake bed when water levels permit.

Pat O'Brien
Department of Fish and Game

Karry Przetiorski
Nevada County Planning

II. ENVIRONMENTAL IMPACTS. (Explain all "yes" and "maybe" answers)

Table with 3 columns: Question, Yes, Maybe, No. Contains 7 rows of environmental impact questions with checkboxes.

B. Air. Will the proposal result in:

- 1. Substantial air emissions or deterioration of ambient air quality?
- 2. The creation of objectionable odors?
- 3. Alteration of air movement, moisture or temperature, or any change in climate, either locally or regionally?

C. Water. Will the proposal result in:

- 1. Changes in the currents, or the course or direction of water movements, in either marine or fresh waters?
- 2. Changes in absorption rates, drainage patterns, or the rate and amount of surface water runoff?
- 3. Alterations to the course or flow of flood waters?
- 4. Change in the amount of surface water in any water body?
- 5. Discharge into surface waters, or in any alteration of surface water quality, including but not limited to temperature, dissolved oxygen or turbidity?
- 6. Alteration of the direction or rate of flow of ground waters?
- 7. Change in the quantity of ground waters, either through direct additions or withdrawals, or through interception of an aquifer by cuts or excavations?
- 8. Substantial reduction in the amount of water otherwise available for public water supplies?
- 9. Exposure of people or property to water-related hazards such as flooding or tidal waves?
- 10. Significant changes in the temperature, flow or chemical content of surface thermal springs?

D. Plant Life. Will the proposal result in:

- 1. Change in the diversity of species, or number of any species of plants (including trees, shrubs, grass, crops, and aquatic plants)?
- 2. Reduction of the numbers of any unique, rare or endangered species of plants?
- 3. Introduction of new species of plants into an area, or in a barrier to the normal replenishment of existing species?
- 4. Reduction in acreage of any agricultural crop?

E. Animal Life. Will the proposal result in:

- 1. Change in the diversity of species, or numbers of any species of animals (birds, land animals including reptiles, fish and shellfish, benthic organisms, or insects)?
- 2. Reduction of the numbers of any unique, rare or endangered species of animals?
- 3. Introduction of new species of animals into an area, or result in a barrier to the migration or movement of animals?
- 4. Deterioration to existing fish or wildlife habitat?

F. Noise. Will the proposal result in:

- 1. Increase in existing noise levels?
- 2. Exposure of people to severe noise levels?

G. Light and Glare. Will the proposal result in:

- 1. The production of new light or glare?

H. Land Use. Will the proposal result in:

- 1. A substantial alteration of the present or planned land use of an area?

I. Natural Resources. Will the proposal result in:

- 1. Increase in the rate of use of any natural resources?
- 2. Substantial depletion of any nonrenewable resources?

J. *Risk of Upset.* Does the proposal result in:

Yes Maybe No

- 1. A risk of an explosion or the release of hazardous substances (including, but not limited to, oil, pesticides, chemicals, or radiation) in the event of an accident or upset conditions?
- 2. Possible interference with emergency response plan or an emergency evacuation plan?

K. *Population.* Will the proposal result in:

- 1. The alteration, distribution, density, or growth rate of the human population of the area?

L. *Housing.* Will the proposal result in:

- 1. Affecting existing housing, or create a demand for additional housing?

M. *Transportation/Circulation.* Will the proposal result in:

- 1. Generation of substantial additional vehicular movement?
- 2. Affecting existing parking facilities, or create a demand for new parking?
- 3. Substantial impact upon existing transportation systems?
- 4. Alterations to present patterns of circulation or movement of people and/or goods?
- 5. Alterations to waterborne, rail, or air traffic?
- 6. Increase in traffic hazards to motor vehicles, bicyclists, or pedestrians?

N. *Public Services.* Will the proposal have an effect upon, or result in a need for new or altered governmental services in any of the following areas:

- 1. Fire protection?
- 2. Police protection?
- 3. Schools?
- 4. Parks and other recreational facilities?
- 5. Maintenance of public facilities, including roads?
- 6. Other governmental services?

O. *Energy.* Will the proposal result in:

- 1. Use of substantial amounts of fuel or energy?
- 2. Substantial increase in demand upon existing sources of energy, or require the development of new sources?

P. *Utilities.* Will the proposal result in a need for new systems, or substantial alterations to the following utilities.

- 1. Power or natural gas?
- 2. Communication systems?
- 3. Water?
- 4. Sewer or septic tanks?
- 5. Storm water drainage?
- 6. Solid waste and disposal?

Q. *Human Health.* Will the proposal result in:

- 1. Creation of any health hazard or potential health hazard (excluding mental health)?
- 2. Exposure of people to potential health hazards?

R. *Aesthetics.* Will the proposal result in:

- 1. The obstruction of any scenic vista or view open to the public, or with the proposal result in the creation of an aesthetically offensive site open to public view?

S. *Recreation.* Will the proposal result in:

- 1. An impact upon the quality or quantity of existing recreational opportunities?

T. Cultural Resources.

Yes Maybe No

- 1. Will the proposal result in the alteration of or the destruction of a prehistoric or historic archeological site?
- 2. Will the proposal result in adverse physical or aesthetic effects to a prehistoric or historic building, structure, or object?
- 3. Does the proposal have the potential to cause a physical change which would affect unique ethnic cultural values?
- 4. Will the proposal restrict existing religious or sacred uses within the potential impact area?

U. Mandatory Findings of Significance.

- 1. Does the project have the potential to degrade the quality of the environment, reduce the habitat of a fish or wildlife species, cause a fish or wildlife population to drop below self-sustaining levels, threaten to eliminate a plant or animal community, reduce the number or restrict the range of a rare or endangered plant or animal or eliminate important examples of the major periods of California history or prehistory?
- 2. Does the project have the potential to achieve short term, to the disadvantage of long-term, environmental goals?
- 3. Does the project have impacts which are individually limited, but cumulatively considerable?
- 4. Does the project have environmental effects which will cause substantial adverse effects on human beings, either directly or indirectly?

III. DISCUSSION OF ENVIRONMENTAL EVALUATION (See Comments Attached)

IV. PRELIMINARY DETERMINATION

On the basis of this initial evaluation:

- I find the proposed project COULD NOT have a significant effect on the environment, and a NEGATIVE DECLARATION will be prepared.
- I find that although the proposed project could have a significant effect on the environment, there will not be a significant effect in this case because the mitigation measures ~~described on an attached sheet~~ ^{proposed.} have been added to the project. A NEGATIVE DECLARATION ~~will be prepared.~~ has been prepared.
- I find the proposed project MAY have a significant effect on the environment, and an ENVIRONMENTAL IMPACT REPORT is required.

Date: 01 31 / 92

Judy Brown
For the State Lands Commission
Judy Brown

CALENDAR PAGE	207
MINUTE PAGE	Form 13.20 004

Project Description

This project proposes the construction of a 10 piling recreational pier, 8' wide by 32' in length, to be located waterward of APN: 17-160-12, 15837 Lakeside Landing, on the northwestern shore of Donner Lake, Nevada County.

The pier will be attached to the upland by a post and beam wood frame adjacent to the existing concrete retaining wall separating the lake from the upland. The pier pilings will be set in 2'6" steel drums filled with concrete which will rest in the lake bed. The holes for the pilings will be dug by hand tools to a minimum depth of 18". The pilings will be set in 2'6" steel drums filled with concrete prior to being placed into the lake bed. The deck will be constructed of wood material. The proposed construction will take place within Donner Lake at its lowest water level. The Department of Fish and Game will be notified prior to the commencement of construction. The pier pilings will not be treated with wood preservatives. No treated material will be used that might come in contact with the lake water.

Environmental Setting

The shore area of the proposed project site contains a concrete wall which fronts four lots within this area. The wall existed prior to applicant's acquisition of the upland property. Two other single-family dwellings exist along this segment of the shoreline to the west.

Immediately east of the proposed project site lies a vacant lot. Approximately 100 feet to the east of the proposed project location is a recreational pier and gazebo used by the Donner Pines West Recreation Association.

The Truckee-Donner Recreation District owns and operates a public day use area located approximately 260' to the west of the proposed project. Uses of the day area include, shoreline fishing, a delineated swimming area, power and manually-operated boats and floating devices, and sunbathing.

The existing recreational uses of the lake within the proposed project are seasonal and may include swimming, use of recreational floating devices, boating, shoreline fishing and trolling.

III. DISCUSSION OF ENVIRONMENTAL EVALUATION
MCAMIS RECREATIONAL PIER

A. Earth

1. Earth Conditions

The project involves construction of an 8' x 32' open piling recreational pier. This construction will not cause unstable earth conditions or changes in the geologic substructure of the project site.

2. Compaction, Overcovering of the Soil

The proposed pier pilings will be set in 2'6" steel drums filled with concrete which will cover and compact the soil where they rest on the bed of Donner Lake. This impact is not considered to be significant.

3. Topography

This project would not involve grading or the placement of fill upon the ground surface. There will be no impact to the existing topography of the project site.

4. Unique Features

This proposed project is designed with open construction to reduce impacts on the lake bed. The shore has been modified with a rock retaining wall. This project would not involve the placement of fill into the bed of Donner Lake. This project will not have an impact on unique features.

5. Erosion

The proposed pier is of open piling design. Pier pilings will be set in 2'6" steel drums filled with concrete which will rest in the lake bed. The construction and placement of this pier will not increase wind or water erosion of soils.

6. Siltation

The proposed project would be constructed on the dry lake bed during low water levels. Water level rise might cause minor siltation after the project is completed. Some minor prevailing currents may exist during normal lake levels but the accrual of silts will be minimal.

7. Geologic Hazards

The pilings for the proposed project would be set in 2'6" steel drums filled with concrete which will rest in the lake bed and upon the shore by the retaining wall. The depths of installation will be shallow and should not induce seismic instabilities or ground failures. No impacts are expected.

B. Air

1. Emissions

The pier will be constructed with hand tools. Construction crew will arrive to the project site via existing improved roads on the upland. Some emissions will result from the arrival and departure of construction vehicles to the upland site. This impact will be small and temporary, lasting during the construction of the pier. Emissions may be generated from fuel-powered boats which may use the pier but this will be an ongoing impact to the Donner Lake area.

2. Odors

The construction activity will create some odors from crew vehicles arriving to and leaving the project site. This impact will not be significant and will be temporary, lasting until construction is completed. Use of the pier may create some odors as fuel-powered boats arrive and leave the pier site. This impact will be minimal.

C. Water

1. Currents

The proposed pier would be constructed with an open piling design. This design will not create a significant impact on currents or water movements.

2. Runoff

The proposed pier would be placed within the body of Donner Lake. It will not affect existing surface water drainage patterns.

3. Flood Waters

The proposed pier would be placed within the body of Donner Lake. It will not affect flood waters from streamflows.

4. Surface Water

The proposed pier would be placed within the body of Donner Lake. The pilings will not affect the surface water volume of Donner Lake.

5. Turbidity

The proposed pier would be constructed on the dry lake bed when water levels are at their lowest, and as indicated by the Department of Fish and Game. Turbidity may arise from disturbed sediments settling as the lake water rises. Some sediments may be disturbed from boat movements at the pier. These impacts should be minimal.

6. Ground Water Flows

The proposed pier will be set at relatively shallow depths. They should not affect ground water flows.

7. Ground Water Quantity

The proposed pier will be set at relatively shallow depths and would not serve as water acquisition facilities. It should not affect ground water supplies.

8. Water Supplies

The proposed pier would not serve as water acquisition facilities. It should not affect water supplies.

9. Flooding

The cumulative volume of the pier pilings would not induce flooding. The structure would not interfere with water movements to induce flooding.

10. Thermal Springs

There are no known thermal springs within the vicinity of this project. There should be no impact upon any thermal springs.

D. Plant Life

1. Species Diversity

Introduction of the structure could furnish a new substrate for sessile aquatic plants. This impact would be minimal as this site is dominated by a cobble substrate and can furnish habitat for sessile aquatic plants currently. A rock retaining wall exists between the upland property and normal lake levels. Small amounts of seasonal grasses grow along the retaining wall. Some disturbance to these grasses may occur during the placement of posts and concrete footings to the shore area. No other plant life would be impacted.

2. Endangered Species

No unique, rare or endangered species of plants would be impacted as none have been identified for the Donner Lake area.

3. Introduction of Plants

This proposal does not include landscaping which would introduce new plants to the project site.

4. Agricultural Crops

The proposed pier would be located in Donner Lake. No agriculture or aquaculture are carried out in this area. There would be no impact.

E. Animal Life

1. Species Diversity

The proposed pier pilings and concrete footings could affect access to the lake bottom by burrowing organisms. This would not be a new impact as other piers exist within the vicinity to the east of the project site. The construction activity would occur on the dry lake bed when water levels within the lake are at their lowest. The pier is proposed to be constructed in an area east of an identified shoreline fishing area. The use of this pier may cause fish dispersal during the use of boats arriving and leaving the pier; however, recreational use of the pier should not cause fish mortality.

2. Rare Species

No impacts to rare species of animals is anticipated as none have been identified for the Donner Lake area.

3. New Species

The proposed pier construction will introduce fish feeding habitat to this site. The impact will be minimal. No new animal species would be introduced as a result of this project.

4. Habitat Deterioration

The proposed project involves construction of a new recreational pier at the site. This project would be constructed on the dry lake bed when water levels of the lake are at their lowest. No impact to animal habitat is anticipated from construction. During the use of fuel-powered boats at the proposed pier site, fish would disperse; however, there should be no significant impact to water quality that would affect fish habitat over the long term resulting from this project.

F. Noise

1. Increases

The construction of the proposed pier would involve a period of moderate noise levels. Noise from work crew vehicles arriving and leaving the site will occur at the beginning and ending of work days. Use of the pier by motorized boats would also cause a temporary increase in noise levels. These occurrences would be brief and minimal.

2. Severe Noise

No severe noise levels are anticipated from the proposed construction and placement of the proposed pier.

G. Light and Glare

1. The proposed project would be constructed during daylight hours. No lighting for construction activity would occur. No navigational lighting on the pier is proposed. No reflections or glare would be created from the proposed finished surfaces. No light or glare impacts are anticipated.

H. Land Use

1. The land use designations for Donner Lake are primarily residential with some commercial and open space zoning areas. The proposed project site is located in an area zoned residential use and is consistent with that land use classification.

I. Natural Resources

1. Increase in Use

The proposed pier construction and use would not propose consumptive uses of natural resources.

2. Depletion of any Nonrenewable Resources

The proposed pier construction would not increase resource depletion or loss of non-renewable resources. The pier would be used only for private recreational purposes.

J. Risk of Upset

1. Risk of Explosion

Explosion of fuel could occur during operation of motorized boats at the proposed pier site. This possibility would be remote. The proposed construction of the project would not include the use or storage of hazardous substances. No impacts are anticipated.

2. Emergency Response Plan

The proposed project would not interfere with any emergency response plan, as it is proposed to be constructed in the shorezone of Donner Lake, and will not extend an unusual distance out into the body of the lake.

K. Population

1. The proposed project would not include residential development or commercial facilities which would affect the alteration or distribution, density or growth rate of the population of the area.

L. Housing

1. A single-family dwelling exists on the immediate upland lot from the proposed project site. Other dwellings exist along the shoreline of Donner Lake within this area. This project would not create a demand for additional housing.

M. Transportation/Circulation

1. Vehicular Movement

The construction of the proposed pier may cause a minor additional amount of traffic as the construction crew arrives and leaves the project site. This impact would be insignificant and temporary. The proposed pier is intended for applicant's use. A single-family dwelling exists on the immediate upland lot which provides for parking for the dwelling. No new vehicular traffic would result from the use of the proposed pier.

2. Parking

Refer to M.1., above.

3. Transportation Systems

The proposed project would not create new impacts on existing or future transportation systems for this area. The proposed pier is not for commercial use.

4. Circulation

The proposed pier would be located toward the northwest end of Donner Lake, within 100 feet to the west of an existing pier with a gazebo. The nearest waterward facility to the west would be approximately 260 feet where a seasonal swim line is placed by the Truckee Donner Park and Recreation District to delineate a public swimming area. A speed limit buoy exists within a short distance from the shore in this area to protect the public swim area, and to reduce interference with topline trollers who fish the extreme northwest corner of the lake. The shoreline fishing area is immediately east and adjacent to the Truckee-Donner Park and Recreation District swim area, and approximately 200 feet to the west of the proposed project.

Existing trollers must avoid the existing pier and gazebo located approximately 100 feet to the east of the proposed project site. Construction and placement of the proposed pier may have a small impact on existing navigational uses of the shoreline; however, this impact is considered to be insignificant.

Semi-annually, the Truckee-Donner Recreation District hosts a public swimathon which begins at the west end of the lake and ends at the east end of the lake. These two events attract large numbers of the public which would utilize the shallow areas adjacent to the shore for swimming. Inexperienced swimmers using the shallow water areas of the shoreline would be affected by the proposed pier and would need to swim around it. This pier would add to the cumulative impact of piers which exist along the shoreline of Donner Lake to swimmers during this event, but would not be a new impact.

5. Traffic

The proposed pier would affect boat traffic, driving it waterward to avoid collision with the structure. Waterskiing must be conducted out into the water beyond the speed limit buoy, so there would be no affect to waterskiing. Topline trolling must avoid the existing pier with gazebo, located approximately 100 feet to the east of the proposed project. This impact is considered to be insignificant.

6. Traffic Hazards

This proposed project would not include any development which would affect existing roadways, bike lanes, or pedestrian walkways.

N. Public Services

1. This proposed project would not increase the existing need for fire protective services for this area.
2. This proposed project would not increase the existing need for police protective services for this area.
3. This proposed project would not include a residential structure or multi-dwelling unit which would create a demand for new schools.

4. The proposed project is located approximately 260' east of the Truckee-Donner Recreation District's public day use area. A 5 mph speed limit buoy is located with the waterway and to the west of this project. The proposed dock is for private recreational use of the applicant and would not generate significant boating traffic. The construction and use of this proposed dock would not have a significant impact on the public use area.

Q. Human Health

1. Health hazard

This project would not directly create any health hazard to the public.

2. Exposure of people to health hazards

Swimmers use the shoreline of Donner Lake for a semi-annual swim event which begins on the west end of the lake and ends on the east end of the lake. This pier would add to the effect which all existing piers along the shoreline have on swimmers for this event.

R. Aesthetics

1. The proposed pier will be located approximately 100 feet west of an existing pier. The nearest waterward facility west of the proposed pier would be the Truckee Donner Recreation District swim area, located approximately 260 feet in distance. There are numerous recreational piers farther to the east of the proposed structure and around the shoreline of Donner Lake. The material composition of the proposed dock is of wood material, and the design is an 8' x 32' dock.

CALENDAR PAGE	217
EXHIBIT PAGE	834

S. Recreation

1. Seasonal recreational opportunities within Donner Lake include swimming, tube and mattress floating, boating, windsurfing, jetskiing, fishing and sunbathing. The uses of the shore within the area of the proposed project would be trolling, windsurfing, and tube and mattress floating. There are three known public access areas on the lake. In addition, the Department of Fish and Game periodically stock the lake with fish to enhance angling opportunities. The proposed construction and use of this pier would not have a significant impact on these uses, as these opportunities are available throughout many areas of the lake.

T. Cultural Resources

1. Archaeological site

A cultural resources information search was conducted by the County for the subdivision of the upland parcel, which indicated no cultural resources were identified. There would be no impact to cultural resources resulting from the proposed project.

2. Historic Buildings

The proposed project involves the construction and use of a private recreational pier to be placed within the body of the lake. This project would not affect any prehistoric structures or objects.

3. Ethnic Cultural Values

Refer to T.1., above.

4. Religious/Sacred Uses

Refer to T.1., above.

U. Mandatory Findings of Significance

1. Degrade the Quality of the Environment

The proposed project by itself would not significantly affect fish, wildlife or plants, as discussed in the impact categories above.

2. Short-Term Vs. Long-Term Environmental Goals

This project would cumulatively contribute to the shoreline density of this lake. However, the size and shape of the proposed pier within this segment of the shoreline of Donner Lake would not have a significant aesthetic impact. The applicant is not seeking to build the entire length of available shoreline frontage. In addition, Nevada County has taken steps to require the public to obtain regulatory permits for extended seasonal mooring of boats in Donner Lake. This proposed project would not jeopardize long-term goals of protecting the environmental integrity of Donner Lake.

3. Cumulative

Refer to response T.2, above.

4. Adverse Effects on Human Beings

The proposed project would be located in a navigational area which is identified for significantly-reduced boating speeds. An established public use area exists farther to the west of this project which contains a floating swim line delineating the extent of the public swim area. Boating access to and from the pier would be directed to and from the east. This proposed project would be compatible with existing recreational uses of Donner Lake.

robert e. crippen, architect
 New DOCK for
 JOHN McAMIS
 Lot 4 DONNER LAKESIDE LANDS, Donner Lake
 Nevada County, CA.

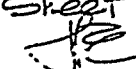
james t. crippen, architect
 Aug 1991
 Sheet 1 of 5

PORTION of PARCEL 17-160-12
 SINGLE DOCK

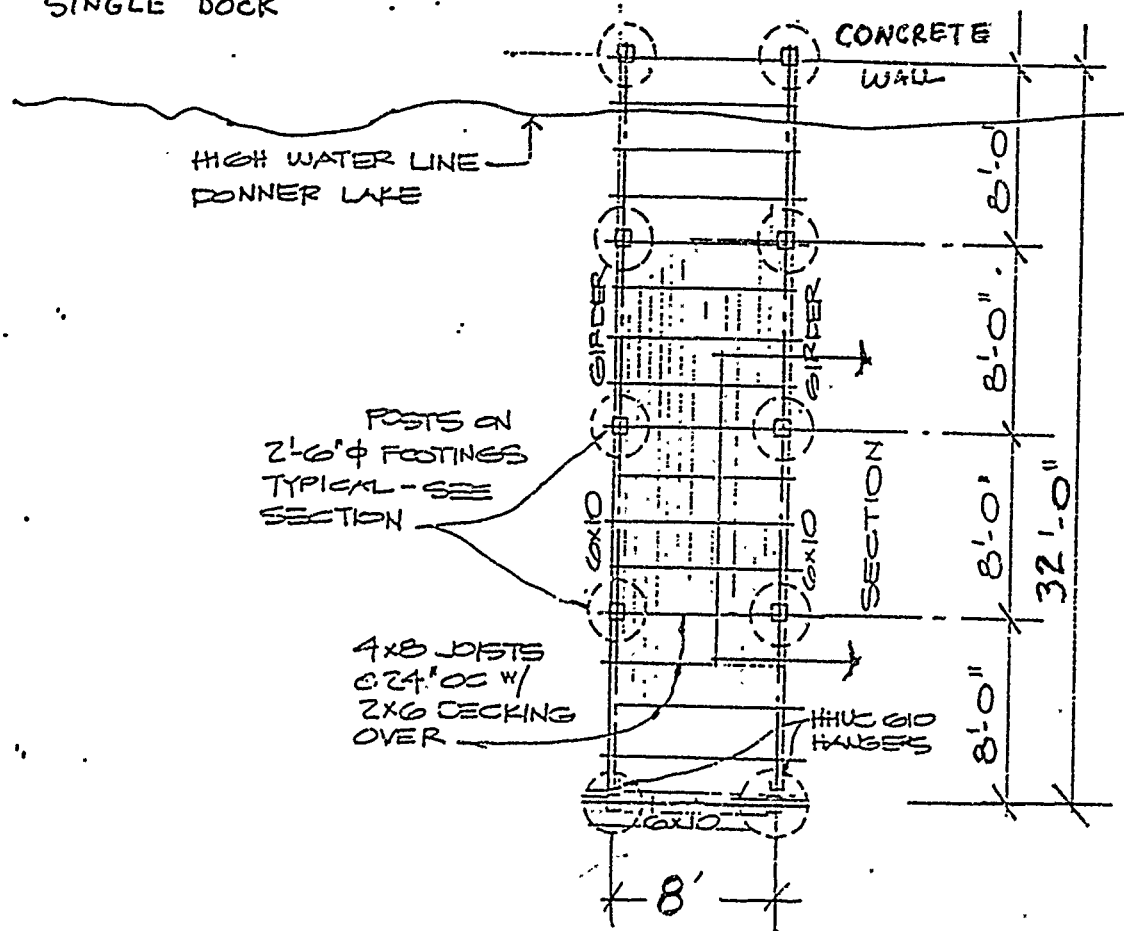

PLAN



 NORTH

p.o. box 8095 • truckee, california 95737 • phone (916)-587-4494

CALENDAR PAGE	220
MINUTE PAGE	837

EMERSON CO

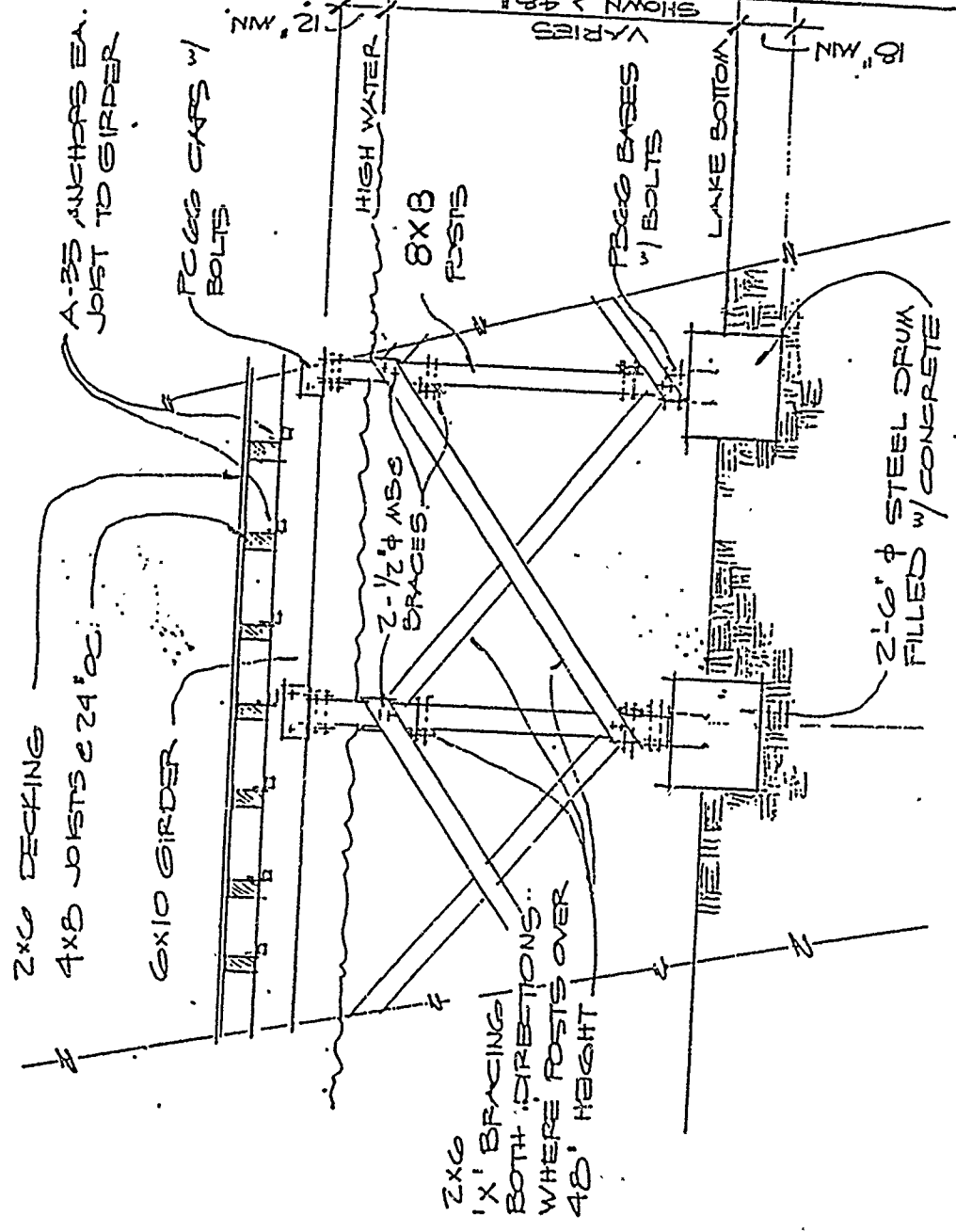
NEVADA COUNTY, CA



CALIFORNIA REGIONAL WATER QUALITY CONTROL BOARD—
LAHONTAN REGION

2092 LAKE TAHOE BOULEVARD
P.O. BOX 9428
SOUTH LAKE TAHOE, CALIFORNIA 95731-2428
(916) 544-3481



April 19, 1990

John and Renee McAmis
390 Honey Run Road
Chico, CA 95928

Dear Mr. & Mrs. McAmis:

REINSTATEMENT OF THE GENERAL WAIVER OF REPORT OF WASTE DISCHARGE
FOR PIER CONSTRUCTION FOR A PROPOSED PIER IN DONNER LAKE, 15837
LAKESIDE LANDING -- NEVADA COUNTY APN 17-160-12

On March 28, 1990 we revoked a General Waiver of Report of Waste
Discharge for pier construction based on the following two
reasons:

1. You did not submit any information that demonstrated the use of Best Management Practices during construction to keep suspended earthen materials out of Donner Lake.
2. You proposed to use preservatives on submerged pier members.

Since the above two items would have adversely impacted the water quality of Donner Lake, the general pier waiver was revoked.

On April 2, 1990 you wrote us a letter stating the following:

1. "(The) proposed pier construction will take place when Donner Lake is at its' lowest level. There will be no construction or construction activity in the lake water."
2. "No treated material will be used that might come in contact with lake water."

Based on the information submitted in your April 2, 1990 letter, the pier project appears to comply with our general pier waiver and that waiver is reinstated for your project.

John and Renee McAmis

-2-

If you have any questions, please contact Kevin Kratzke, Water Resource Control Engineer, or Ranny Eckstrom, Senior Water Resource Control Engineer at this office.

Sincerely,

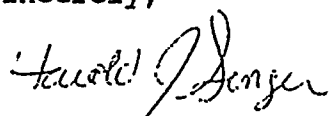

HAROLD J. SINGER
EXECUTIVE OFFICER

cc: California Department of Fish & Game/Region 2
U.S. Army Corps of Engineers/Sacramento
Nevada County Planning Department/Tom Parillo
State Lands Commission/Judy Ludlow

KEK/sh

CALENDAR PAGE	223
TELEPHONE PAGE	840

322-3568

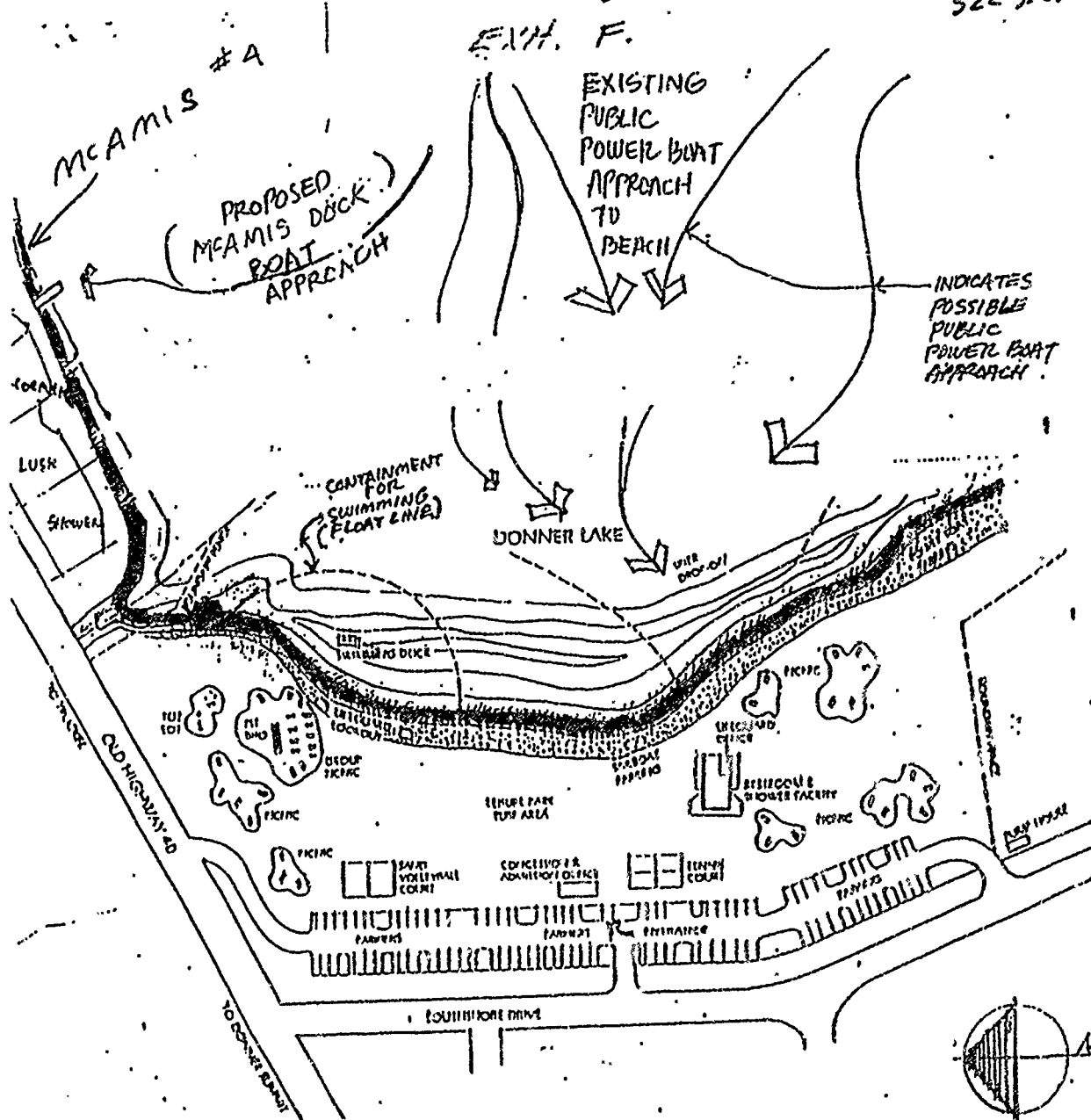

Nestled along the west shore of Donner Lake, this 10 acre beach facility offers excellent picnic and barbecue areas for the family or large groups. The swim area at the beach is supervised by well-trained and accredited lifeguards.

(MAP OF BEACH AREA FACILITIES IS FROM THE TRUCKEE-DONNER REC. PARK DISTRICT.)

McAmis

SCALE IS APPROXIMATE... FOR ILLUSTRATIVE PURPOSES ONLY