

MINUTE ITEM

This Calendar Item No. C12
was approved as Minute Item
No. 12 by the State Lands
Commission by a vote of 2
to 0 at its 3/23/82
meeting.

CALENDAR ITEM

C 1 2

3/23/82
W 22967
Louie
PRC 6128

APPROVAL OF PUBLIC AGENCY PERMIT
AND RIGHT-OF-WAY MAP

APPLICANT: California Department of Transportation
1120 N Street
Sacramento, California 95814
Attention: Mr. F. L. McWalters

AREA, TYPE LAND AND LOCATION: Sovereign lands as they may lie within
the right-of-way shown on Exhibit "A" attached.

LAND USE: Highway purposes pursuant to Section 101.5
of the Streets and Highways Code, specifically
reconstruction and protection of Route 1,
in Monterey County.

TERM: Indefinite period from March 1, 1982.

CONSIDERATION: As set forth by Section 101.5, Streets
and Highways Code and the public use and
benefit.

STATUTORY AND OTHER REFERENCES:

- A. P.R.C.: Div. 6, Parts 1 and 2; Div. 13.
- B. Cal. Adm. Code: Title 2, Div. 3; Title 14,
Div. 6.
- C. Section 101.5 of the Streets and Highways
Code.

AB 884: N/A.

OTHER PERTINENT INFORMATION:

- 1. The annual rental value of the site
is estimated to be \$100.
- 2. This project is exempt from CEQA pursuant
to 14 Cal. Adm. Code, Div. 6, Section
15101 (repair of highway) and Section
15104 (minor land alteration).

EXHIBITS:

- A. Right-of-Way Map.
- B. Location Map.

A 29

S 17

CALENDAR ITEM NO. C 1 2 (CONTD)

IT IS RECOMMENDED THAT THE COMMISSION:

1. DETERMINE THAT AN ENVIRONMENTAL DOCUMENT HAS NOT BEEN PREPARED FOR THIS ACTIVITY AS SUCH DOCUMENT IS NOT REQUIRED UNDER THE PROVISIONS OF P.R.C. 21084, 14 CAL. ADM. CODE 15100 ET SEQ., AND 2 CAL. ADM. CODE 2905.
2. APPROVE THE MAP FILED BY CALIFORNIA DEPARTMENT OF TRANSPORTATION, PURSUANT TO SECTION 101.5 OF THE STREETS AND HIGHWAYS CODE, AS SHOWN ON EXHIBIT "A" ATTACHED AND BY REFERENCE MADE A PART HEREOF.
3. AUTHORIZE THE ISSUANCE TO CALIFORNIA DEPARTMENT OF TRANSPORTATION OF A PUBLIC AGENCY PERMIT FOR AN INDEFINITE PERIOD BEGINNING MARCH 1, 1982, FOR HIGHWAY PURPOSES ON THE LAND SHOWN ON EXHIBIT "A".

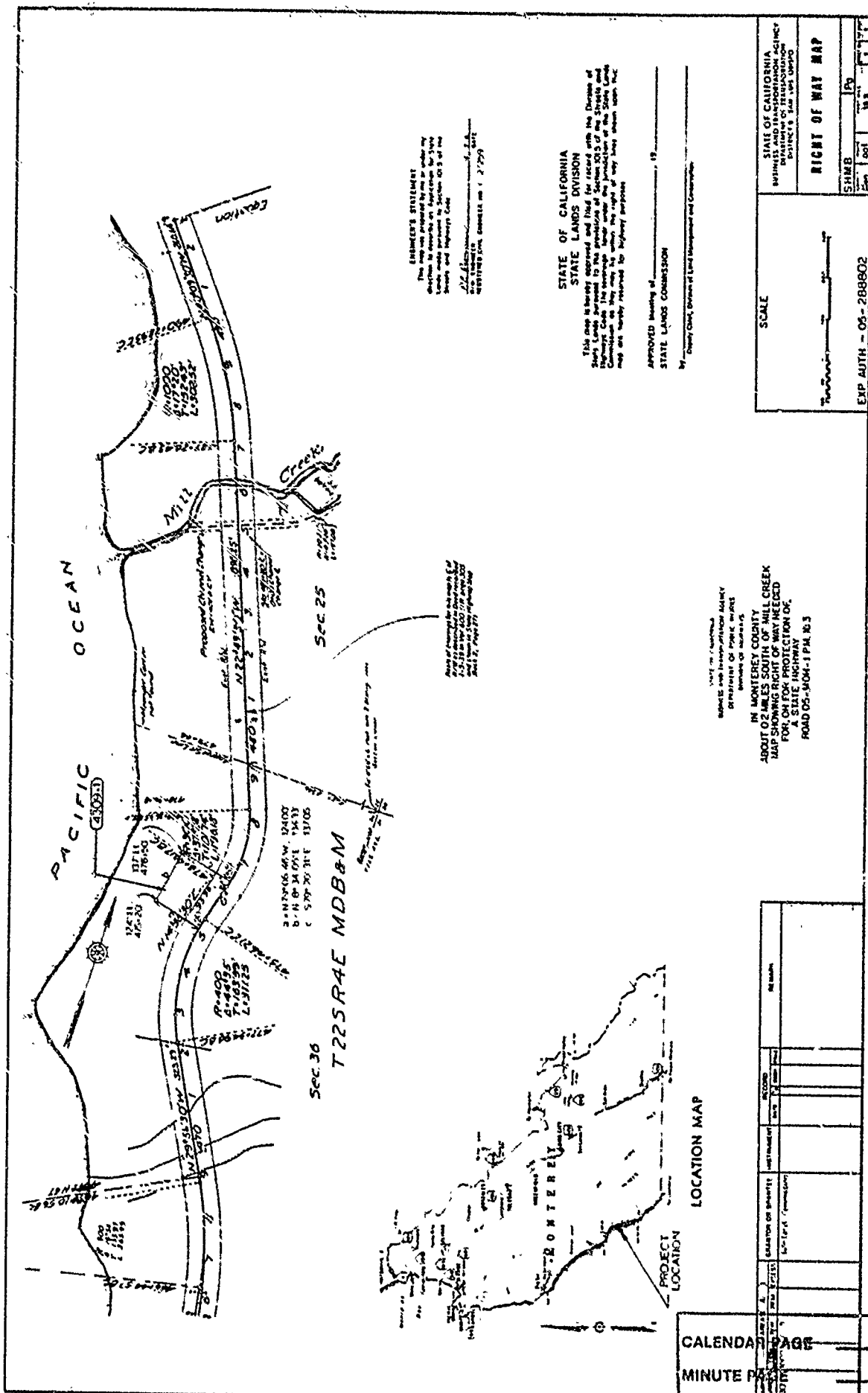

EMPHATIC STATEMENT
 This map is hereby approved and filed for record with the Director of State Lands, pursuant to the provisions of Section 205 of the Streets and Highways Code, and the approval of the State Lands Commission on the map by the Director of State Lands, and the map is hereby returned to the applicant.

STATE OF CALIFORNIA
 STATE LANDS DIVISION

APPROVED bearing of _____ 19 _____
 STATE LANDS COMMISSION

By: _____
 Deputy Clerk, Division of Land Management and Conservation

SCALE		STATE OF CALIFORNIA HIGHWAYS AND TRANSPORTATION AGENCY DIVISION OF LAND MANAGEMENT AND CONSERVATION	
RIGHT OF WAY MAP		SHMB	PO
EXP AUTH - 06-288902		1981	1981

IN MONTEREY COUNTY
 ABOUT 0.2 MILES SOUTH OF MILL CREEK
 MAP SHOWING RIGHT OF WAY HEREED
 FOR A STATE HIGHWAY
 ROAD 06-304-1 P.M. 10.3

DATE	BY	REVISION

CALENDAR	PAGE	34
MINUTE PAGE		602

EXHIBIT "A"

LAND DESCRIPTION

W 22967

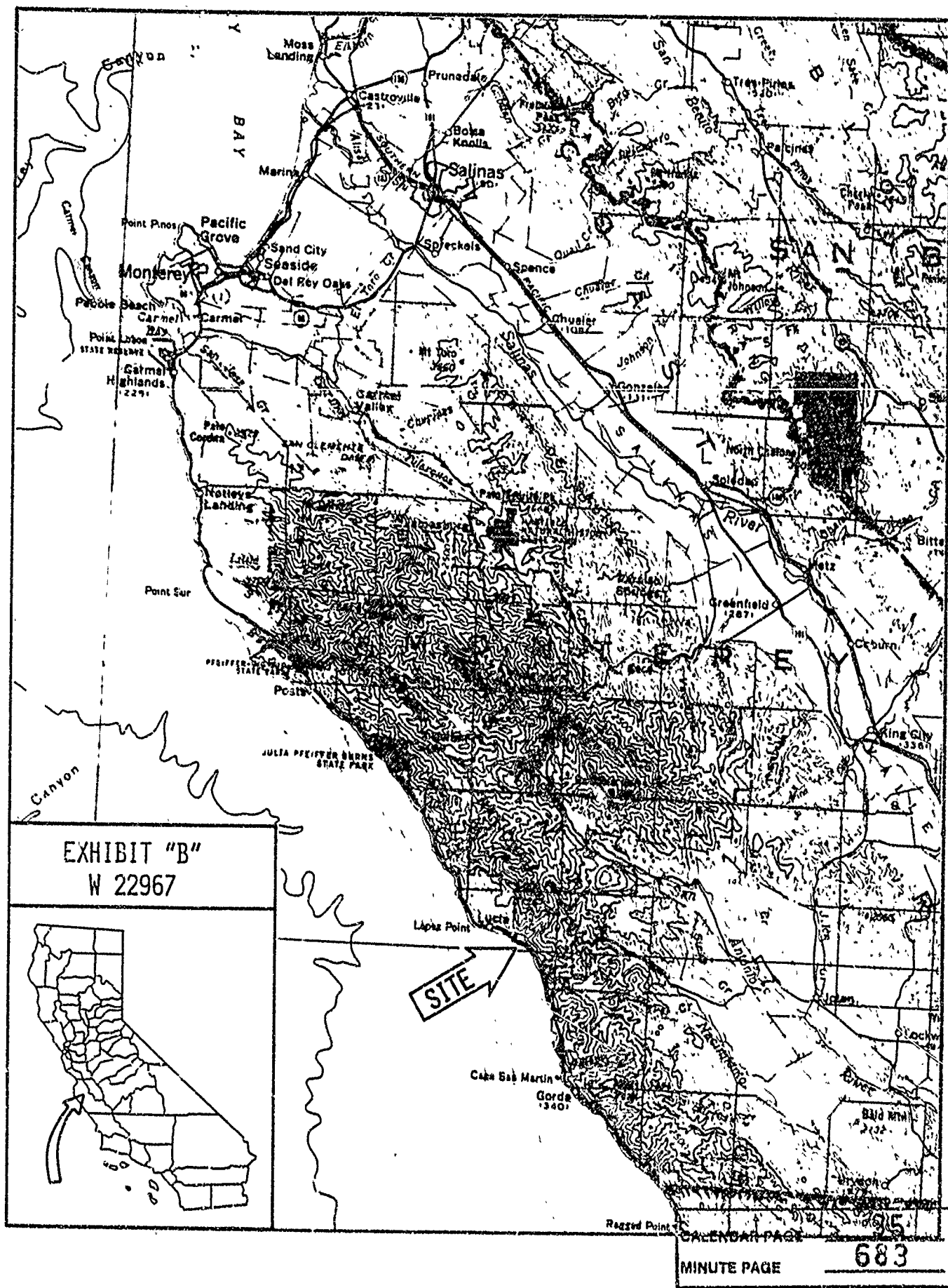

EXHIBIT "B"
W 22967



SITE

MINUTE PAGE 683