

MINUTE ITEM

This Calendar Item No. C5  
was approved as Minute Item  
No. 5 by the State Lands  
Commission by a vote of 3  
to 0 at its 4-7-81  
meeting.

CALENDAR ITEM

2005

3/81  
W 22651  
Gordon  
ERC 5973

GENERAL LEASE - RIGHT-OF-WAY USE

APPLICANT: Pacific Gas & Electric Company  
P. O. Box 7444  
Sacramento, California 95826

AREA, TYPE LAND AND LOCATION:  
A 0.138-acre parcel of submerged lands  
in the San Joaquin River near Stevinson,  
Merced County.

LAND USE: Construction and maintenance of a 12 KV  
distribution, overhead pole line utilized  
for the transmission of electric energy.

TERMS OF PROPOSED LEASE:

Initial period: 49 years from March 1,  
1981.

Public liability insurance: Combined single  
limit coverage of \$2,000,000  
per occurrence for bodily  
injury and property damage.

CONSIDERATION: \$100 per annum with the State reserving  
the right to fix a different rental on  
each fifth anniversary of the lease.

BASIS FOR CONSIDERATION:

Pursuant to 2 Cal. Adm. Code 2005.

PREREQUISITE TERMS, FEES AND EXPENSES:

Applicant is permittee of upland.

Filing fee has been received.

STATUTORY AND OTHER REFERENCES:

A. P.R.C.: Div. 6, Parts 1 & 2; Div. 13.

B. Cal. Adm. Code: Title 2, Div. 3; Title 14,  
Div. 6.

A 27

S 14

CALENDAR ITEM NO. C 0 5 (CONT'D)

OTHER PERTINENT INFORMATION:

1. Applicant proposes to immediately serve irrigation pumps essential to the production of wheat and rice. The completed facilities are anticipated to eventually serve as a tie line in the future development of the adjacent area.
2. The project is exempt from CEQA pursuant to 2 Cal. Adm. Code 2907 and 14 Cal. Adm. Code 15103, Class 3: New Construction of Small Structures.
3. This project is situated on State land identified as possessing significant environmental values pursuant to P.R.C. 6370.1, and is classified in a use category, Class B, which authorizes Limited Use.

Staff has coordinated this project with those agencies and organizations which nominated the site as containing significant environmental values. They have found this project to be compatible with their nomination.

APPROVALS REQUIRED AND OBTAINED:

This project is subject to the jurisdiction of the United States Army Corps of Engineers, California Department of Fish and Game, California Central Valley Regional Water Quality Control board, California Reclamation Board and the County of Merced. The proposed lease is conditioned on the approval of all agencies having jurisdiction.

EXHIBITS:           A. Land Description.    B. Location Map.

IT IS RECOMMENDED THAT THE COMMISSION:

1. DETERMINE THAT AN ENVIRONMENTAL DOCUMENT HAS NOT BEEN PREPARED FOR THIS ACTIVITY AS SUCH DOCUMENT IS NOT REQUIRED UNDER THE PROVISION OF P.R.C. 21084, 14 CAL. ADM. CODE 15100 ET SEQ., AND 2 CAL. ADM. CODE 2907.

CALENDAR ITEM N<sup>o</sup>. C 0 5 (CONTD)

2. FIND THAT GRANTING OF THE LEASE WILL HAVE NO SIGNIFICANT EFFECT UPON ENVIRONMENTAL CHARACTERISTICS IDENTIFIED PURSUANT TO SECTION 6370.1, OF THE P.R.C.
3. AUTHORIZE ISSUANCE TO PACIFIC GAS AND ELECTRIC COMPANY OF A 49-YEAR GENERAL LEASE - RIGHT-OF-WAY USE FROM MARCH 1, 1981; IN CONSIDERATION OF ANNUAL RENT IN THE AMOUNT OF \$100, WITH THE STATE RESERVING THE RIGHT TO FIX A DIFFERENT RENTAL ON EACH FIFTH ANNIVERSARY OF THE LEASE; AND WITH PROVISION OF PUBLIC LIABILITY INSURANCE IN THE AMOUNT OF \$2,000,000 PER OCCURRENCE OF COMBINED SINGLE LIMIT COVERAGE FOR BODILY INJURY AND PROPERTY DAMAGE; FOR CONSTRUCTION AND MAINTENANCE OF A 12 KV DISTRIBUTION OVERHEAD POLE LINE UTILIZED FOR THE TRANSMISSION OF ELECTRIC ENERGY ON THE LAND DELINEATED IN EXHIBIT "A" ATTACHED AND BY REFERENCE MADE A PART HEREOF.

CALENDAR PAGE	033
MINUTE PAGE	480

# EXHIBIT "A"

## LAND DESCRIPTION

W 22651

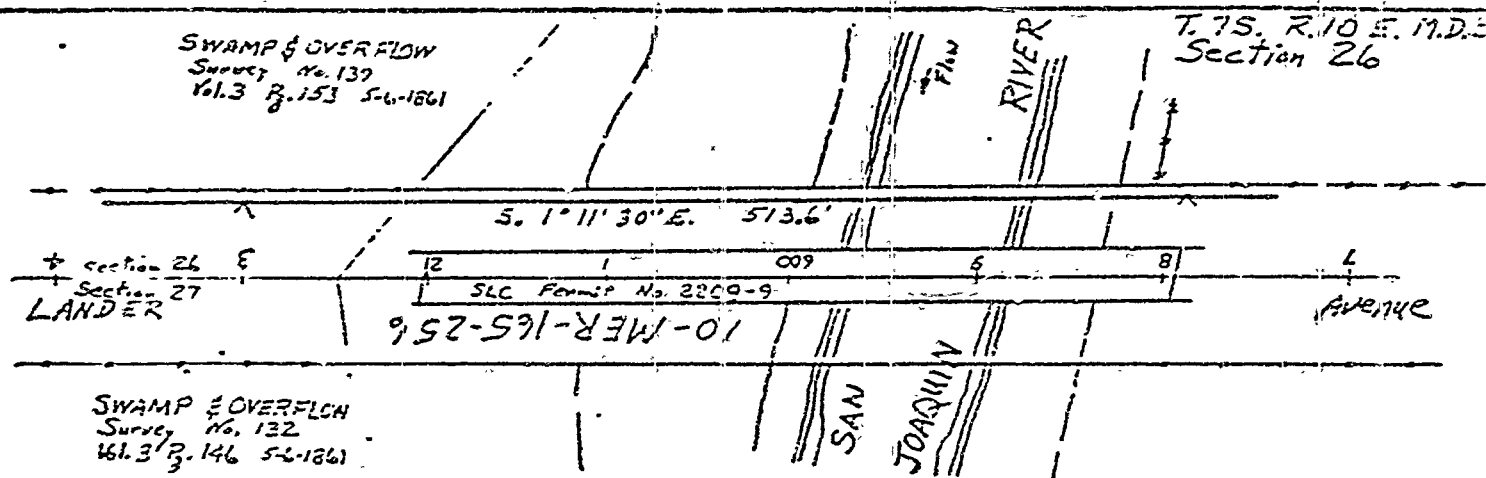

### PLAN

3 #4 6/1 ACSR 12 KV conductors  
for transmission of electric energy

Note: Flood Plain  
extends beyond  
limits of  
this drawing.

Crossing not within  
Corporate limits  
of any municipality

No pierhead or  
bulkhead lines  
established

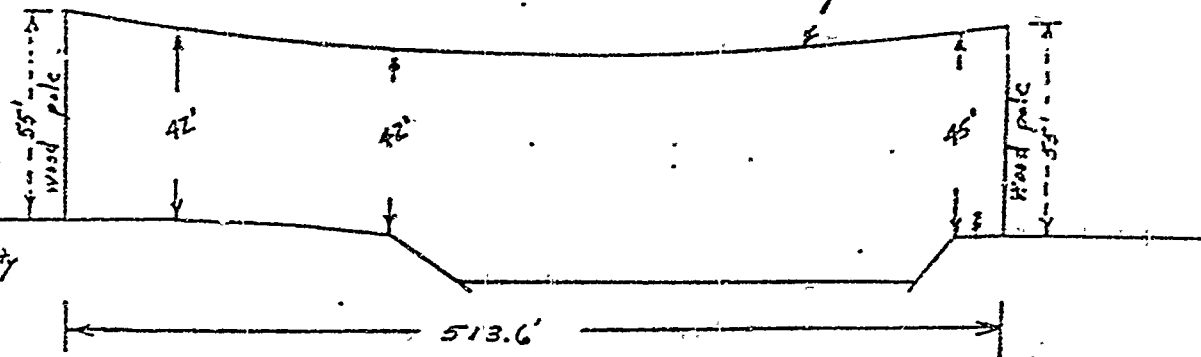

### PROFILE

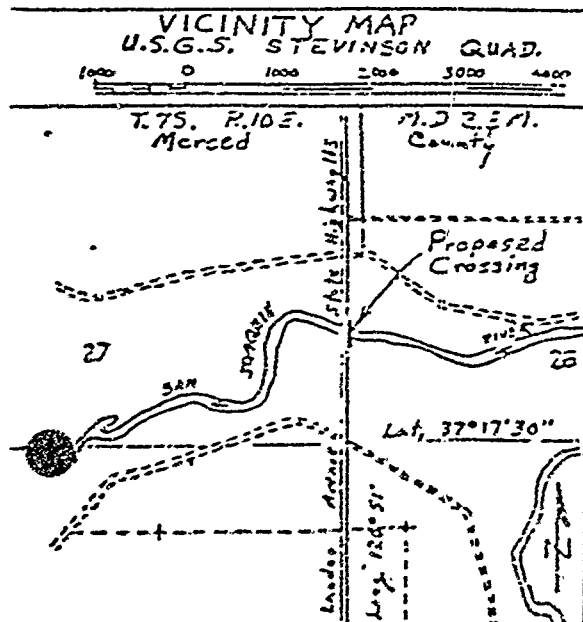

PROPOSED  
OVERHEAD WIRE CROSSING  
OVER SAN JOAQUIN RIVER  
SOUTH OF STEVINSON  
MERCED COUNTY  
CALIFORNIA

Application By  
PACIFIC GAS AND ELECTRIC CO.

Vertical Scale 1" = 40'

Horizontal Scale 1" = 100'

CALENDAR PAGE	034
MINUTE PAGE	481

L-1-10-26 S

