

MINUTE ITEM

This Calendar Item No. C5  
was approved by the  
No. 5 of the  
Commission by a vote of 2  
to 0 at its 3/28/79  
meeting.

CALENDAR ITEM

C5.

GENERAL LEASE  
RIGHT-OF-WAY USE

3/79  
W 22047  
Reese  
PRC 5638

APPLICANT: The Pacific Telephone and  
Telegraph Company  
1426 Howe Avenue, Suite 50  
Sacramento, California 95825

AREA, TYPE LAND AND LOCATION:  
A 0.11 acre strip of tide and submerged  
land in the bed of Cutoff Slough at Joyce  
Island Bridge near Suisun City, Solano  
County.

LAND USE: Replacement and maintenance of a defective  
telephone cable.

TERMS OF PROPOSED LEASE:  
Initial period: Continuous use plus 1 year  
from March 1, 1979.

CONSIDERATION: Exempt pursuant to Section 7901, of the  
Public Utilities Code.

PREREQUISITE TERMS, FEES AND EXPENSES:  
Applicant is permittee of upland.

Filing fee and processing costs have been  
received.

STATUTORY AND OTHER REFERENCES:

- A. P.R.C.: Div. 6, Parts 1 & 2.
- B. Cal. Adm. Code: Title 2, Div. 3.
- C. Public Utilities Code: Section 7901.

OTHER PERTINENT INFORMATION:

- 1. The annual rental value of the site  
is estimated to be \$100.
- 2. An EIR is not required. This transaction  
is within the purview of 2 Cal. Adm.  
Code 2907, Class 2, which exempts replace-  
ment or reconstruction of existing

A 4  
S 4

CALENDAR PAGE	<u>014</u>
MINUTE PAGE	<u>452</u>

CALENDAR ITEM NO. C5. (CONTD)

structures and facilities where the new structure will be located on the same site as the structure replaced and will have substantially the same purpose and capacity. The existing cable will be removed prior to installation of the replacement cable.

3. This project is situated on State land identified as possessing significant environmental values pursuant to P.R.C. 6370.1, and is classified in a use category, Class B, which authorizes Limited Use.

Staff has coordinated this project with those agencies and organizations who nominated the site as containing significant environmental values. They have found this project to be compatible with their nomination.

APPROVALS OBTAINED:

Department of Fish and Game.

FURTHER APPROVALS REQUIRED:

San Francisco Bay Conservation and Development Commission, Water Quality Control Board.

EXHIBITS:           A. Land Description.           B. Location Map.

IT IS RECOMMENDED THAT THE COMMISSION:

1. DETERMINE THAT AN EIR HAS NOT BEEN PREPARED FOR THIS ACTIVITY AS SUCH REPORT IS NOT REQUIRED UNDER THE PROVISIONS OF P.R.C. 21085, 14 CAL. ADM. CODE 15100 ET SEQ, AND 2 CAL. ADM. CODE 2907.
2. FIND THAT GRANTING OF THE LEASE WILL HAVE NO SIGNIFICANT EFFECT UPON ENVIRONMENTAL CHARACTERISTICS IDENTIFIED PURSUANT TO SECTION 6370.1, OF THE P.R.C.
3. ~~AUTHORIZE~~ ISSUANCE TO THE PACIFIC TELEPHONE AND TELEGRAPH COMPANY OF A GENERAL LEASE - RIGHT-OF-WAY USE FROM MARCH 1, 1979; WHICH IS EXEMPT FROM CONSIDERATION PURSUANT TO SECTION 7901 OF THE PUBLIC UTILITIES CODE; FOR REPLACEMENT AND MAINTENANCE OF A DEFECTIVE TELEPHONE CABLE ON THE LAND DESCRIBED ON EXHIBIT "A" ATTACHED AND BY REFERENCE MADE A PART HEREOF.

CALENDAR PAGE	0151
MINUTE PAGE	453

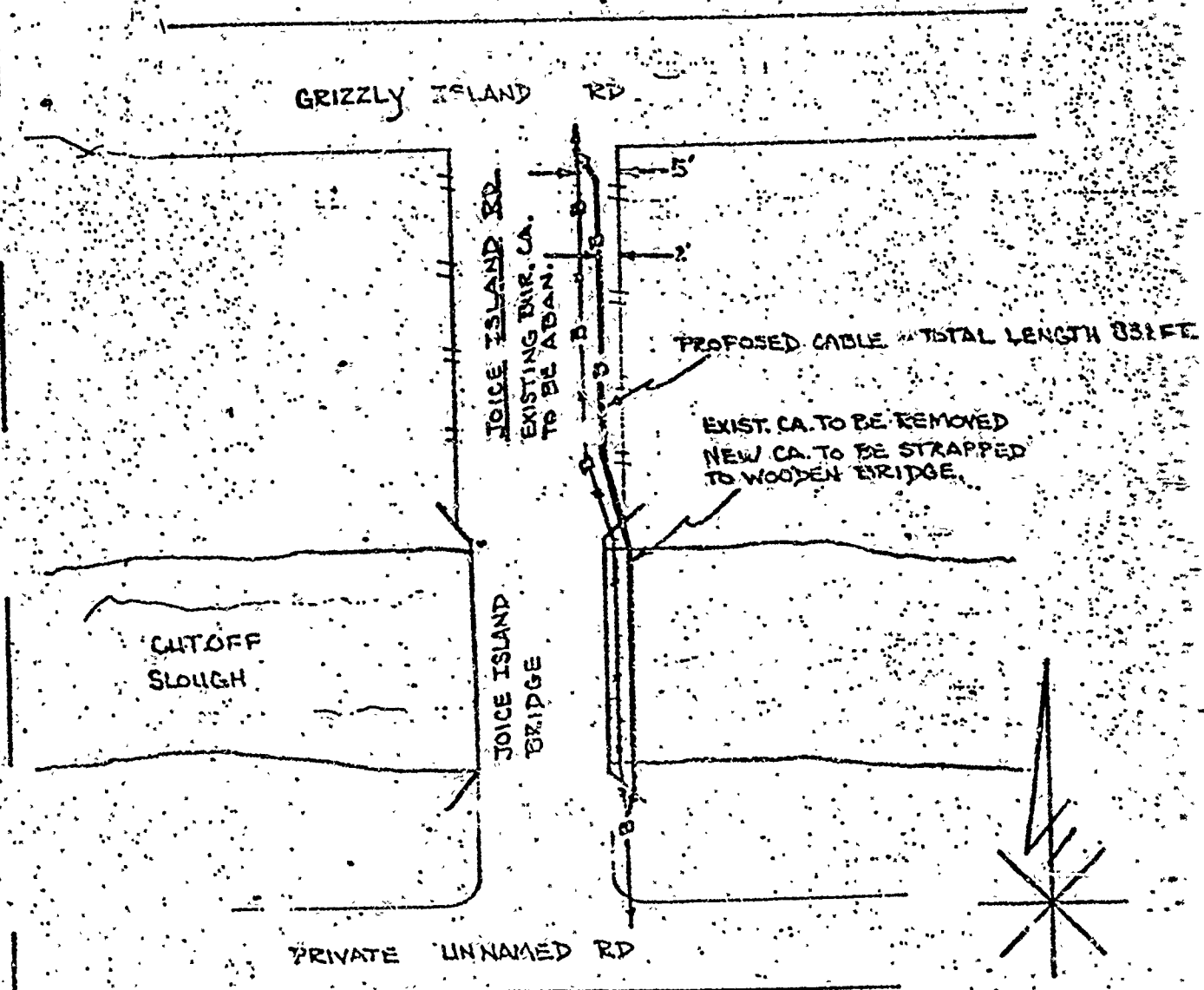

**EXHIBIT A**

CONSTR. ARC	DATE COMP.
GEO/CO. TC 69	
ENGR. W.E. McCracken TEL 422-0089	
ENGR. ARC. QQ BD 34	
TYPE OF CONST BURIED TC 8007S	
RD/EST NO. TC 8007S	CALENDAR PAGE 016
DWG 1 OF 1	MINUTE PAGE 454

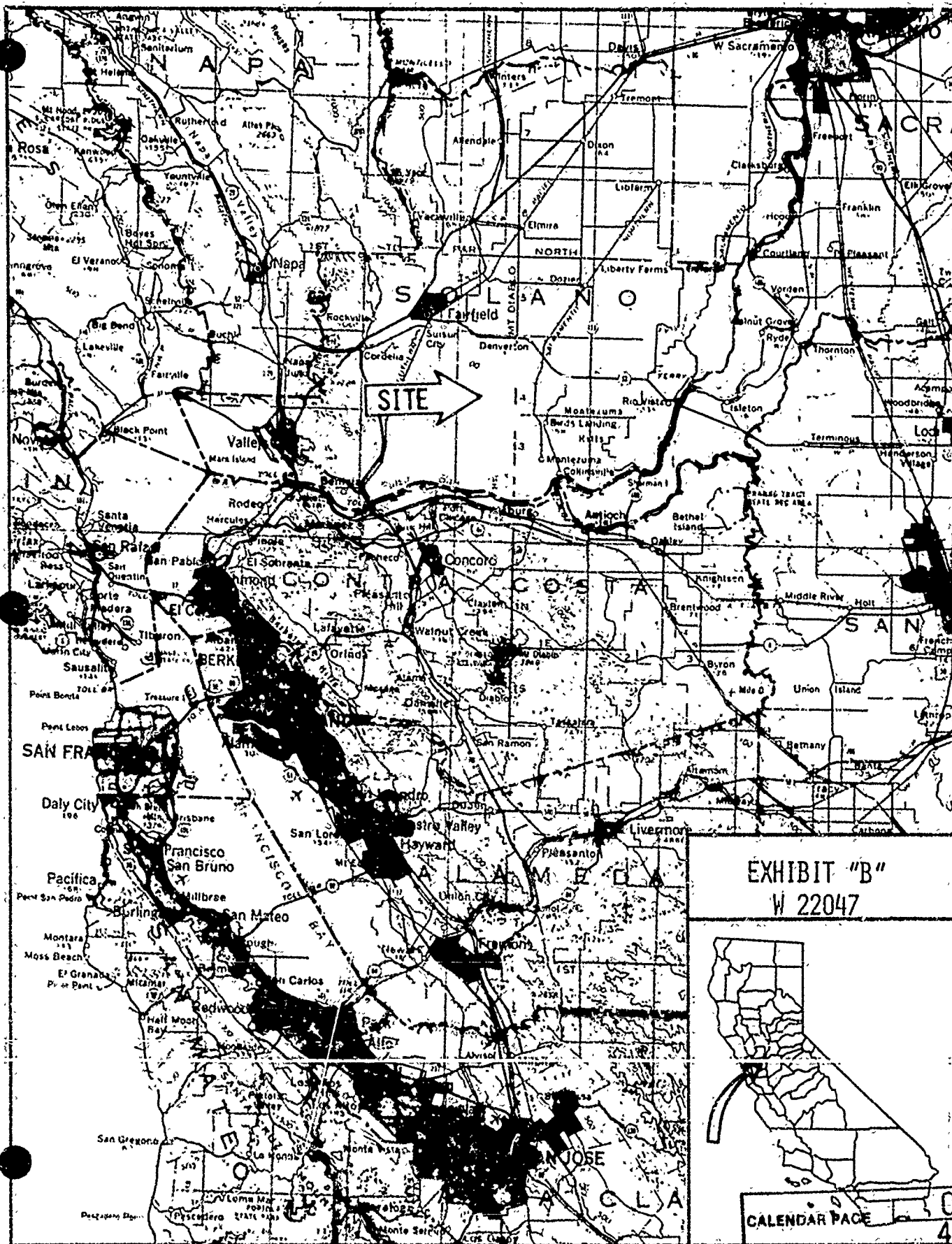

EXHIBIT "B"  
W 22047



CALENDAR PAGE 017  
MINUTE PAGE 455