

MINUTE ITEM

This Calendar Item No. C13  
was adopted as Minute Item  
No. 13 of the State Lands  
Commission by a vote of 3  
to 0 at its 5-31-78  
meeting.

CALENDAR ITEM

C13.

GENERAL PERMIT  
PROTECTIVE STRUCTURE

5/78  
W 21688  
Scott  
P.R.C. 5493

APPLICANT: Hilary E. Abramson  
P. O. Box 160042  
Sacramento, California 95816

AREA, TYPE LAND AND LOCATION:  
A 0.127 acre parcel of tide and submerged  
land in the bed of the Sacramento River,  
north of the Interstate Highway 5 crossing  
in Sacramento County

LAND USE: Construction and maintenance of rock riprap  
bank protection.

TERMS OF PROPOSED PERMIT:  
Initial period: 25 years from April 1,  
1978.

CONSIDERATION: No monetary consideration required; public  
benefit will accrue, with the State reserving  
the right at any time to set a monetary  
rental if the Commission finds such action  
to be in the State's best interest.

PREREQUISITE TERMS, FEES AND EXPENSES:  
Applicant is owner of upland.  
Filing fee has been received.

STATUTORY AND OTHER REFERENCES:  
A. Public Resources Code: Div. 6, Parts 1 & 2.  
B. Administrative Code: Title 2, Div. 3,  
Arts. 1, 2, 10 & 11.  
C. Administrative Code: Title 14, Sec. 15104.

OTHER PERTINENT INFORMATION:  
1. The annual rental value of the site  
is estimated to be \$150.  
2. Staff feels that the construction of  
bank protection at this location will

A 5

S 3

CALENDAR ITEM NO. C13. (CONTD)

be of mutual benefit to both the public and the applicant. The public levee will have additional protection from wave action at no cost to the public, also less eroded material will be deposited in ship channels which are maintained at public expense. The applicant will benefit from the protection of the existing home site.

3. Staff has recommended waiving the normal processing costs in this case because the transaction required minimum staff time and the protective structure was for an individual home site.
4. This project is exempt from CEQA because it is a minor alteration to the land and will not require the removal of any mature or scenic trees.

Authority: 14 Cal. Adm. Code 15104  
Class 4 Minor Alterations to Land.

5. This project is situated on State land identified as possessing significant environmental values pursuant to Public Resources Code 6370.1, and is classified in a use category, Class B which authorizes Limited Use.

Staff has coordinated this project with those agencies and organizations who nominated the site as containing significant environmental values. They have found this project to be compatible with their nomination.

EXHIBITS:           A. Land Description.       B. Location Map.

IT IS RECOMMENDED THAT THE COMMISSION:

1. DETERMINE THAT AN EIR HAS NOT BEEN PREPARED FOR THIS ACTIVITY AS SUCH REPORT IS NOT REQUIRED UNDER THE PROVISIONS OF PRC 21085, 14 CAL. ADM. CODE 15100 ET SEQ., AND 2 CAL. ADM. CODE 2907.
2. FIND THAT GRANTING OF THE PERMIT WILL HAVE NO SIGNIFICANT EFFECT UPON ENVIRONMENTAL CHARACTERISTICS IDENTIFIED PURSUANT TO SECTION 6370.1, OF THE PUBLIC RESOURCES CODE.

CALENDAR ITEM NO. 013 (CONTD)

3. AUTHORIZE ISSUANCE TO HILARY E. ABRAMSON OF A 25-YEAR GENERAL PERMIT - PROTECTIVE STRUCTURE FROM APRIL 1, 1978 AND WAIVER OF PROCESSING FEES; IN CONSIDERATION OF THE PUBLIC BENEFIT, WITH THE STATE RESERVING THE RIGHT AT ANY TIME TO SET A MONETARY RENTAL IF THE COMMISSION FINDS SUCH ACTION TO BE IN THE STATE'S BEST INTEREST; FOR THE CONSTRUCTION AND MAINTENANCE OF ROCK RIFRAP BANK PROTECTION ON THE LAND DESCRIBED ON EXHIBIT "A" ATTACHED AND BY REFERENCE MADE A PART HEREOF.

Attachment: Exhibit "A"

EXHIBIT "A"

W 21688

A parcel of tide and submerged land in the Sacramento River, Sacramento County, California, within Section 23, T.10N., R.3E., M.D.M., described as follows:

All that land immediately beneath the rip rap bank protection adjacent to that certain Lot 139 as shown on the "Map of Natomas Elkhorn Subdivision", filed in the office of the County Recorder of Sacramento County on February 26, 1918, in Book 15 of Maps, Map No. 42.

EXCEPTING THEREFROM any portion lying landward of the ordinary high water mark of the left bank of the Sacramento River.

END OF DESCRIPTION

Prepared John K. Gering Checked Frank T. Cargy  
Reviewed Walter H. Gering Date 3/24/78  
WLB

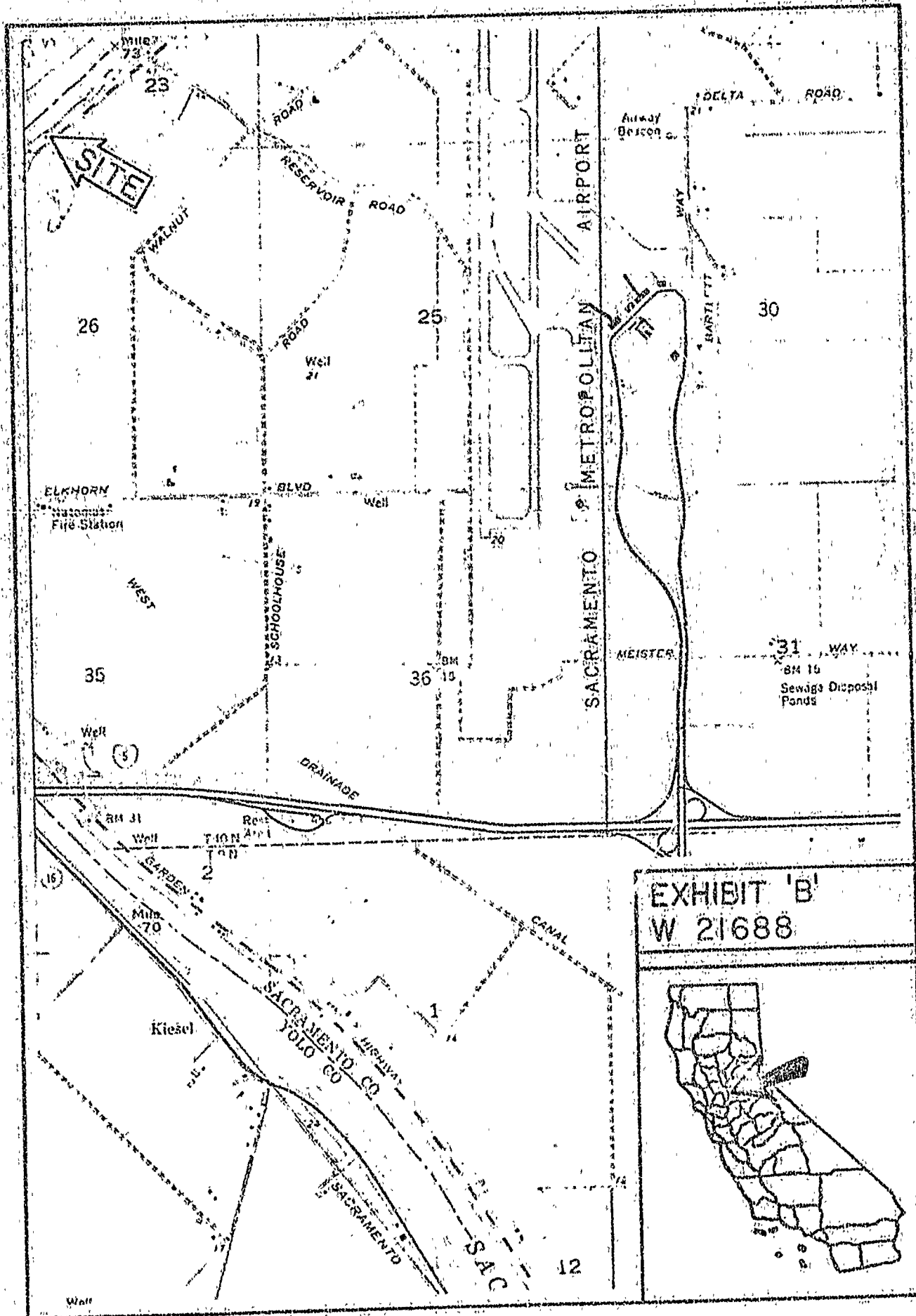

EXHIBIT 'B'  
W 21688

