

MINUTE ITEM

11. APPLICATION FOR DREDGING PERMIT, NAPA RIVER, NAPA COUNTY; LESLIE SALT COMPANY - W.O. 5090, P.R.C. 3140.1.

After consideration of Calendar Item 8 attached, and upon motion duly made and carried, the following resolution was adopted:

THE EXECUTIVE OFFICER IS AUTHORIZED TO ISSUE TO LESLIE SALT COMPANY A PERMIT TO DREDGE APPROXIMATELY 7,000 CUBIC YARDS OF MATERIAL, AT A ROYALTY OF \$0.05 PER CUBIC YARD FOR ALL MATERIAL REMOVED, FROM A PORTION OF THE BED OF THE NAPA RIVER, AND TO DEPOSIT THE MATERIAL ON ADJACENT PROPERTY OWNED BY THE APPLICANT. THE PORTION OF THE NAPA RIVER TO BE DREDGED IS WHICHER SEE FOLLOWING-DESCRIBED AREA:

A PARCEL OF LAND IN THE BED OF THE NAPA RIVER SITUATE IN THE COUNTY OF NAPA, STATE OF CALIFORNIA, MORE PARTICULARLY DESCRIBED AS FOLLOWS:

BEGINNING AT A POINT ON THE ORDINARY HIGH WATER MARK OF THE EAST BANK OF THE AFOREMENTIONED NAPA RIVER WHICH BEARS S. 41° 05' 10" W. 1,902.30 FEET FROM A 1½-INCH IRON PIPE DESIGNATED "AP" USED AND SHOWN ON SHEET 3 OF 13 OF A "SURVEY OF THE ORDINARY HIGH WATER MARK ALONG THE NAPA RIVER" FILED UNDER SERIAL NUMBER S1109, RECORDS OF NAPA COUNTY; SAID IRON PIPE HAVING ZONE 2 CALIFORNIA COORDINATES OF X = 1,912,251.18 Y = 1,96,471.81; THENCE FROM SAID POINT OF BEGINNING ALONG THE ORDINARY HIGH WATER MARK S. 34° 37' 58" W. 23 FEET MORE OR LESS TO THE TRUE POINT OF BEGINNING OF THIS DESCRIPTION; THENCE CONTINUING ALONG LAST SAID COURSE S. 34° 37' 58" W. 170.9 FEET; THENCE LEAVING THE ORDINARY HIGH WATER MARK AND RUNNING N. 79° 53' 48" W. 178.0 FEET; THENCE S. 81° 56' 12" W. 189.0 FEET; THENCE N. 45° 11' 12" E. 262.0 FEET; THENCE S. 79° 53' 48" E. 278.0 FEET TO THE TRUE POINT OF BEGINNING; SAID PARCEL CONTAINING 1.15 ACRES MORE OR LESS.

THE BEARINGS AND DISTANCES USED IN THE ABOVE DESCRIPTION ARE BASED ON THE CALIFORNIA COORDINATE SYSTEM ZONE 2.

Attachment  
Calendar Item 8 (2 pages)

CALENDAR ITEM

8.

APPLICATION FOR DREDGING PERMIT, NAPA RIVER, NAPA COUNTY; LESLIE SALT COMPANY - W.O. 5090.

An application has been received from the Leslie Salt Company for a permit to dredge a two-year accumulation (approximately 7,000 cubic yards) of silt from the bed of the Napa River, Napa County, approximately 0.2 mile below the Brazos Bridge of the Southern Pacific Railroad. In this vicinity the bed of the Napa River between the lines of high tide is sovereign land of the State of California.

The dredging in the river bed will be for the purpose of removing the deposit of silt from the existing barge channel that connects to the Napa River. The silt removed in this operation will be placed along and behind the river levees on property belonging to the applicant.

Section 6303 of the Public Resources Code provides in part: "When a...permittee has...a permit from the Federal Government or any authorized public agency to dredge...for the improvement of navigation...the Commission may, when in the best interests of the State, allow such...permittee to have sand, gravel, or other spoils dredged from the sovereign lands of the State located within the area specified in such...permit upon such consideration as will be in the best interests of the State...."

The U. S. Corps of Engineers has issued a Department of the Army permit authorizing the conduct of dredging operations at the location described in the application. The Division of Beaches and Parks has reported that the proposed operations will not affect any project of that Division, nor will any other recreational land littoral to the permit area be affected. The Department of Fish and Game has stated that the project, as proposed, would not be detrimental to fish and wild-life resources.

The \$5 filing fee has been paid by the applicant.

IT IS RECOMMENDED THAT THE COMMISSION AUTHORIZE THE EXECUTIVE OFFICER TO ISSUE TO LESLIE SALT COMPANY A PERMIT TO DREDGE APPROXIMATELY 7,000 CUBIC YARDS OF MATERIAL, AT A ROYALTY OF \$0.05 PER CUBIC YARD FOR ALL MATERIAL REMOVED, FROM A PORTION OF THE BED OF THE NAPA RIVER, AND TO DEPOSIT THE MATERIAL ON ADJACENT PROPERTY OWNED BY THE APPLICANT. THE PORTION OF THE NAPA RIVER TO BE DREDGED IS WITHIN THE FOLLOWING-DESCRIBED AREA:

A PARCEL OF LAND IN THE BED OF THE NAPA RIVER SITUATE IN THE COUNTY OF NAPA, STATE OF CALIFORNIA, MORE PARTICULARLY DESCRIBED AS FOLLOWS:

BEGINNING AT A POINT ON THE ORDINARY HIGH WATER MARK OF THE EAST BANK OF THE AFOREMENTIONED NAPA RIVER WHICH BEARS S. 41° 05' 10" W. 1,902.30 FEET FROM A 1½-INCH IRON PIPE DESIGNATED "AP" USED AND SHOWN ON SHEET 3 OF 13 OF A "SURVEY OF THE ORDINARY HIGH WATER MARK ALONG THE NAPA RIVER" FILED UNDER SERIAL NUMBER S1109, RECORDS OF NAPA COUNTY; SAID IRON PIPE HAVING ZONE 2 CALIFORNIA COORDINATES OF

CALENDAR ITEM 8. (CONTD.)

X = 1,912,251.18 Y = 196,471.81; THENCE FROM SAID POINT OF BEGINNING ALONG THE ORDINARY HIGH WATER MARK S. 34° 37' 58" W. 23 FEET MORE OR LESS TO THE TRUE POINT OF BEGINNING OF THIS DESCRIPTION; THENCE CONTINUING ALONG LAST SAID COURSE S. 34° 37' 58" W. 170.9 FEET; THENCE LEAVING THE ORDINARY HIGH WATER MARK AND RUNNING N. 79° 53' 48" W. 178.0 FEET; THENCE S. 81° 56' 12" W. 189.0 FEET; THENCE N. 45° 11' 12" E. 262.0 FEET; THENCE S. 79° 53' 48" E. 278.0 FEET TO THE TRUE POINT OF BEGINNING; SAID PARCEL CONTAINING 1.15 ACRES MORE OR LESS.

THE BEARINGS AND DISTANCES USED IN THE ABOVE DESCRIPTION ARE BASED ON THE CALIFORNIA COORDINATE SYSTEM ZONE 2.

EXHIBIT "A"  
W.O. 5090

STATE LANDS COMMISSION

Application for Dredging Permit  
Leslie Salt Co.  
Napa River, Napa County

May 1964

CPP

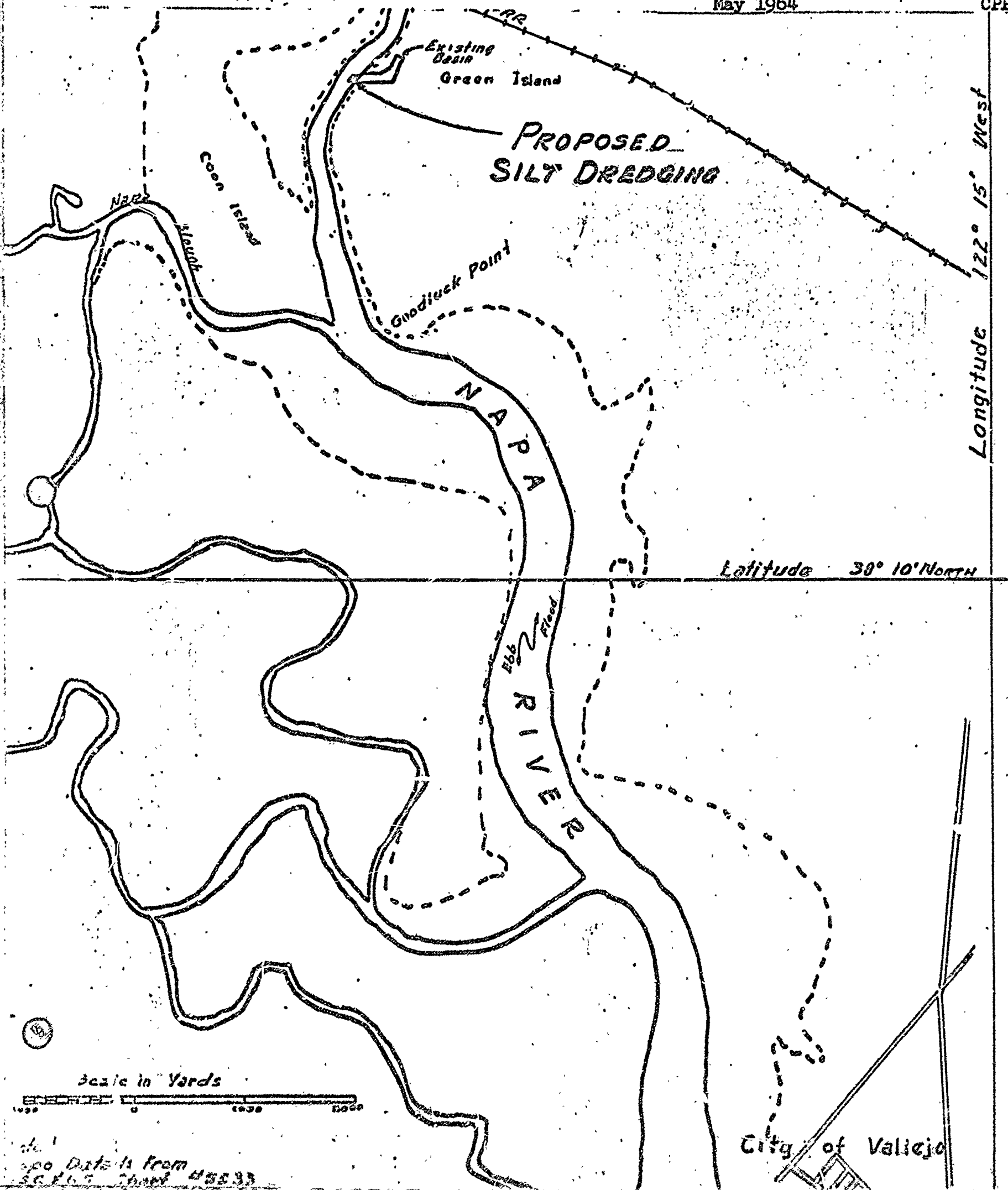

See Details from  
S.C.P. 7 Chap 45233

STATE LANDS COMMISSION

Application for Dredging Permit  
Leslie Salt Co.  
Napa River, Napa County

May 1964

CPP

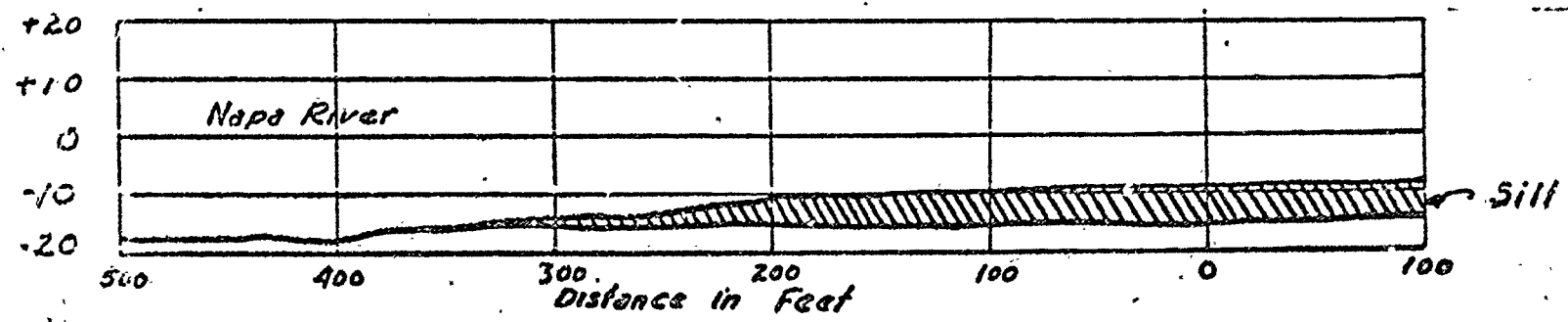

PROFILE of PROPOSED DREDGING

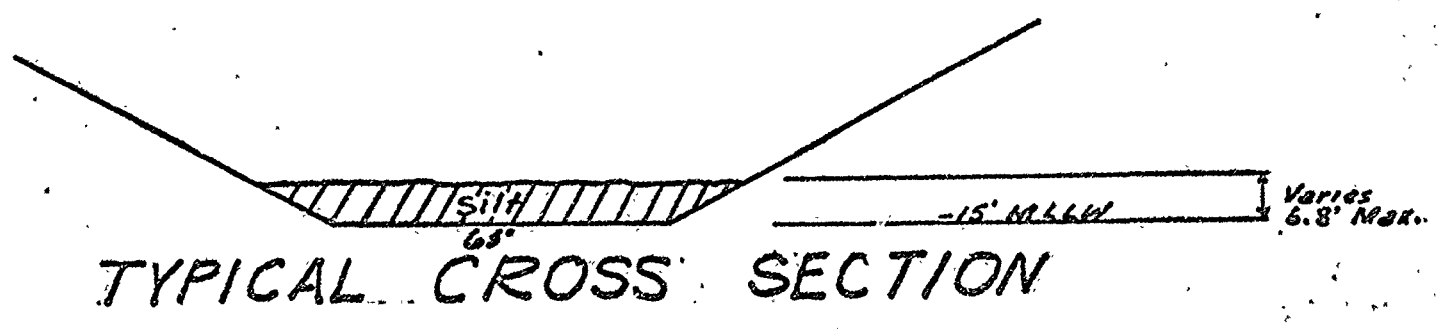

TYPICAL CROSS SECTION

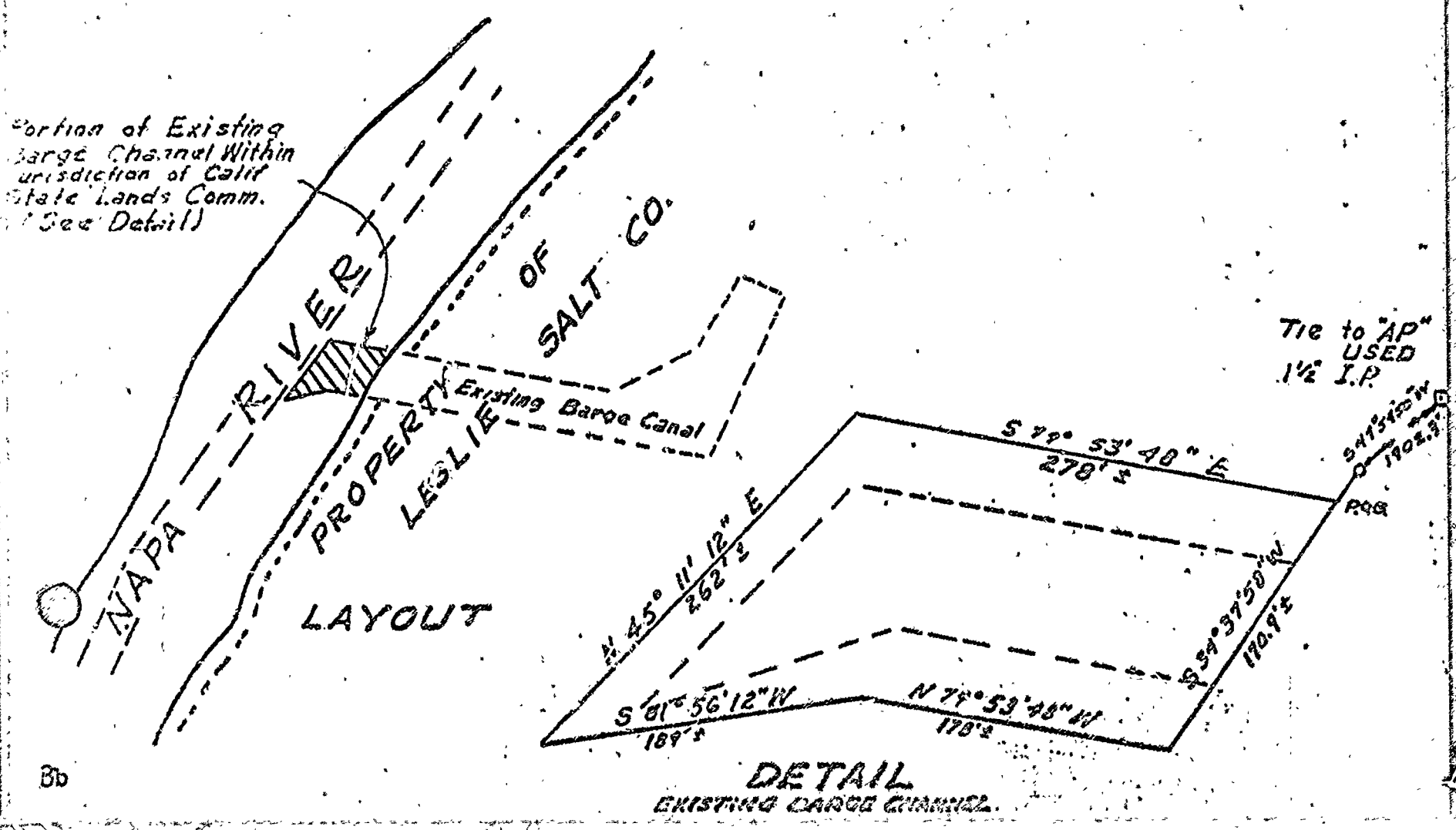

LAYOUT

DETAIL  
EXISTING BARGE CHANNEL