

**STAFF REPORT
C89**

A 35
S 17

08/23/18
PRC 1449.1
S. Evans

REVISION OF RENT

LESSEE:

Phillips 66 Company

AREA, LAND TYPE, AND LOCATION:

4.5 acres, more or less, of sovereign land in Pacific Ocean, adjacent to Oceano Dunes State Vehicular Recreation Area, San Luis Obispo County.

AUTHORIZED USE:

Continued use and maintenance of a 18-inch-diameter wastewater outfall pipeline and retention of an existing abandoned 14-inch-diameter wastewater outfall pipeline.

LEASE TERM:

25 years, beginning October 25, 2003.

CONSIDERATION:

This lease provides that the Commission may modify the rent periodically during the lease term. Pursuant to this provision, staff reviewed the rent under this lease and recommends that rent be revised from \$6,728 per year to \$6,769 per year, effective October 25, 2018.

OTHER PERTINENT INFORMATION:

1. On September 1, 2011, the Commission authorized a General Lease – Right-of-Way Use to Phillips 66 Company for a term of 25 years beginning October 25, 2003 ([Item C45, September 1, 2011](#)). The lease will expire on October 24, 2028. The Commission previously approved a revision of rent from \$5,275 per year to \$6,728 per year ([Item C36, October 13, 2016](#)).
2. The pipeline conveys wastewater from the Santa Maria Refinery located approximately 2 miles inland for discharge into the Pacific Ocean. The upland between the Pacific Ocean and the refinery is the Oceano Dunes State Vehicular Recreation Area owned by the California Department of Parks and Recreation. The lessee has the right to use the upland.

STAFF REPORT NO. **C89** (CONT'D)

3. The lease includes a condition requiring annual external inspections of the outfall to insure the structural integrity of the outfall, diffusers, and anchoring devices. The most recent inspection was performed on October 26, 2017. Staff reviewed the results and found the outfall to be satisfactory.
4. The discharge from the 18-inch-diameter wastewater outfall pipeline is subject to a National Pollutant Discharge Elimination System (NPDES) permit issued by the Central Coast Regional Water Quality Control Board. The permit expires on February 1, 2019.
5. This action is consistent with Strategy 2.2 of the Commission's Strategic Plan to ensure timely receipt of revenues and royalties from the use and development of State lands and minerals.
6. Approving the revision of rent is not a project as defined by the California Environmental Quality Act because it is an administrative action that will not result in direct or indirect physical changes in the environment.

Authority: Public Resources Code section 21065 and California Code of Regulations, title 14, section 15378, subdivision (b)(5).

EXHIBIT:

- A. Site and Location Map

RECOMMENDED ACTION:

It is recommended that the Commission:

AUTHORIZATION:

Approve the revision of rent for Lease No. PRC 1449.1 from \$6,728 per year to \$6,769 per year, effective October 25, 2018.

NO SCALE

SITE

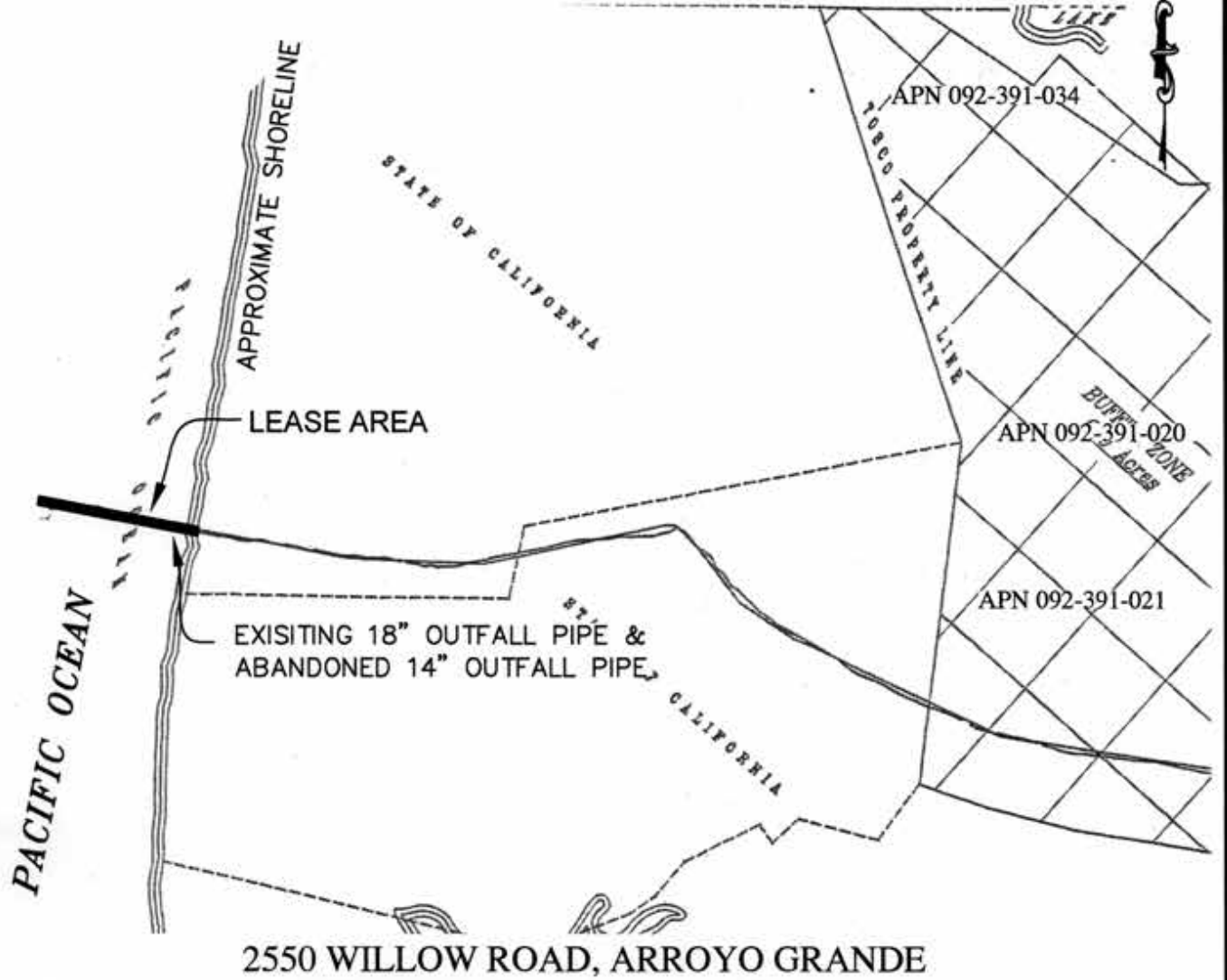

NO SCALE

LOCATION



Exhibit A

PRC 1449.1
 PHILLIPS 66 COMPANY
 APN 092-391-034, 092-391-020,
 092-391-021
 GENERAL LEASE -
 RIGHT - OF - WAY USE
 SAN LUIS OBISPO COUNTY



This Exhibit is solely for purposes of generally defining the lease premises, is based on unverified information provided by the Lessee or other parties and is not intended to be, nor shall it be construed as, a waiver or limitation of any State interest in the subject or any other property.